

A PARCEL OF LAND
 LOCATED IN
 THE NW¹/₄-NE¹/₄ (FRACTIONAL)
 SECTION 4, T14N, R6E,
 TOWN OF DELL PRAIRIE,
 ADAMS COUNTY, WISCONSIN

As Given By
 Mid-State Associates
 Baraboo, Wisconsin
 May, 1970

A parcel of land located in the NW¹/₄-NE¹/₄ (fractional), Section 4, T14N, R6E, Town of Dell Prairie, Adams County, Wisconsin, which is bounded by a line described as follows:

Commencing at the North one-quarter corner of said Section 4; thence East 983.65 feet along the north line of said Section 4 to the point of beginning;

thence continuing East 330.00 feet along the north line of said Section 4 to the north-east corner of the NW¹/₄-NE¹/₄ (frac.) said Section 4; thence S0°34'W, 1320.00 feet along the east line of the NW¹/₄-NE¹/₄ (fractional), said Section 4; thence West 330.00 feet parallel with the north line of said Section 4; thence N0°34'E, 1320.00 feet parallel with the east line of the NW¹/₄-NE¹/₄ (frac.), said Section 4 to the point of beginning.

Said parcel contains 10.0 acres.

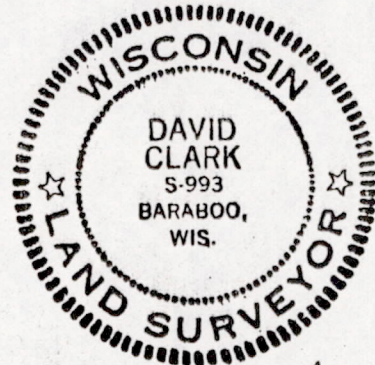

David Clark
 MAY 22, 1970

POS04140611002