

PROJECT NO. 2681
 MARCH 21, 1997
 FILE NO. 26-81
 SCALE 1" = 40'
 SHEET 1 OF 1

**BRENEMAN'S BLUFFVIEW
 LAND SURVEYING SERVICES**

E 12865 C. T. H. W
 BARABOO, WISCONSIN, 53913
 PHONE 608-356-8780

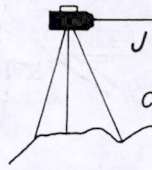

JOHN A. BRENEMAN
 R.L.S. 1274
 CERTIFIED SURVEY MAPS

PLATTING OF ALL KINDS
 RETRACEMENT SURVEYS
 TOPOGRAPHIC SURVEYS

CLIENT & OWNER:
 ROBERT & BERTHA HANLEY
 3773 9TH AVENUE
 WISCONSIN DELLS WI 53965

RETRACEMENT PLAT OF SURVEY

PERFORM A RETRACEMENT PLAT OF SURVEY OF LOT FORTY-NINE (49) ORIGINAL PLAT OF FAWN LAKE BEING FURTHER LOCATED IN GOVERNMENT LOTS FIVE (5) AND SIX (6) SECTION 5, T14N, R6E, TOWNSHIP OF DELL PRAIRIE, ADAMS COUNTY WISCONSIN.

LEGEND:

- = Existing 1 1/4" solid iron rods
- = Existing 3/4" solid iron rods

L-28

L-29

L-30

L-31

G A L E C O U R T

East - West 400.13'

Rec. East - West

S89° 52'E

N89° 57' 19"E

Rec. 66'

300.06'

Rec. 100'

100.07'

234.06'

66.00'

Rec. 100'

Rec. 234'

Ex. 1 1/4"

F A W N

L A K E

solid iron rod
 N.W. cor. Lot
 45 Doe Addit.
 to Fawn Lake

Lot Forty-eight (48)

LOT FORTY-NINE (49)

20,768± Sq. Ft.
 0.477± Acres

Vacant Lot

O. L. 4
 GOV'T. LOT FIVE (5)

GOV'T. LOT SIX (6)

E L E V E N T H (11TH) L A N E

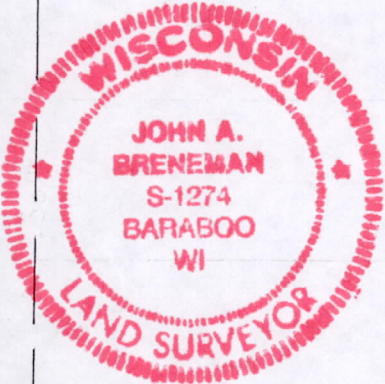

Rec. 100'
 100.04'

N00° 01' 52"E
 Rec. North

Rec. South
 S00° 03'W

Rec. 100'
 100.00'

N89° 57'W

N89° 56' 21"W

Rec. East - West

O. L. 4

SCALE 1" = 40'

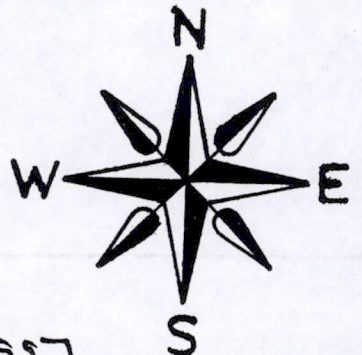

L-34

L-33

MARCH 21ST 1997

CERTIFICATE:

I, JOHN A. BRENEMAN, *John A. Breneman*, Registered Land Surveyor of the State of Wisconsin do hereby certify that I have surveyed and mapped the property shown upon this plat and that the within is a true representation of all the exterior boundaries of the land surveyed to the best of my knowledge and belief and that I have fully complied with the provision of A-E7 Wisconsin Administrative Code.

POS05140600001