

A PARCEL OF LAND  
 LOCATED IN  
 THE WEST -ONE HALF  
 OF THE SW $\frac{1}{4}$ , SECTION 26, T14N, R6E, 1"=200'  
 TOWN OF DELL PRAIRIE  
 ADAMS COUNTY, WISCONSIN  
 \* =  $\frac{3}{4}$ " IRON ROD

A parcel of land located in the West one-half of the SW $\frac{1}{4}$ , Section 26, T14N, R6E, Town of Dell Prairie, Adams County, Wisconsin, which is bounded by a line described as follows:

Commencing at the southwest corner of said Section 26; thence North 1015.0 feet along the west line of said Section 26 to the point of beginning;

thence continuing North 1000.0 feet along said west line; thence N87°03'E, 454.0 feet; thence South 1001.0 feet parallel with the west line of said Section 26; thence S87°10'W, 454.0 feet to the point of beginning.

Said parcel contains 10.42 acres.

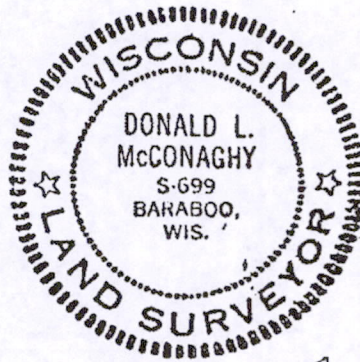

*Donald L. McConaghy*

*Sept. 6, 1909*

*Received full payment on piece of land described above.*

*Charles L. ...  
 Alice Schroeder*

POS26140631006

