

LOT 1

A parcel of land located in the NW/4-SW/4 and NE/4-SW/4 Section 34, T14N, R6E, Town of Dell Prairie, Adams County, Wisconsin, which is bounded by a line described as follows:

Commencing at the west one-quarter corner of said Section 34; thence $S03^{\circ}25'35''W$, 1316.86 feet along the west line of Section 34 to the southwest corner of the NW/4-SW/4 of said Section 34; thence $N89^{\circ}45'16''E$, 1311.87 feet along the south line of the NW/4-SW/4 of said Section 34 to the point of beginning;

thence $N08^{\circ}06'31''W$, 262.00 feet; thence $N62^{\circ}53'29''E$, 342.03 feet to a point on a curve; thence along the arc of a curve concave to the southwest, radius 627.90 feet, whose chord bears $S41^{\circ}13'36''E$, 208.56 feet; thence $S31^{\circ}40'E$, 300.73 feet along the centerline of River Road to a point on the south line of the NE/4-SW/4 of said Section 34; thence $S89^{\circ}45'16''W$, 562.83 feet along the south line of the NE/4-SW/4 of said Section 34 to the point of beginning.

Said parcel contains 3.77 acres, more or less, and is subject to easements of record.

LOT 2

A parcel of land located in the NW/4-SW/4 and NE/4-SW/4 Section 34, T14N, R6E, Town of Dell Prairie, Adams County, Wisconsin, which is bounded by a line described as follows:

Commencing at the west one-quarter corner of said Section 34; thence $S03^{\circ}25'35''W$, 1316.86 feet along the west line of Section 34 to the southwest corner of the NW/4-SW/4 of said Section 34; thence $N89^{\circ}45'16''E$, 1311.87 feet along the south line of the NW/4-SW/4 of said Section 34; thence $N08^{\circ}06'31''W$, 262.00 feet to the point of beginning;

thence continuing $N08^{\circ}06'31''W$, 34.20 feet; thence $N52^{\circ}49'E$, 291.13 feet to a point of curve; thence along the arc of a curve concave to the southwest, radius 627.90 feet whose chord bears $S55^{\circ}05'36''E$, 94.30 feet; thence $S62^{\circ}53'29''W$, 342.03 feet to the point of beginning.

Said parcel contains 0.43 acres, more or less, and is subject to easements of record.

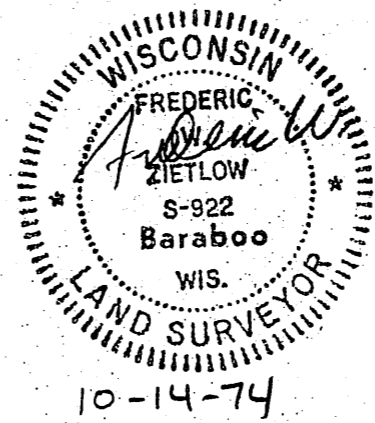
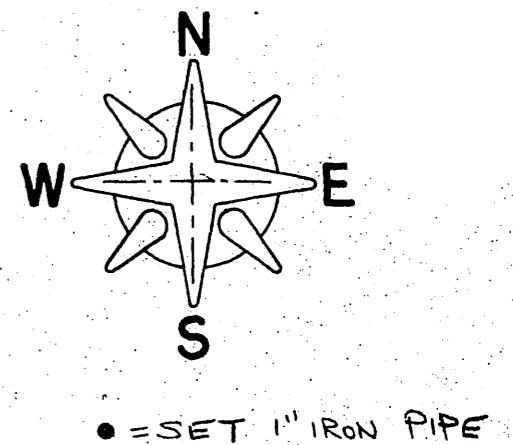

POS341406310102

SURVEY FOR
JIM BREED

LOCATED IN THE NW/4-SW/4 & NE/4-SW/4, SECTION 34, T14N, R6E, TOWN OF DELL PRAIRIE, ADAMS CO., WISC.

SCALE: 1" = 100' DATE: 10/14/74

MID-STATE ASSOCIATES Engineers-Surveyors
1111 EIGHTH ST.
BARABOO, WISCONSIN, 53913
Telephone 608-356-3996

DRAWN BY: CES F.B. SHEET: 1-1
CHECKED BY: F.W.Z. PROJ. 6023 FILE 22-16-41