

BRENEMAN'S BLUFFVIEW LAND SURVEYING SERVICES



E 12865 C. T. H. W
BARABOO, WISCONSIN, 53913
PHONE 608-356-8780

PROJECT NO. 2015D
MAY 10, 2001
FILE NO. 20-15D

CLIENT & OWNER:
SHARON L. STEELE
1803 Duel Drive
Lake Havasu City AZ 86403

C/O Wisconsin Dells Realty Inc
John K. Hanson
319 Broadway
Wisconsin Dells WI 53965

DESCRIPTION OF THE CENTERLINE OF AN EXISTING 16.5 FOOT WIDE (AS MEASURED NORMAL TO) PERMANENT ACCESS EASEMENT BEING LOCATED IN LOT TWO (2) OF ADAMS COUNTY CERTIFIED SURVEY MAP #3141 AND N.E. $\frac{1}{4}$ -S.W. $\frac{1}{4}$ AND N.W. $\frac{1}{4}$ -S.E. $\frac{1}{4}$ ALL IN SECTION 26, T14N, R7E, TOWNSHIP OF NEWHAVEN ADAMS COUNTY WISCONSIN TO BE VACATED AND DISCONTINUED FROM USE FOR RIGHTS OF INGRESS AND EGRESS ACCESS PURPOSES OF ADAMS COUNTY C.S.M. #2102 AND A PARCEL CONTAINING 1.47± ACRES WHICH WAS COMBINED WITH SAID C.S.M. #2102 AND AS ALSO DESCRIBED AS EXCEPTED PARCEL 3 IN VOLUME 1092 OF DEEDS PAGE 56 AT THE ADAMS COUNTY REGISTER OF DEEDS. THE CENTERLINE OF SAID EXISTING 16.5 FOOT WIDE PERMANENT ACCESS EASEMENT BEING DESCRIBED AND DEFINED AS FOLLOWS TO WIT:

Commencing at a found standard Harrison monument at the Southwest corner of said Section 26, T14N, R7E; thence N02° 00' 43"W 2642.00 feet along the West line of S.W. $\frac{1}{4}$ of said Section 26 to a found standard Harrison monument at the West one-quarter corner of said Section 26; thence S78° 35' 20"E 3012.86 feet to a found pipe over an existing 3/4" solid iron rod at the West most corner of the above said excepted parcel #3 in Volume 1092 of Deeds Page 56; said point also being the point of beginning of this existing 16.5 foot wide permanent access easement to be discontinued.

Thence S76° 00' 38"W 199.90 feet along the centerline of said easement to an existing 3/4" solid iron rod; thence S23° 30'W 260.30 feet along the centerline of said easement to an existing 3/4" solid iron rod at the point of termination of the discontinuance of said 16.5 foot wide permanent access easement.

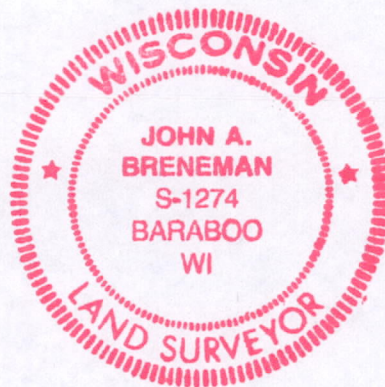

M1526140700001

MAY 10TH 2001
John A. Breneman