

PLAT OF SURVEY

Located in
NE1/4-SW1/4 & SE1/4-SW1/4, Section 8, T14N, R7E,
Town of New Haven, Adams County, Wisconsin

Carlson Surveying, Inc.
1709 Ash St.
Baraboo, WI 53913
Tel/Fax: (608)356-8598

Client/Owner:
Mike Kane
823 Bauer St.
Wisconsin Dells, WI 53965

PARCEL DESCRIPTION:

The NE1/4-SW1/4 and SE1/4-SW1/4, Section 8, T14N, R7E, Town of New Haven, Adams County, Wisconsin.

SURVEYOR'S CERTIFICATE:

I, Steven M. Higley, registered land surveyor, hereby certify that I have surveyed and mapped the above described parcel and have complied with the provisions of A-E 7 of the Wisconsin Administrative Code to the best of my knowledge, information and belief.

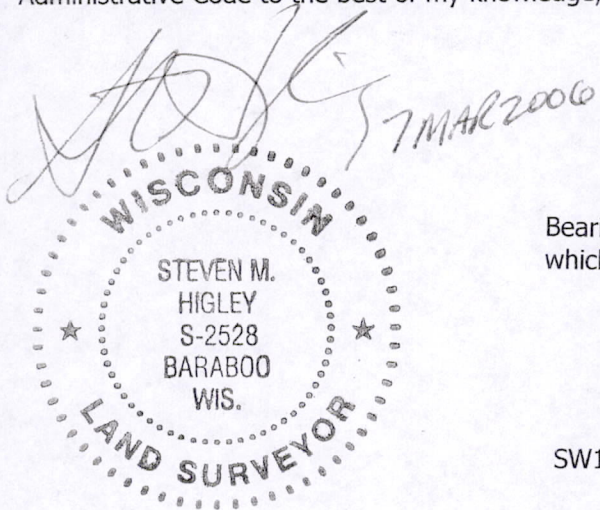

Bearings are referenced to the south line of the SW1/4 of Sec. 8, which is assumed to bear N89°54'40"W.

Legend:

- = Set 3/4"x24" round iron rod weighing 1.5#/lin.ft.
- = Found 3/4" round iron rod.
- ▲ = Found steel fencepost.
- △ = Set steel fencepost.
- ⊙ = Found gov't. monument (Harrison).
- () = Recorded as...

