

PLAT OF SURVEY

Located in
NW¼-NE¼ & NE¼-NE¼, Section 20, T14N, R7E,
Town of New Haven, Adams County, Wisconsin.

Carlson Surveying, Inc.
1709 Ash St.
Baraboo, WI 53913
Tel-Fax: (608)356-8598

Client:
c/o First Weber Rlty.
P.O. Box 539
Lake Delton, WI 53940

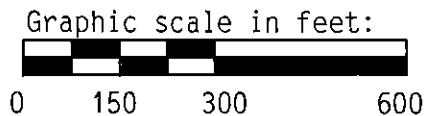

Legend:

- = Set 3/4"x24" round iron rod weighing 1.5#/lin.ft.
- = Found 3/4" round iron rod.
- ⊙ = Found gov't. monument (Harrison).
- () = Recorded as...

Bearings are referenced to the east line of Section 20, which is assumed to bear S00°13'55"E.

CURVE	DELTA	RADIUS	ARCLNGTH	CHORD
⑤ To ⑥	53°54'40"	370.13'	348.25'	N63°22'20"E, 335.54'
④ To ②	21°58'30"	436.13'	167.28'	N47°24'15"E, 166.25'

SURVEYOR'S CERTIFICATE:

I, Steven M. Higley, registered land surveyor, hereby certify that I have surveyed, staked and mapped the above described parcels and have complied with A-E 7 of the Wisconsin Administrative Code to the best of my knowledge, information and belief.

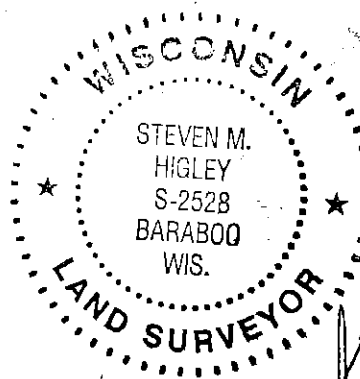

[Signature]
19 DEC 2000

Pos 20140711001

