



TRANSPORTATION • MUNICIPAL • REMEDIATION  
DEVELOPMENT • ENVIRONMENTAL

1230 South Boulevard Baraboo, WI. 53913  
608-356-2771 1-800-362-4505 Fax: 608-356-2770

PROFESSIONAL SERVICES

© MSA PROFESSIONAL SERVICES

PROJECT #	11648
DRAWN BY	MTS
CHECKED BY	KHS
FILE #	38-25K-229
SHEET #	1/1
FIELD BOOK #	1215
PAGES	15

PLAT OF SURVEY

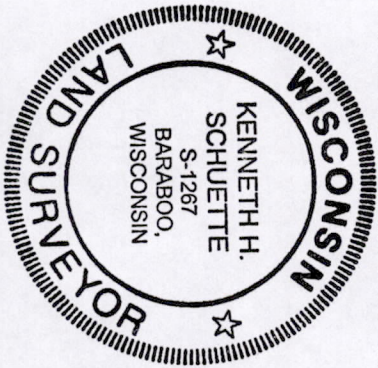

\*SURVEYOR'S SEAL\*



LANDS

R/W  
4TH DRIVE  
R/W

S1/4 COR.  
28-14-7

N1/4 COR.  
28-14-7

N00°15'31"W

N-S1/4 LINE

1321.97'

N00°15'31"W 660.98'

S00°15'31"E  
3305.80'

NO LEGAL ACCESS  
FROM 4TH DRIVE TO  
THIS PARCEL

S89°23'58"E

LOT 1  
CSM #4002



MARILYN JABUSCH  
3781 PARK KNOLL DRIVE  
MADISON, WI. 53718  
(608) 837-3965

CLIENT:

LOCATED IN THE S1/2-NE1/4-SE1/4, SECTION 28, T14N, R7E,

TOWN OF NEW HAVEN, ADAMS COUNTY, WISCONSIN

S1/2-NW1/4-SE1/4

VOL. 2675, PAGE 34  
PARCEL 4

AREA:  
880999.34 SFT  
20.22 AC±

LEGEND

- FD. GOVERNMENT MONUMENT
- FD. 3/4" IRON REBAR
- SET 3/4" (O.D.) BY 18" IRON REBAR-1.50 LBS./FT.

LANDS

SW1/4-SE1/4

LANDS

1333.19'

1/16TH COR.

LANDS

BEARING REF. LINE AS RECORDED

FENCE IS 14' WEST  
FROM COR.

1332.90'

333.65

S00°17'02"E 660.96'

644.46'

NE1/4-SE1/4

LOT 1  
CSM #2865

14'± EAST AND  
10'± NORTH OF  
FENCE CORNER

I, KENNETH H. SCHUETTE, REGISTERED LAND SURVEYOR, HEREBY CERTIFY TO MY CLIENT(S) THAT I HAVE SURVEYED AND MAPPED THE PROPERTY SHOWN UPON THIS PLAT AND THAT THE WITHIN PLAT IS A TRUE AND CORRECT REPRESENTATION OF THE BOUNDARIES OF THE LAND SURVEYED TO THE BEST OF MY KNOWLEDGE AND BELIEF.

I FURTHER CERTIFY THAT I HAVE COMPLIED WITH CHAPTER A-E 7 OF THE ADMINISTRATIVE CODE OF THE STATE OF WISCONSIN FOR MINIMUM STANDARDS FOR PROPERTY SURVEYS TO THE BEST OF MY KNOWLEDGE AND BELIEF.

*Kenneth H. Schuette*  
Kenneth H. Schuette, Registered Land Surveyor #1267

DATE

POS 2814074001