

# BRENEMAN'S BLUFFVIEW LAND SURVEYING SERVICES



E 12865 C. T. H. W  
BARABOO, WISCONSIN, 53913  
PHONE 608-356-8780

SHEET 2 OF 2  
SIDE 2 OF 2

NOVEMBER 14, 1989  
PROJECT NO. 2237

**PRESENT OWNERS**

Roger & Anita M. Lynch  
2627 Lorado  
Rockford IL 61103

**MORTGAGE INSPECTION:**

Breneman's Bluffview Land Surveying Services  
E12865 C.T.H. W  
Baraboo WI 53913-9663

**ADDRESS OF PROPERTY INSPECTED:**

154 Grouse Court  
New Haven Township  
Briggsville WI 53920

**LEGAL DESCRIPTION OF PROPERTY INSPECTED:**

Microfile Volume 386 Page 35 Document number 31164 as recorded at the office of Adams County Register of Deeds.

**CLIENT:**

Peter Schneider  
United National Real Estate  
Rt. #1 Hwy 23  
Briggsville WI 53920

**CERTIFICATE:**

I, John A. Breneman *John A. Breneman*, Registered Land Surveyor of the State of Wisconsin, do hereby certify that I have inspected the above described property according to the official records and that I have mapped the locations of all visible structures, the dimensions of all principal buildings, roadways, apparent easements and visible encroachments, if any.

**WAIVER OF MINIMUM STANDARDS - WISCONSIN ADMINISTRATIVE CODE:**

This mortgage inspection does not fully comply with all the requirements of Section A-E7.01 of the Wisconsin Administrative Code. This agreement is being made between John A. Breneman, R.L.S. #S1274 and Pete Schneider of United National Real Estate to exclude this mortgage survey from A-E7.01 paragraphs 2, 3,5 & 7.

This mortgage inspection is made for the exclusive use of the present owners of this property and also those who purchase, mortgage or guarantee the title thereto within one year from date hereof and as to them we certify the accuracy of said mortgage inspection as shown.

Dated this 16th day of November, 1989.

JOHN A. BRENEMAN  
Wisconsin Registered Land Surveyor  
#S1274

**WAIVER**

Pete Schneider  
United National Real Estate  
Rt. #1 Hwy 23  
Briggsville WI 53920

*John A. Breneman*

*Nov. 16, 1989*

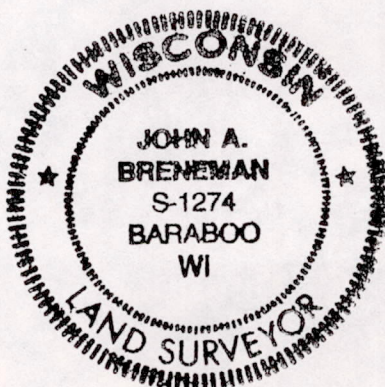

*POS3640721010*