

ADAMS COUNTY  
Survey Monument Record

TYPE OF MONUMENT: 50" HARRISON  
 STATE PLANE COORDINATES: N \_\_\_\_\_  
 E \_\_\_\_\_  
 ELEVATION — M.S.L. DATUM: \_\_\_\_\_  
 THETA ANGLE: \_\_\_\_\_  
 FIELD BOOK: 110 PAGE 12

CORNER NO. 242  
 SECTION 14  
 TOWN 15  
 RANGE 6

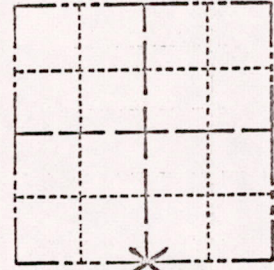

LOCATION  
 (Indicated by 'X')

BASIS FOR MONUMENT LOCATION

(Use reverse side if necessary)

Show info such as: History of corner, with reference to Vol. and pg, dates, surveyor; exact description of monument replaced; if location computed, by taped or EDM traverse; landowner remarks, etc.

Set on the basis of a traverse of the entire section, taking into account other surveys in the area.

SEAL:



*Everything O.K. 9-25-76 RN-SS*

CERTIFIED CORRECT:

*Anthony B. Kiedrowski*  
 Registered Land Surveyor

DATE: 12/27/73

TIE SKETCH

(Show at least four ties)

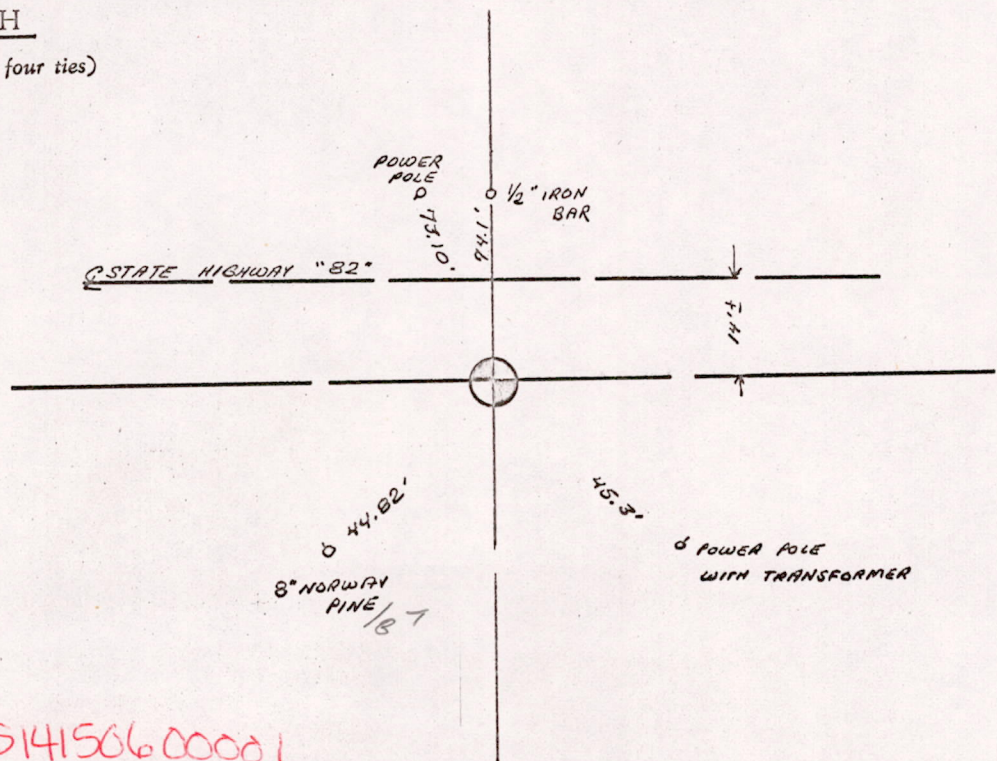

M1514150600001