

# MORTGAGE INSPECTION

THIS DOES NOT CONSTITUTE A BOUNDARY SURVEY

LAND DESCRIPTION

LOT 6 C.S.M. NO. 1153, SECTION 32, T. 15 N., R. 6 E.  
TOWN OF SPRINGVILLE, ADAMS COUNTY, WISCONSIN.

FILE # 796-362

PROPERTY ADDRESS LOT 6 GALE AVE  
WISCONSIN, BELLS, WI

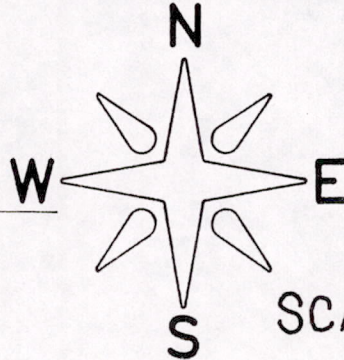

SCALE: 1" = 200'

C.S.M. NO. 757

328.99'±

982.41'±

C.S.M. NO. 840

981.63'±

7  
C.S.M. 1153  
6

NOTE:  
THE PRINCIPAL BUILD.  
IS NOT LOCATED  
WITH IN A REGIONAL  
FLOOD PLAIN

C.S.M. NO. 839

309.39'±

203'±

309.54'±

33.00'±

323.44'±

33.00'±

GALE

AVE.

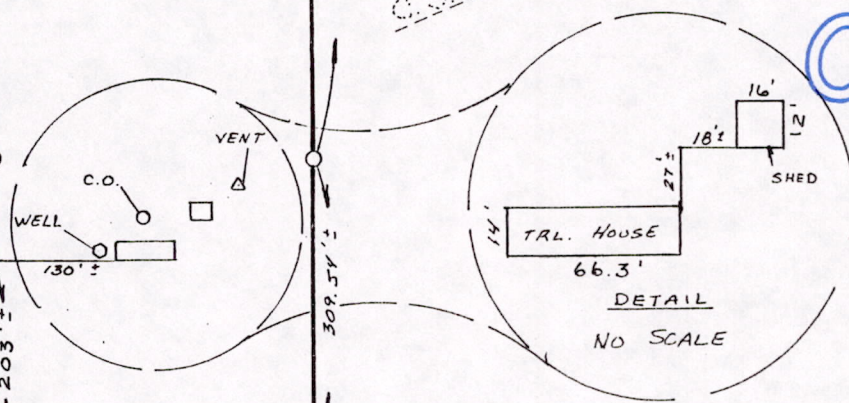

COPY

TITLE CO. GREEN TREE FINANCIAL  
ADAMS-FRIENDSHIP TITLE CO.

BORROWER TROY & MELISSA  
HOLT

LENDER

CERTIFICATION

DATE: 7-31-96

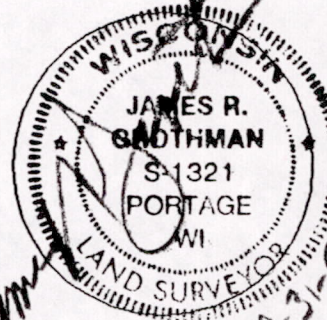

PREPARED BY  
FIRM NAME

GROTHMAN &  
ASSOCIATES, S.C.  
LAND SURVEYORS  
PORTAGE, WI



AES GROUP INC.  
NATIONWIDE SURVEYORS

805 STATE STREET NEWBURGH, INDIANA 47830  
1-800-TO-SURVEY  
1 800 828 5934

POS 32150641002

**DESCRIPTION**

Lot 6, Certified Survey Map, No. 1153 located in the Southwest Quarter of the Southeast Quarter of Section 32, Town 15 North, Range 6 East, Town of Springville, Adams County, Wisconsin.

**SURVEYOR'S CERTIFICATE**

I, **JAMES R. GROTHMAN**, Registered Land Surveyor in the State of Wisconsin, **DO HEREBY CERTIFY** that I have inspected the above described property and that I have mapped the property according to the official records and that I have mapped the locations of all visible structures, the dimensions of all principal buildings, roadways, apparent easements and visible encroachments, if any. This mortgage inspection has been prepared in accordance with the requirements of **GREEN TREE FINANCIAL ADAMS - FRIENDSHIP TITLE COMPANY** and under the agreement between **GROTHMAN & ASSOCIATES, S.C.** and **GREEN TREE FINANCIAL ADAMS - FRIENDSHIP TITLE COMPANY** which excludes this mortgage inspection from all of the requirements of Section AE 7.01 Wisconsin Administrative Code. Therefore all of the requirements of Section AE 7.01 have not been complied with. The mortgage inspection is made for the exclusive use of **GREEN TREE FINANCIAL ADAMS - FRIENDSHIP TITLE COMPANY** and its insurees and for the period of one year from date hereof and as to them I certify the accuracy of said mortgage inspection as shown.

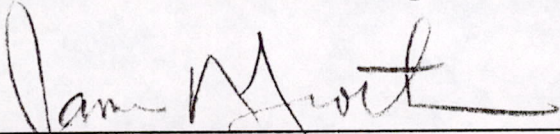

**JAMES R. GROTHMAN**  
Registered Land Surveyor, No. 1321  
Dated: July 29, 1996

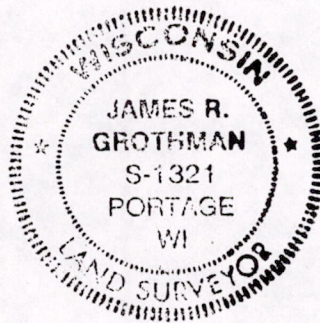

COPY

POS32150641002