

SCALE: 1" = 200'  
 ○ = 3/4" X 24" IRON ROD  
 F.B. NO. 384, P-56  
 PROJ. NO. 4031

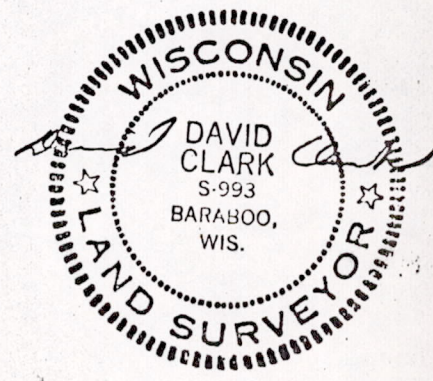

Oct. 5, 1970

A PARCEL OF LAND  
 LOCATED IN  
 THE NW<sup>1</sup>/<sub>4</sub>-NW<sup>1</sup>/<sub>4</sub> SECTION 35, T15N, R6E  
 TOWN OF SPRINGVILLE, ADAMS COUNTY, WISCONSIN

As Given By  
 Mid-State Associates  
 Baraboo, Wisconsin  
 October, 1970

A parcel of land located in the NW<sup>1</sup>/<sub>4</sub>-NW<sup>1</sup>/<sub>4</sub> Section 35, T15N, R6E, Town of Springville, Adams County, Wisconsin, which is bounded by a line described as follows:

Commencing at the northwest corner of said Section 35; thence S88°41'20"E, 812.5 feet along the north line of said Section 35 to the point of beginning;

thence continuing S88°41'20"E, 487.5 feet along the north line of said Section 35; thence S0°15'50"E, 661.50 feet; thence N88°41'20"W, 486.0 feet parallel with the north line of said Section 35; thence N0°07'55"W, 661.50 feet to the point of beginning.

Said parcel contains 7.39 acres.

POS 35150621005