

ADAMS

PLAT OF SURVEY

COUNTY CERTIFIED SURVEY MAP #

A PART OF THE NE 1/4 OF SECTION 36, T15N, R6E, IN THE TOWN OF SPRINGVILLE, ADAMS COUNTY, WISCONSIN.

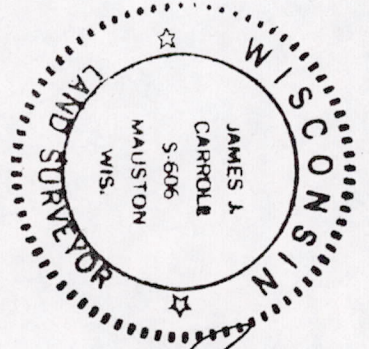

SEE -- PLAT OF SURVEY BY KEN CARLSON DATED SEPT. 28, 1984  
*James J. Carroll Nov. 19, 1990*

PARCEL 1  
± 1,554,750 S.F.  
± 35.69 AC.

- LEGEND**
- Harrison marker found in place
  - 3/4" iron rod found in place
  - PK nail found in place
  - PK nail set
  - 1 1/2" x 2 1/4" (WT 2.27#/L.F.) iron pipe set

NENE  
N.W.NE

BEARINGS ARE REFERENCED TO THE EAST LINE OF THE NE 1/4 OF SECTION 36 ASSIGNED TO BEAR S 00-21-05 W.

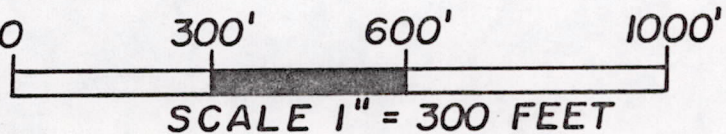
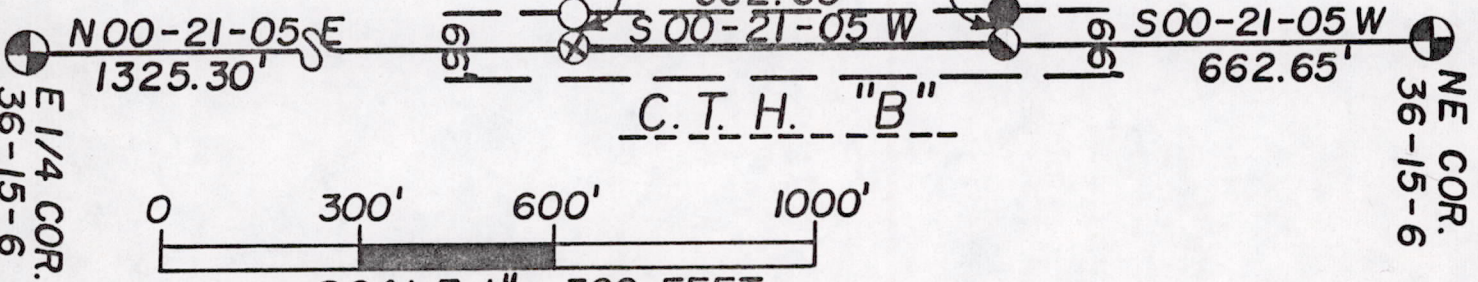
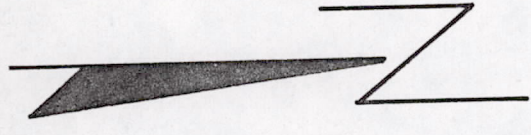

Pos 36150611002

ADAMS

COUNTY CERTIFIED SURVEY MAP # \_\_\_\_\_

A PART OF THE NE $\frac{1}{4}$  OF SECTION 36, T15N, R6E, IN THE TOWN OF SPRINGVILLE, ADAMS COUNTY, WISCONSIN.

SURVEYOR'S CERTIFICATE

I, James J. Carroll, a Registered Land Surveyor S-606, of Mauston, Wisconsin, hereby certify:

That in compliance with the provisions of Chapter 236.34 of the Wisconsin Statutes and the subdivision regulations of the County of Adams, and under the direction of TERRY STEVENS, Representative for the owners of said land, I did survey and map a part of the NE $\frac{1}{4}$  of Section 36, T15N, R6E, in the Town of Springville, Adams County, Wisconsin.

That such map correctly represents the exterior boundaries and the subdivision of the land surveyed to the best of my knowledge and belief.

PARCEL 1 DESCRIPTION

A part of the NE $\frac{1}{4}$  of Section 36, T15N, R6E, in the Town of Springville, Adams County, Wisconsin, to-wit:

Commencing at the NE corner of said Section 36; thence along the east line of the said NE $\frac{1}{4}$  being the centerline of C.T.H. "B" bearing S 00-21-05 W, 662.65 feet, to the point of beginning.

Thence continued along the east line of the said NE $\frac{1}{4}$  being the centerline of C.T.H. "B" bearing S 00-21-05 W, 662.65 feet; thence along a line bearing N 89-37-55 W, 2352.74 feet; thence bearing N 00-11-37 E, 658.49 feet; thence bearing S 89-44-00 E, 2354.56 feet, to the point of beginning, containing 1,554,750 SQ. FT. in area or +35.69 acres.

This described parcel of land is subject to the highway easement for C.T.H. "B" being the east 33 feet thereof.

*James J. Carroll*  
REGISTERED LAND SURVEYOR S-606  
JAMES J. CARROLL NOV. 19, 1990



POS 361506 11002