

P0507150711002

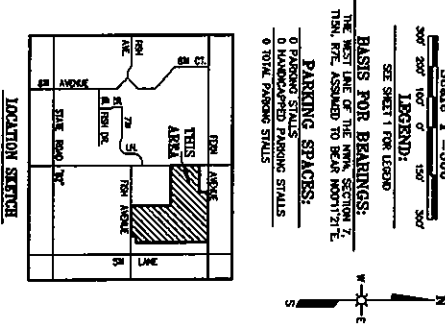

UNDERGROUND UTILITIES
 THIS DRAWING HAS BEEN PREPARED BY PART OF THE BASIS OF THE RECORD DRAWING. THE ENGINEER HAS CONDUCTED VISUAL INSPECTIONS OF THE RECORD DRAWING AND HAS FOUND NO DISCREPANCIES. THE ENGINEER HAS CONDUCTED VISUAL INSPECTIONS OF THE RECORD DRAWING AND HAS FOUND NO DISCREPANCIES. THE ENGINEER HAS CONDUCTED VISUAL INSPECTIONS OF THE RECORD DRAWING AND HAS FOUND NO DISCREPANCIES.

FLOOD NOTES:
 THE FLOOD HAZARD ZONE IS SHOWN ON THE RECORD DRAWING. THE ENGINEER HAS CONDUCTED VISUAL INSPECTIONS OF THE RECORD DRAWING AND HAS FOUND NO DISCREPANCIES. THE ENGINEER HAS CONDUCTED VISUAL INSPECTIONS OF THE RECORD DRAWING AND HAS FOUND NO DISCREPANCIES.

ZONING INFORMATION:
 THE ZONING DISTRICT IS R-1. THE ENGINEER HAS CONDUCTED VISUAL INSPECTIONS OF THE RECORD DRAWING AND HAS FOUND NO DISCREPANCIES. THE ENGINEER HAS CONDUCTED VISUAL INSPECTIONS OF THE RECORD DRAWING AND HAS FOUND NO DISCREPANCIES.

Significant Observations:
 1. FENCE ENDS ONTO SUBJECT PROPERTY BY 150 FEET.
 2. SUBJECT PROPERTY'S FIELD & PLANTED FARM FIELD EXTEND ONTO ADJACENT PROPERTY BY 1543 FEET.

Miscellaneous Notes:
 1. THERE WERE NO DISCREPANCIES OR SIGNIFICANT DISCREPANCIES OR DISCREPANCIES FOUND IN THE FIELD OR RECORD DRAWING. THE ENGINEER HAS CONDUCTED VISUAL INSPECTIONS OF THE RECORD DRAWING AND HAS FOUND NO DISCREPANCIES. THE ENGINEER HAS CONDUCTED VISUAL INSPECTIONS OF THE RECORD DRAWING AND HAS FOUND NO DISCREPANCIES.

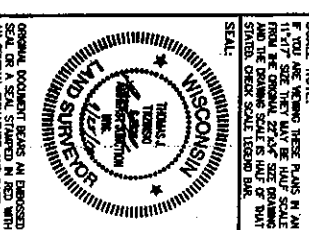

SCALE NOTE:
 THIS DRAWING IS A SCALE SURVEY AND IS NOT TO BE USED FOR ANY OTHER PURPOSE. THE ENGINEER HAS CONDUCTED VISUAL INSPECTIONS OF THE RECORD DRAWING AND HAS FOUND NO DISCREPANCIES. THE ENGINEER HAS CONDUCTED VISUAL INSPECTIONS OF THE RECORD DRAWING AND HAS FOUND NO DISCREPANCIES.

DESIGNER: JAMES J. BRASSY
DATE: 7/19/16
CHECKED BY: J.A.B.
DATE: 9/16/16
DWG. NO.: 10163-A-11-0
PROJECT NO.: 18-84

CLIENT: HANCOCK NATURAL RESOURCE GROUP
PROJECT: SPOTTED COW - WIADA013
TITLE: ALTA/NSPS LAND TITLE SURVEY
 T.C. NCS-960278-1-WA1 - PARCELS K, L, M, N AND O

ESP GROUP, INC.
LAMPERT-LEE & ASSOCIATES
 ENGINEERS • SURVEYORS • PLANNERS

10988 State Hwy. 54 East • Wisconsin Rapids, WI 54494-8718
 715-424-3131 or 715-344-0068 • FAX 715-423-8774

REVISIONS
 BY DATE DESCRIPTION

11 22 SHEETS