

As Given By
 Mid-State Associates
 1111 Eighth Street
 Baraboo, Wisconsin
 September, 1971

G.L.4

Survey of Lots 14 & 15, Block 8, Crystal Beach
 Subdivision, Section 11, T15N, R7E, Adams County,
 Wisconsin.

LEGEND

● = 3/4" x 24" IRON ROD
 PROJ. NO. 4427

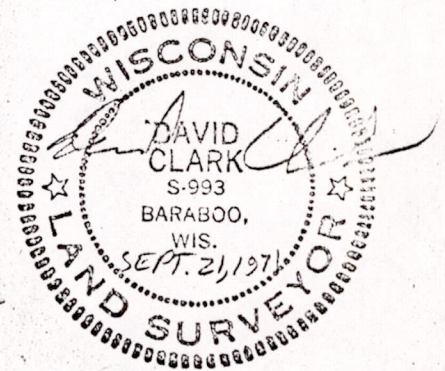

POS 11150700002