

N

SCALE: 1"=100'

-LEGEND-

●=3/4"x24" IRON ROD

FIELD BOOK NO. 384

PAGE. 61

PROJ. NO. 3900

As Given By  
 Mid-State Associates  
 1111 Eighth Street  
 Baraboo, Wisconsin

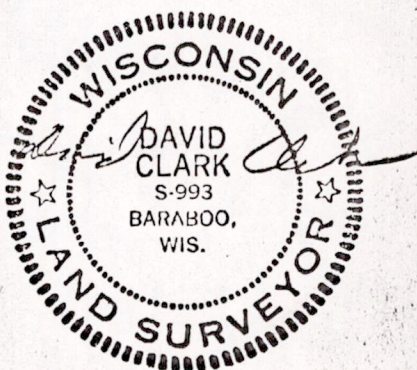

OCT. 22, 1970

A PARCEL OF LAND  
 LOCATED IN  
 THE SW<sup>1</sup>/<sub>4</sub>-NW<sup>1</sup>/<sub>4</sub> SECTION 28, T15N, R7E  
 TOWN OF JACKSON, ADAMS COUNTY, WISCONSIN

A parcel of land located in the SW<sup>1</sup>/<sub>4</sub>-NW<sup>1</sup>/<sub>4</sub> Section 28, T15N, R7E, Town of Jackson, Adams County, Wisconsin, which is bounded by a line described as follows:

Commencing at the west one-quarter corner of said Section 28; thence Northerly 1126.4 feet along the west line of said Section 28 to a point in the centerline of C.T.H. "I"; thence N86°11'E, 96.0 feet along the centerline of C.T.H. "I"; thence N84°55'E, 900.0 feet along the centerline of C.T.H. "I" to the point of beginning;

thence continuing N84°59'E, 130.0 feet along the centerline of C.T.H. "I"; thence N80°55'E, 175.0 feet along the centerline of C.T.H. "I" to a point on the east line of the SW<sup>1</sup>/<sub>4</sub>-SW<sup>1</sup>/<sub>4</sub> said Section 28; thence South 438.7 feet along the east line of the SW<sup>1</sup>/<sub>4</sub>-SW<sup>1</sup>/<sub>4</sub> said Section 28; thence S84°51'W, 303.0 feet; thence N0°04'W, 426.9 feet to the point of beginning.

Said parcel contains 2.98 acres.

Pos 28150721004