

ADAMS COUNTY

CENTER OF SECTION

Survey Monument Record

TYPE OF MONUMENT: 1" x 30" I.P. 1.68 LBS/FT.

STATE PLANE COORDINATES: N _____ E _____

ELEVATION — M.S.L. DATUM: _____

THETA ANGLE: _____

FIELD BOOK: 38 PAGE 14

CORNER NO. _____

SECTION 9

TOWN 16

RANGE 5

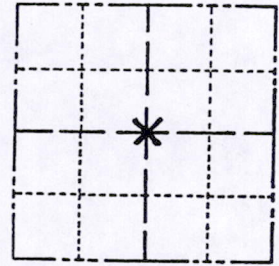

LOCATION (Indicated by 'X')

SEAL:

BASIS FOR MONUMENT LOCATION

(Use reverse side if necessary)

Show info such as: History of corner, with reference to Vol. and pg. dates, surveyor; exact description of monument replaced; if location computed, by taped or EDM traverse; landowner remarks, etc.

Ran EDM/T2 traverse around Southern half of Sections 8 and 9, and Sections 10, 11, and 12 to determine search areas for investigation and taped to North Quarter corner of Section 9.

Found remains of fence posts at intersection of very ancient fence lines to the East and South.

Could find no other evidence of the corner as set by County Surveyor J.S. Williams on September 6 and 7, 1871, as recorded in the loose leaf County Surveyor notes. This location matches the dimensions of Williams as close as can.

Found series of pipe from 16 feet North of Center of Section toward North Quarter corner, but none are of record.



CERTIFIED CORRECT:

Dale C Hagen Registered Land Surveyor

DATE: November 30, 1976

TIE SKETCH

(Show at least four ties)

NOTE:

Ties in trees to nail in disc.

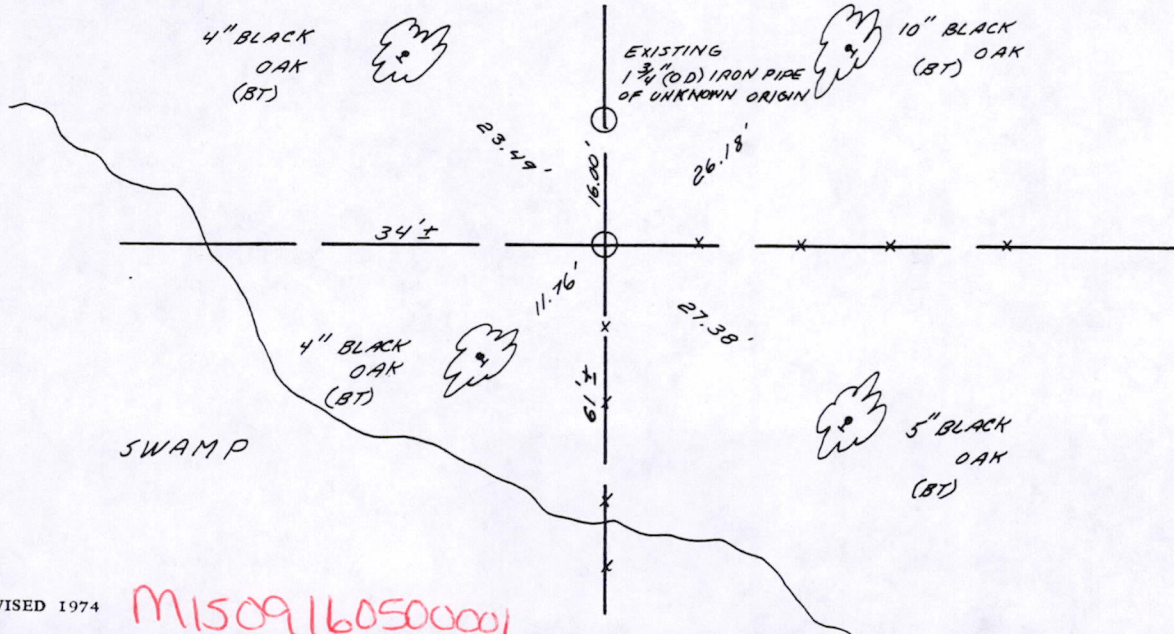

M1509160500001