

200

CERTIFICATE OF SURVEY.

STATE OF WISCONSIN, } ss. W. L. Smith Surveyor, in and for the County and State aforesaid, do
 ADAMS COUNTY. }
 hereby certify that I have surveyed and subdivided Section 34 Township 16 North of Range 5 East of 4th
 Principal Meridian, as represented by the courses and distances on the following plat, and annexed field-notes of survey:
 Established the center of the section at the point of intersection of straight quarter lines
 Established all quarter-quarter corners upon the section boundary at proportional distances between known section and quarter section
 corners, according to the original field-notes of the Government survey.
 Established all lost corners at proportionate distances between known corners, according to original field-notes of the Government survey:

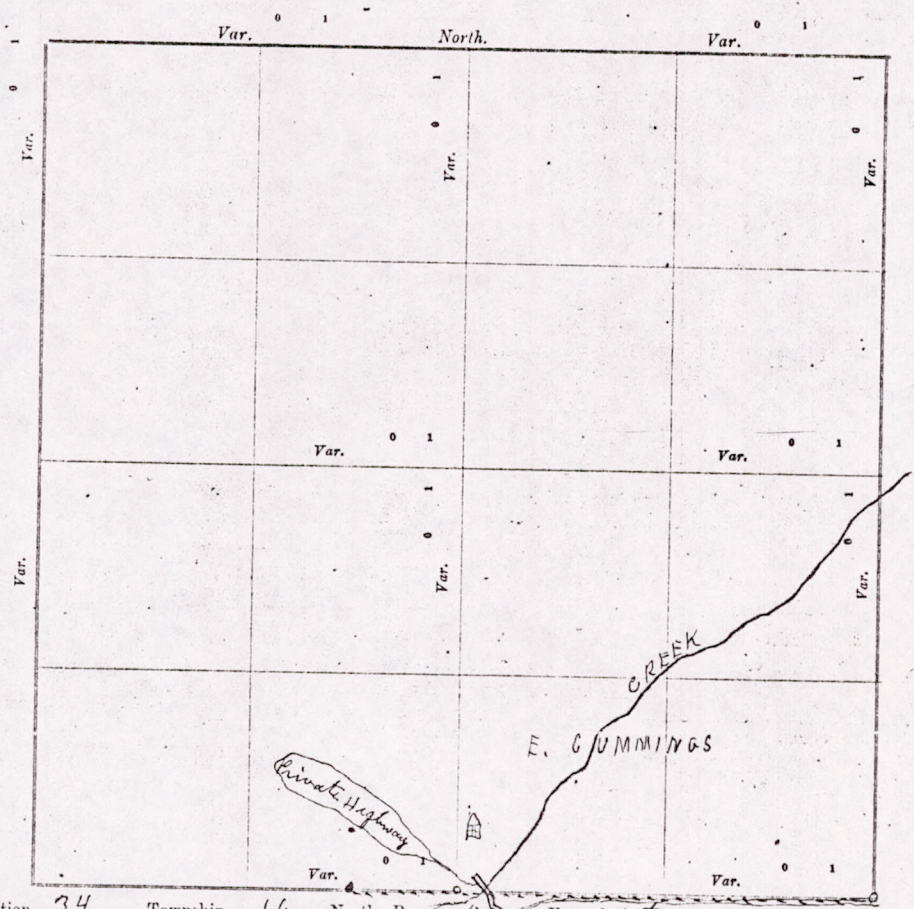

Plat of Section 34, Township 16 North, Range 5 East of 4th Principal Meridian. Scale, 80 chains to 0 inches. The figures in red ink are the lengths of the lines as stated in the field-notes of the Government survey.

Declination of the Magnetic Meridian from the True Meridian _____ East.
 Surveyed and subdivided this 29th Day of July A. D. 1914, in accordance with the State Laws and Instructions of the Commissioner of the General Land Office, and recorded on pages _____ of Register in the County Surveyor's office.
 WITNESS my hand this 29th day of July A. D. 1914.

W. L. Smith County Surveyor.

The above work was done at the request of E. Gumming's for the purpose of obtaining a private road from the main Highway to his land. said private Highway was surveyed by me as shown on Plat with Bert Pierce & Otto Hoffman as sworn chainmen.

W. L. Smith County Surveyor

MIS-34116050001