

## Wisconsin Department of Transportation

---

January 6, 2004

Greg Rhinehart  
Adams County Surveyor  
PO Box 187  
Friendship, WI 53934

Division of Transportation Districts  
District 4  
1681 Second Avenue South  
P O Box 8021  
Wisconsin Rapids, WI 54495-8021

Telephone: (715) 421-8300  
Facsimile (FAX): (715) 423-0334  
wisrapids.dtd@dot.state.wi.us

Dear Mr. Rhinehart:

SUBJECT: CTH H  
Duck Creek Crossing  
Re-staking right of way

*See 34-16-5 ?*

During the 2003 construction season we completed a new drainage structure over Duck Creek on CTH H located between STH 13 and CTH Z. During construction we disturbed one R/W pin that was staked out prior to this project starting. As a part of our contract, Meise Construction the prime contractor was responsible to reset any disturbed R/W or property pins disturbed during his construction operations. Meise Construction had Jewell Associates reset the R/W pin back to its original position. Enclosed is a copy of survey notes that was completed by Jewell Associates on Oct 3, 2003 for your review and for your records.

Please feel free to contact me at (715) 421-7383 if you have any questions.

Sincerely,

Mike Bohn  
Project Leader

Date: October 3, 2003

To: Mr. Bill Meise  
Meise Construction  
E4870 Synder Rd.  
Spring Green, WI 53588

RE: State Project I.D. 6385-00-70, CTH H, Adams County.

Dear Mr. Meise,

As per your request earlier this week we sent a survey crew to CTH H to verify the existing right-of-way marker north of station 21+25. We found the existing  $\frac{3}{4}$ " rebar disturb, approximately 0.25 feet off the original position. Therefore we pulled and reset the same  $\frac{3}{4}$ " rebar in the correct location as indicated on the plans, while also verifying the placement of the easterly right-of-way pins at station 21+25. The rest of these pins checked out.

Attached is stamped copy of our survey notes showing a sketch of the right-of-way points at station 21+25, along with the angles and distances recorded to verify, and to correct the disturbed pin.

If the project engineer or yourself have any questions, please feel free to give me a call.

Sincerely,

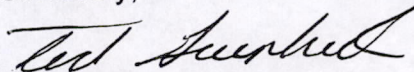

Ted Greenheck, RLS  
Vice President  
Jewell, a division of Clark Dietz, Inc.

MIS 34160500002

Project Name: 6385-00-70 No. \_\_\_\_\_

CTH "H" DUCK CREEK CROSSING, ADAMS COUNTY

Made by: CGR Date: 10-3-03 Checked by: TJG Date: 10/3/03

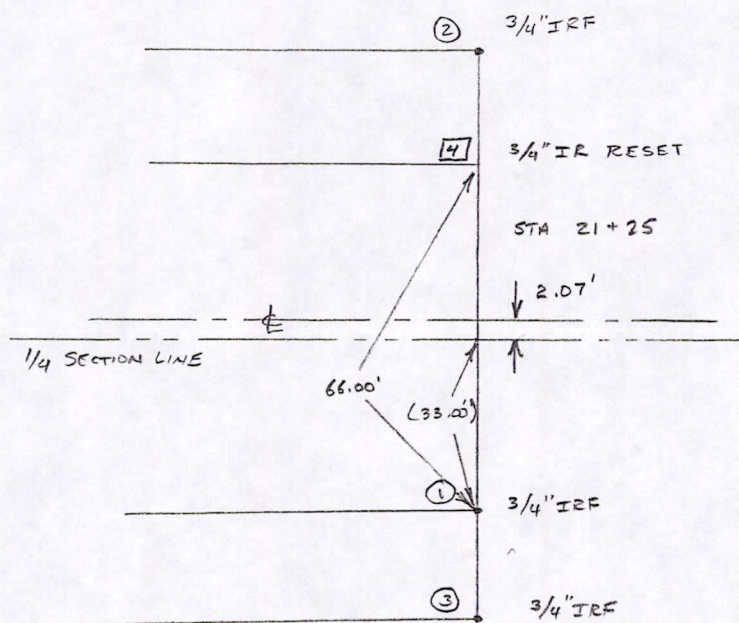

(1-2) HD 82.99' (83.00') ✓

(1-3) HD 11.97' (12.00') ✓

(3-2) HD 94.96' (95.00') ✓

4 (2-1-3) 179-59-43 ✓

RESET 3/4" IR AT POINT 4

(1-2) 00-00-00

(2-1-4) R  
00-00-00 66.00'

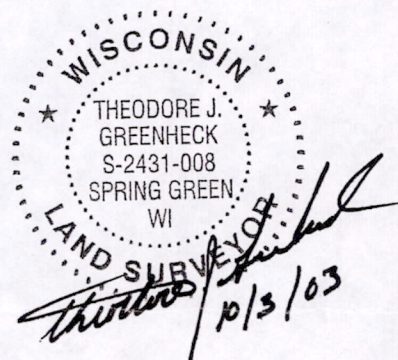

CLARK DIETZ

COMPUTATIONS

MIS 3416500002