

LEGEND	
•	= 3/4" x 24" IRON ROD.
	FB. 404, PG. 65
	PROJ. NO. 4796

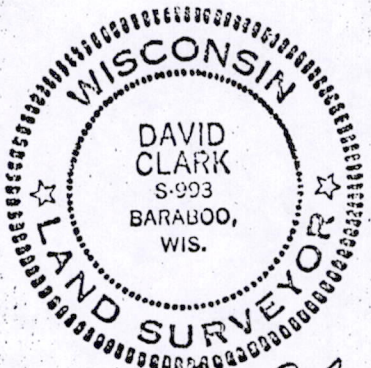

As Given By
Mid-State Associates
Baraboo, Wisconsin
May, 1972

[Signature]
MAY 30, 1972

P0535160511001

A PARCEL OF LAND
LOCATED IN
THE NE¹/₄-NE¹/₄ SECTION 35, T16N, R5E,
TOWN OF EASTON, ADAMS COUNTY, WISCONSIN

As Given By
Mid-State Associates
Baraboo, Wisconsin
May, 1972

PARCEL 2

A parcel of land located in the NE¹/₄-NE¹/₄ Section 35, T16N, R5E, Town of Easton, Adams County, Wisconsin, which is bounded by a line described as follows:

Commencing at the northeast corner of said Section 35; thence S89°50'W, 165 feet along the north line of said Section 35 to the point of beginning;

thence South 1032.5 feet parallel with the east line of said Section 35; thence N83°30'W, 225 feet parallel with the centerline of Evergreen Court; thence South 200 feet parallel with the east line of said Section 35 to a point in the centerline of Evergreen Court; thence N83°30'W, 945.93 feet along the centerline of Evergreen Court; thence N0°20'E, 1096 feet to a point on the north line of said Section 35; thence N89°50'E, 1157 feet along the north line of said Section 35 to the point of beginning.

Said parcel contains 30 acres, more or less, and is subject to easements of record.

P0535160511001