

CERTIFICATE OF SURVEY.

STATE OF WISCONSIN, }
ADAMS COUNTY. }

M. C. Smith County Surveyor, in and for the County and State of Wisconsin

hereby certify that I have surveyed and subdivided Section 7 Township 16 North of Range 6 East of Principal Meridian, as represented by the courses and distances on the following plat, and annexed field-notes of survey:

Established the center of the section at the point of intersection of *straight* quarter lines.

Established all quarter-quarter corners upon the section boundary at proportional distances between known section and quarter corners, according to the original field-notes of the Government survey.

Established all lost corners at proportionate distances between known corners, according to original field-notes of the Government survey.

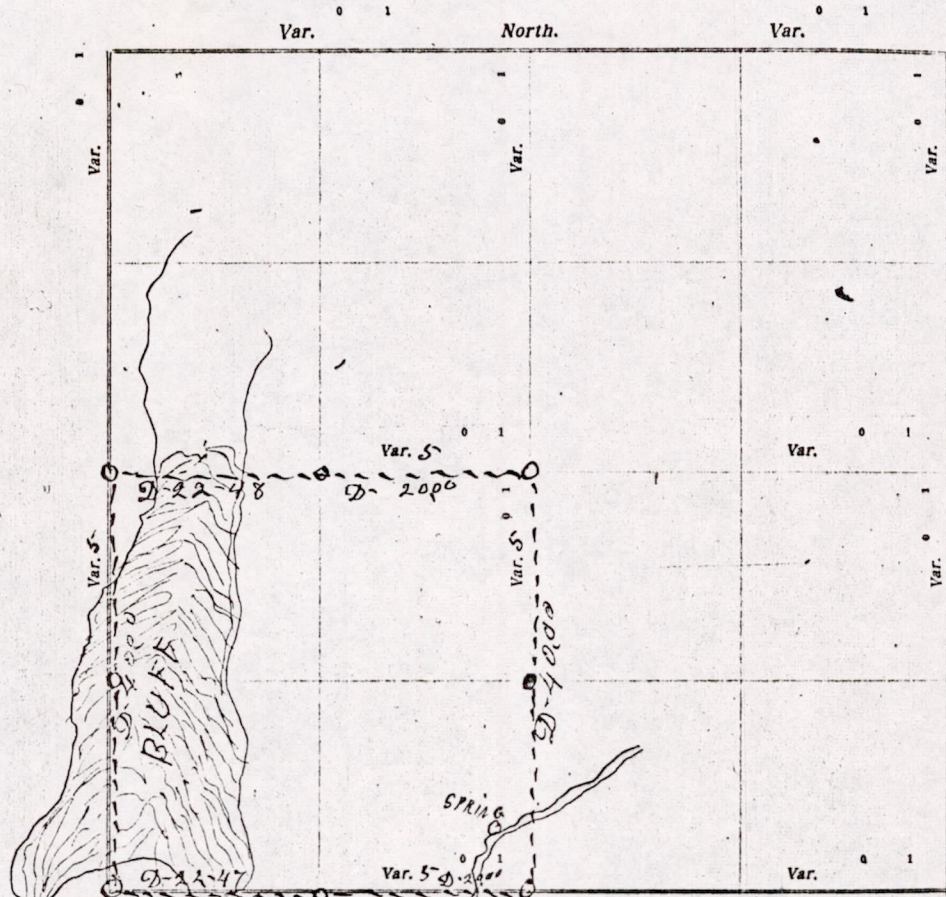

Plat of Section 7 Township 16 North, Range 6 East of 4th Principal Meridian. Scale, 80 chains to 1 inch. The figures in red ink are the lengths of the lines as stated in the field-notes of the Government survey.

Declination of the Magnetic Meridian from the True Meridian _____ East.

Surveyed and subdivided 25th Day of June A. D. 1918, in accordance with the State Laws and Instructions

of the Commissioner of the General Land Office, and recorded on pages _____ of Register in the County Surveyor's office.

WITNESS my hand this 27th day of June A. D. 1918.

M. C. Smith County Surveyor

The above work was done at the request of J. B. Palka, et al.

M1507160600001

DESCRIPTION of Section, Quarter Section and Quarter quarter Section Corners of Section

Township North, Range East of Principal Meridian.

N. B. - The variation of needle adopted in establishing corners is

Government Corners.	Bearing Trees.	In. dia.	Courses they bear.	Links Distant.	Bearing Trees.	In. dia.	Courses they bear.	Links Distant.
No. 1 N. W. Sec. cor. Identified								
2 N. E. Sec. cor. Identified								
3 S. E. Sec. cor. Identified								
4 S. W. Sec. cor. Identified								
5 N. 1/4 Sec. cor. Identified								
6 E. 1/4 Sec. cor. Identified								
7 S. 1/4 Sec. cor. Identified	Poplar	4	N. 80° E.	50				
8 W. 1/4 Sec. cor. Identified								
NO. SUBDIVISION CORNERS.								
1 Center 1/4 Sec. cor.								
2 North 1/4-1/4s N. W. qr.								
3 East 1/4-1/4s N. W. qr.								
4 South 1/4-1/4s N. W. qr.								
5 West 1/4-1/4s N. W. qr.								
6 Center 1/4-1/4s N. W. qr.								
7 North 1/4-1/4s N. E. qr.								
8 East 1/4-1/4s N. E. qr.								
9 South 1/4-1/4s N. E. qr.								
10 Center 1/4-1/4s N. E. qr.								
11 East 1/4-1/4s S. E. qr.								
12 South 1/4-1/4s S. E. qr.								
13 West 1/4-1/4s S. E. qr.								
14 Center 1/4-1/4s S. E. qr.								
15 South 1/4-1/4s S. W. qr.								
16 West 1/4-1/4s S. W. qr.								
17 Center 1/4-1/4s S. W. qr.								

Could find any trees as described by govt. Government trees there.

Poplar 4 N. 80° E. 50

NAMES OF SWORN ASSISTANTS.

CHAINMEN.	FLAGMEN.	AXMEN.
Will and Thomas Day	Jacob Woodard	H. E. Felton

MINUTES.

M1507160600001

said, do
section
urvey:
chains to 0
ructions of
urveyor
Day
Section
ack
side of 18

DESCRIPTION of Section, Quarter Section and Quarter-quarter Section Corners of Section
 Township _____ North, Range _____ East of _____ Principal Meridian.

N. B. - The variation of needle adopted in establishing corners is _____

and State aforesaid, J.
 East of _____

and quarter section
 Government survey:

No.	Government Corners	Bearing Trees	In. dia.	Courses they bear	Links Distant	Bearing Trees	In. dia.	Courses they bear	Links Distant
1	N. W. Sec. cor. Identified								
2	N. E. Sec. cor. Identified								
3	S. E. Sec. cor. Identified								
4	S. W. Sec. cor. Identified								
5	N. $\frac{1}{4}$ Sec. cor. Identified								
6	E. $\frac{1}{4}$ Sec. cor. Identified								
7	S. $\frac{1}{4}$ Sec. cor. Identified								
8	W. $\frac{1}{4}$ Sec. cor. Identified								
Subdivision Corners.									
1	Center $\frac{1}{4}$ Sec. cor.								
2	North $\frac{1}{4}$ - $\frac{1}{4}$ s N. W. qr.								
3	East $\frac{1}{4}$ - $\frac{1}{4}$ s N. W. qr.								
4	South $\frac{1}{4}$ - $\frac{1}{4}$ s N. W. qr.								
5	West $\frac{1}{4}$ - $\frac{1}{4}$ s N. W. qr.								
6	Center $\frac{1}{4}$ - $\frac{1}{4}$ s N. W. qr.								
7	North $\frac{1}{4}$ - $\frac{1}{4}$ s N. E. qr.								
8	East $\frac{1}{4}$ - $\frac{1}{4}$ s N. E. qr.								
9	South $\frac{1}{4}$ - $\frac{1}{4}$ s N. E. qr.								
10	Center $\frac{1}{4}$ - $\frac{1}{4}$ s N. E. qr.								
11	East $\frac{1}{4}$ - $\frac{1}{4}$ s S. E. qr.								
12	South $\frac{1}{4}$ - $\frac{1}{4}$ s S. E. qr.								
13	West $\frac{1}{4}$ - $\frac{1}{4}$ s S. E. qr.								
14	Center $\frac{1}{4}$ - $\frac{1}{4}$ s S. E. qr.								
15	South $\frac{1}{4}$ - $\frac{1}{4}$ s S. W. qr.								
16	West $\frac{1}{4}$ - $\frac{1}{4}$ s S. W. qr.								
17	Center $\frac{1}{4}$ - $\frac{1}{4}$ s S. W. qr.								

NAMES OF SWORN ASSISTANTS.

CHAINMEN	FLAGMEN	AXMEN
W R Atchison Anton Wroble		

Scale, 80 chains to 1

Laws and Instructions of
 or's office.

Surveyor.

of Chicago.

MINUTES.

Commencing at the Identified quarter Post on the west side of section
 16-2-16-R-6 E. on the Range line on the west side of the Bluff and ran
 East 42 chains & 48 links to Post at center of section, then from
 said quarter Post ran south at S. D. V 40 chains to the Identified
 W corner of said section, thence East on section line at S. D. V
 42 & 47 links to Quarter Post on South side of said section,
 thence north at S. D. V on the quarter line 40 chains to Post at center
 of the section

M. C. Smith County Surveyor

M1507160600001

CERTIFICATE OF SURVEY.

STATE OF WISCONSIN, }
ADAMS COUNTY. }

M. Le. Smith County Surveyor, in and for the County and State at

herby certify that I have surveyed and subdivided Section 7 Township 16 North of Range 6 East of Principal Meridian, as represented by the courses and distances on the following plat, and annexed field-notes of survey:

Established the center of the section at the point of intersection of *straight* quarter lines.

Established all quarter-quarter corners upon the section boundry at proportionel distances between known section and quarter corners, according to the original field-notes of the Government survey.

Established all lost corners at proportionate distances between known corners, according to original field-notes of the Government survey.

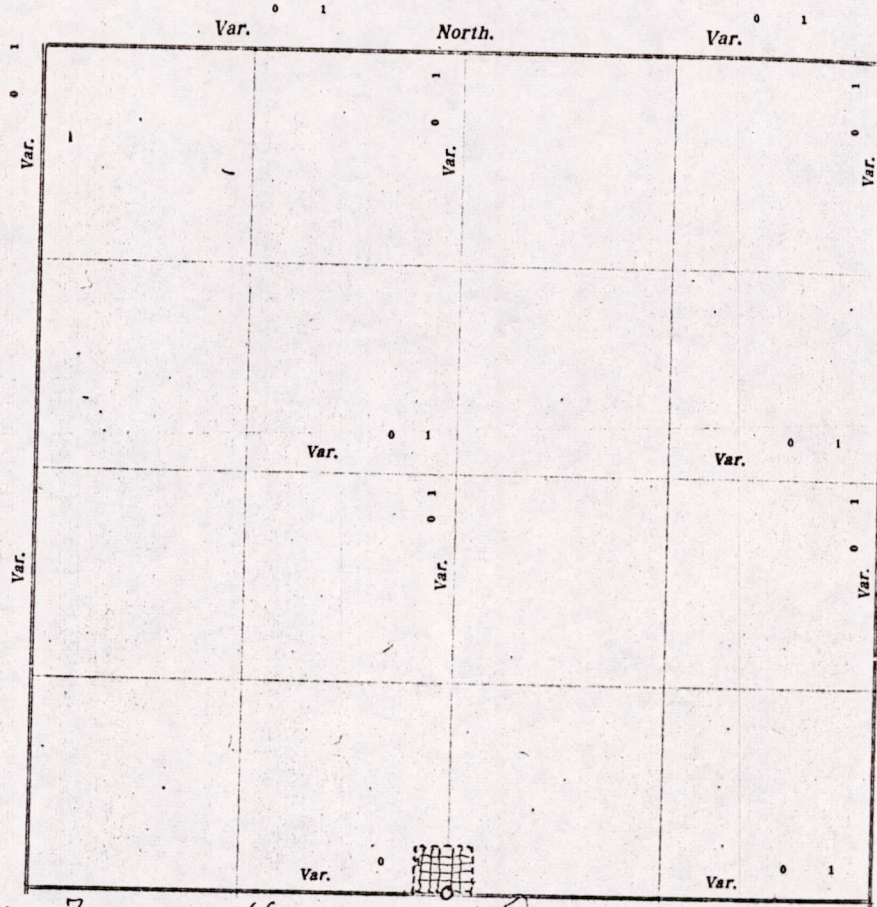

Plat of Section 7, Township 16 North, Range 6 East of 4th Principal Meridian. Scale, 80 chains to 1 inch. The figures in red ink are the lengths of the lines as stated in the field-notes of the Government survey.

Declination of the Magnetic Meridian from the True Meridian _____ East.

Surveyed and subdivided *Platted a Cemetery July 12-13* A. D. 1918, in accordance with the State Laws and Instructions of the Commissioner of the General Land Office, and recorded on pages _____ of Register in the County Surveyor's office.

WITNESS my hand this 13 day of July A. D. 1918.

M. Le. Smith County Surveyor

The above work was done at the request of the Town Board of the Town of Quincy James Chairman

MISO7160600001

DESCRIPTION of Section, Quarter Section and Quarter-quarter Section Corners of Section
 Township _____ North, Range _____ East of _____ Principal Meridian.

N. B. The variation of meridian adopted in establishing corners is _____

No.	Government Corners	Bearing Trees	In. dia.	Courses they bear	Links Distant	Bearing Trees	In. dia.	Courses they bear	Links Distant
1	N. W. Sec. cor. Identified								
2	N. E. Sec. cor. Identified								
3	S. E. Sec. cor. Identified								
4	S. W. Sec. cor. Identified								
5	N. $\frac{1}{4}$ Sec. cor. Identified								
6	E. $\frac{1}{4}$ Sec. cor. Identified								
7	S. $\frac{1}{4}$ Sec. cor. Identified	RAW Bunch	12	S-9-W	101				
8	W. $\frac{1}{4}$ Sec. cor. Identified								
Subdivision Corners.									
1	Center $\frac{1}{4}$ Sec. cor.								
2	North $\frac{1}{4}$ - $\frac{1}{4}$ s N. W. qr.								
3	East $\frac{1}{4}$ - $\frac{1}{4}$ s N. W. qr.								
4	South $\frac{1}{4}$ - $\frac{1}{4}$ s N. W. qr.								
5	West $\frac{1}{4}$ - $\frac{1}{4}$ s N. W. qr.								
6	Center $\frac{1}{4}$ - $\frac{1}{4}$ s N. W. qr.								
7	North $\frac{1}{4}$ - $\frac{1}{4}$ s N. E. qr.								
8	East $\frac{1}{4}$ - $\frac{1}{4}$ s N. E. qr.								
9	South $\frac{1}{4}$ - $\frac{1}{4}$ s N. E. qr.								
10	Center $\frac{1}{4}$ - $\frac{1}{4}$ s N. E. qr.								
11	East $\frac{1}{4}$ - $\frac{1}{4}$ s S. E. qr.								
12	South $\frac{1}{4}$ - $\frac{1}{4}$ s S. E. qr.								
13	West $\frac{1}{4}$ - $\frac{1}{4}$ s S. E. qr.								
14	Center $\frac{1}{4}$ - $\frac{1}{4}$ s S. E. qr.								
15	South $\frac{1}{4}$ - $\frac{1}{4}$ s S. W. qr.								
16	West $\frac{1}{4}$ - $\frac{1}{4}$ s S. W. qr.								
17	Center $\frac{1}{4}$ - $\frac{1}{4}$ s S. W. qr.								

NAMES OF SWORN ASSISTANTS.

CHAINMEN

FLAGMEN

AXMEN

Geo. Shovel
R. J. Moshure

MINUTES.

The above cemetery is located in the S E corner of the S E-S W $\frac{1}{4}$ section 7 and in the S W corner of the S W-S E $\frac{1}{4}$ section 7 Twp. 16-R-6-E. It is divided into driveway alleys, lots and blocks, is 3 and half chains North & South and 5 chains East & West and contains two acres, a certified Plat of which is on record in the register of deeds office at Friendship.

M. C. Smith County Surveyor

M1507160600001

CERTIFICATE OF SURVEY.

STATE OF WISCONSIN, } ss. *1. Hugh C. Hurley*
 ADAMS COUNTY.

1. Hugh C. Hurley Surveyor, in and for the County and State aforesaid, do hereby certify that I have surveyed and subdivided Section 7 Township 16 North of Range 6 East of Principal Meridian, as represented by the courses and distances on the following plat, and annexed field-notes of survey:
 Established the center of the section at the point of intersection of straight quarter lines.
 Established all quarter-quarter corners upon the section boundary at proportional distances between known section and quarter section corners, according to the original field-notes of the Government survey.
 Established all lost corners at proportionate distances between known corners, according to original field-notes of the Government survey:

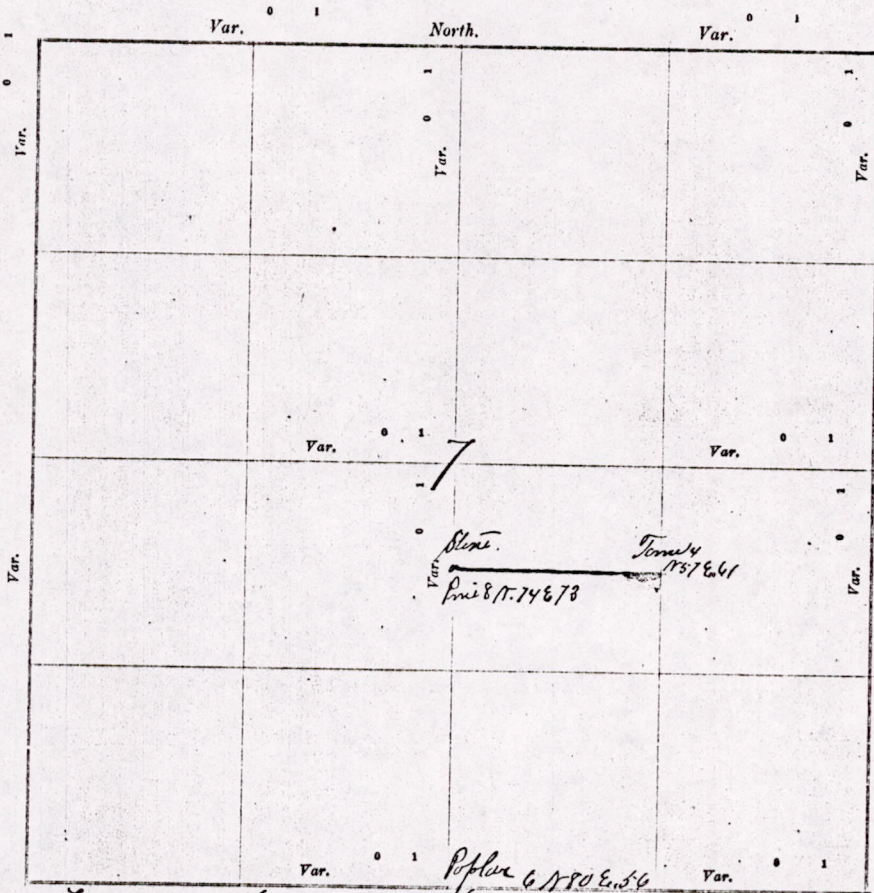

DESCRIP
Township
N. B. - The variat

No.	DESCRIPTION
1	N. W. Sec. 1
2	N. E. Sec. 1
3	S. E. Sec. 1
4	S. W. Sec. 1
5	N. 1/4 Sec. 2
6	E. 1/4 Sec. 2
7	S. 1/4 Sec. 2
8	W. 1/4 Sec. 2
No.	SUBDIVISION
1	Center 1/4 Sec.
2	North 1/4-1/4
3	East 1/4-1/4
4	South 1/4-1/4
5	West 1/4-1/4
6	Center 1/4-1/4
7	North 1/4-1/4
8	East 1/4-1/4
9	South 1/4-1/4
10	Center 1/4-1/4
11	East 1/4-1/4
12	South 1/4-1/4
13	West 1/4-1/4
14	Center 1/4-1/4
15	South 1/4-1/4
16	West 1/4-1/4
17	Center 1/4-1/4

Well and Thomas

Plat of Section 7, Township 16 North, Range 6 East of Y Principal Meridian. Scale, 80 chains to 6 inches. The figures in red ink are the lengths of the lines as stated in the field-notes of the Government survey.

Declination of the Magnetic Meridian from the True Meridian _____ East.

Surveyed and subdivided _____ A. D. 19 _____, in accordance with the State Laws and Instructions of

the Commissioner of the General Land Office, and recorded on pages _____ of Register in the County Surveyor's office.

WITNESS my hand this 28 day of April A. D. 1903.

Hugh C. Hurley Surveyor.

I am surveying and dividing section 7. From G. Range 6. E on South side of section I find a large Black oak, as described by government survey R. C. 18. N 48 E. 340 links but the tree has been split and there is nothing definite enough to be sure I measured the section East and west and divided the distance and found the large oak very near where my chaining came thru I chained from South side of 18 and established the stake not marked on diagram

M1507160600001