

S88°33'E, 36'

NORTH

A strip of land 36 feet in width located in the SE¹/₄-SW¹/₄, Section 9, T16N, R6E, Town of Easton, Adams County, Wisconsin, which is bounded by a line described as follows:

Commencing at the South one-quarter corner of said Section 9; thence N88°33'W, 30 feet along the south line of said Section 9 to the point of beginning;

thence continuing N88°33'W, 36 feet along the south line of said Section 9; thence N1°49'E, 660 feet parallel with the north-south one-quarter line of said Section 9 to a point on the north line of the south one-half of the SE¹/₄-SW¹/₄ of said Section 9; thence S88°33'E, 36 feet along the north line of the south one-half of the SE¹/₄-SW¹/₄ of said Section 9; thence S1°49'W, 660 feet parallel with the north-south one-quarter line of said Section 9 to the point of beginning.

Said strip of land contains 0.54 acre and is subject to easements of record.

SCALE: 1"=100'

LEGEND

o = 2" IRON PIPE

X = PK NAIL

Prepared By
Mid-State Associates
Baraboo, Wisconsin
May, 1971

0.54 AC.
660'
N 1°49'E
660'
S 1°49'W

P.O.B.
SOUTH 1/4 CORNER
SEC. 9, T16N, R6E,
EDGEWOOD AVE

N 88°33' W 36' N 88°33' W 30'

SOUTH LINE OF SEC. 9

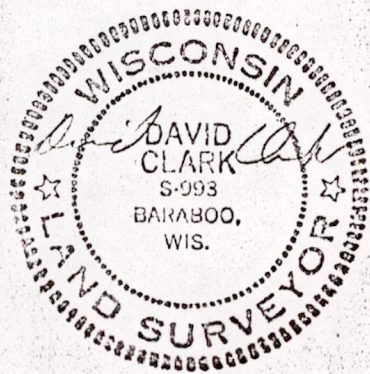

POS09160631001