

PARCEL 19
5.20 AC.±

SCALE: 1"=100'

• 3/4" IRON ROD



A parcel of land located in the SE¹/₄-SW¹/₄ Section 23, T16N, R6E, Town of Easton, Adams County, Wisconsin, which is bounded by a line described as follows:

Commencing at the south one-quarter corner of said Section 23; thence S84° 30' W, 1320.00 feet along the south line of said Section 23; to the southwest corner of the SE¹/₄-SW¹/₄ of said Section 23; thence N05° 45' W, 230 feet along the west line of the SE¹/₄-SW¹/₄ to the point of beginning;

thence continuing N05° 45' W, 710.0 feet along the west line of the SE¹/₄-SW¹/₄; thence S81° 44' E, 541.90 feet to a point of curve; thence along the arc of a curve to the right, radius 100 feet whose chord bears S22° 00' 08" E, 125.02 feet; thence S45° 08' W, 726.60 feet to the point of beginning.

Said parcel contains 5.20 acres.

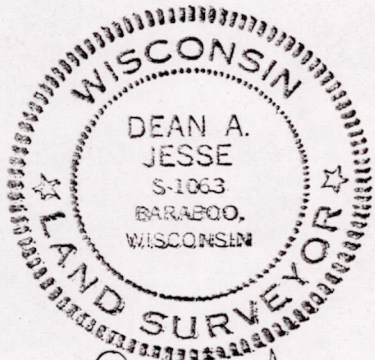

Dean A. Jesse
9/18/73

230'
WEST LINE SE¹/₄-SW¹/₄

S84°30' W 1320'
SOUTH LINE SEC. 23

SW COR.
SE¹/₄-SW¹/₄

Pos 23160631001