

MAGNETIC

LEGEND

• = 3/4" X 24" IRON ROD

SCALE: 1" = 100'

As Given By  
Mid-State Associates  
Baraboo, Wisconsin  
December, 1971

PARCEL 20  
5.29 ACRES

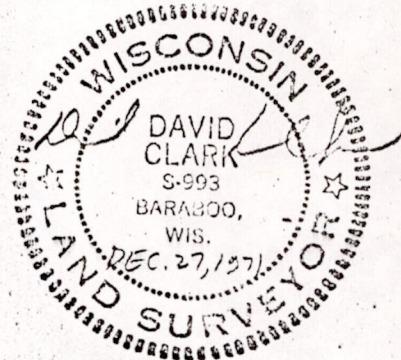

WEST LINE SE 1/4 - SW 1/4

N 5° 45' W 230'

SW CORNER  
SE 1/4 - SW 1/4

S 84° 30' W 357.69'

P.O.B.

S 84° 30' W

962.31'

SOUTH 1/4 CORNER  
SEC. 23, T16N, R6E

SOUTH LINE OF SEC. 23

A PARCEL OF LAND  
LOCATED IN  
THE SE 1/4 - SW 1/4 SECTION 23, T16N, R6E,  
TOWN OF EASTON, ADAMS COUNTY, WISCONSIN

797.06'

N 45° 08' E

789.58'

S 19° 05' E

S 81° 38' E  
73.05'

60' R

66'

Pos 23160631008

A PARCEL OF LAND  
LOCATED IN  
THE SE $\frac{1}{4}$ -SW $\frac{1}{4}$  SECTION 23, T16N, R6E,  
TOWN OF EASTON, ADAMS COUNTY, WISCONSIN

As Given By  
Mid-State Associates  
Baraboo, Wisconsin  
December, 1971

A parcel of land located in the SE $\frac{1}{4}$ -SW $\frac{1}{4}$  Section 23, T16N, R6E, Town of Easton, Adams County, Wisconsin, which is bounded by a line described as follows:

Commencing at the south one-quarter corner of said Section 23; thence S84°30'W, 962.31 feet along the south line of said Section 23 to the point of beginning;

thence continuing S84°30'W, 357.69 feet along said south line to the southwest corner of the SE $\frac{1}{4}$ -SW $\frac{1}{4}$  of said Section 23; thence N5°45'W, 230 feet along the west line of the SE $\frac{1}{4}$ -SW $\frac{1}{4}$ ; thence N45°08'E, 797.06 feet to a point of curve; thence along the arc of a curve to the left, radius 60 feet whose chord bears S81°38'E, 73.05 feet; thence S19°05'E, 789.58 feet to the point of beginning.

Said parcel contains 5.29 acres.

POS 23160631003