

PARCEL 18  
5.48 AC.±

As Given by  
Mid-State Associates, Inc.  
Baraboo, Wisconsin  
September, 1973



A parcel of land located in the SE 1/4-SW 1/4 Section 23, T16N, R6E, Town of Easton, Adams County, Wisconsin, which is bounded by a line described as follows:

Commencing at the south one-quarter corner of said Section 23; thence N05°37'30"W, 806 feet along the north-south one-quarter line of said Section 23; thence S84°30'W, 512 feet parallel with the south line of said Section 23 to the point of beginning;

thence continuing S84°30'W, 100 feet parallel with the south line of said Section 23 to a point of curve; thence along the arc of a curve to the right, radius 100 feet whose chord bears S85°57'41"W, 187.05 feet; thence N81°44'W, 541.90 feet; thence N05°45'W, 240 feet along the west line of the SE 1/4-SW 1/4; thence N87°56'E, 815.13 feet; thence S05°37'30"E, 325 feet to the point of beginning.

Said parcel contains 5.48 acres.

POS23160631011

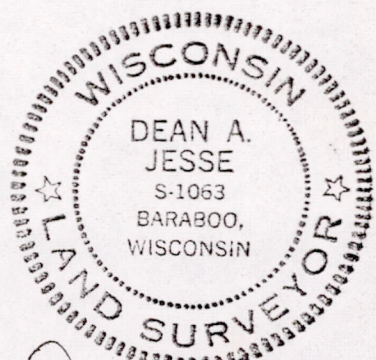

Dean A. Jesse  
9/18/73