

N
MAGNETIC

SCALE: 1" = 100'

LEGEND
● = 3/4" X 24" IRON ROD

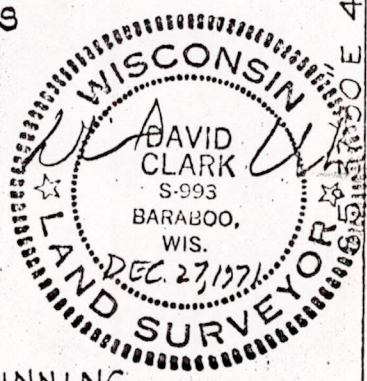

As Given By
Mid-State Assoc.
Baraboo, Wisc.
December, 1971

A parcel of land located in the NE¹/₄-SW¹/₄ and in the SE¹/₄-SW¹/₄ Section 23, T16N, R6E, Town of Easton, Adams County, Wisconsin which is bounded by a line described as follows:

Commencing at the south one-quarter corner of said Section 23; thence N5°37'30"W, 1246.00 feet; thence S84°30'W, 6.00 feet parallel with the south line of said Section 23 to the point of beginning;

thence continuing S84°30'W, 500.00 feet parallel with the south line of said Section 23; thence N5°37'30"W, 440.00 feet parallel with the north-south one-quarter line of said Section 23; thence N84°30'E, 500.00 feet parallel with the south line of said Section 23; thence S5°37'30"E, 440.00 feet parallel with the north-south one-quarter line of said Section 23 to the point of beginning.

Said parcel contains 5.05 acres.

Pos 23160631013