

As Given By
Mid-State Associates
Baraboo, Wisconsin
December, 1971

DESCRIPTION:

A parcel of land located in the SE $\frac{1}{4}$ -SW $\frac{1}{4}$ Section 23, T16N, R6E, Town of Easton, Adams County, Wisconsin, which is bounded by a line described as follows:

Commencing at the south one-quarter corner of said Section 23; thence S84°30'W, 182.31 feet along the south line of said Section 23 to the point of beginning;

thence continuing S84°30'W, 300 feet; thence N5°38'W, 740 feet; thence N84°30'E 300 feet parallel with the south line of said Section 23; thence S5°38'W, 740 feet to the point of beginning.

Said parcel contains 5.1 acres.



SCALE 1"=100'

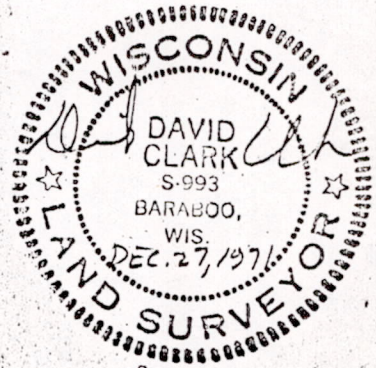

POINT OF BEGINNING

SOUTH LINE
SEC. 23

300' 182.31'

S 84° 30' W S 84° 30' W

• 3/4" x 24" RD. IRON ROD

SOUTH 1/4 COR., SEC. 23
T16N, R6E

- PREPARED BY -
MID-STATE ASSOCIATES
1111-8TH STREET
BARABOO, WIS.

Pos 23160631014