

PARCEL 26
5.1 ACRES

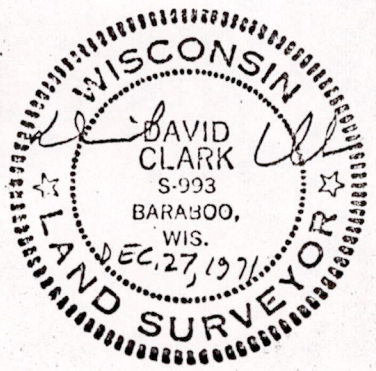

SOUTH 1/4
SEC. 23, T16N, R6E

P.O.B.

SOUTH LINE SEC. 23

N 84°30' W
417.69'

As Given By
Mid-State Associates
Baraboo, Wisconsin
December, 1971

MAGNETIC

SCALE: 1" = 100'

LEGEND

● = 3/4" X 24" IRON RO

DESCRIPTION:

A parcel of land located in the SW¹/₄-SE¹/₄ Section 23, T16N, R6E, Town of Easton, Adams County, Wisconsin, which is bounded by a line described as follows:

Commencing at the south one-quarter corner of said Section 23; thence N84°30'W, 417.69 feet along the south line of said Section 23 to the point of beginning;

thence N5°38'W, 370 feet; thence N84°30'E, 600 feet parallel with the south line of said Section 23 to a point on the west line of Eighth Court; thence S5°38'E, 370 feet along the west line of Eighth Court to a point on the south line of said Section 23; thence S84°30'W, 600 feet along the south line of said Section 23 to the point of beginning.

Said parcel contains 5.1 acres.

POS 23160641007