

# CERTIFICATE OF SURVEY.

STATE OF WISCONSIN, } ss. I,  
ADAMS COUNTY.

Surveyor, in and for the County and State of Wisconsin, do hereby certify that I have surveyed and subdivided Section \_\_\_\_\_ Township \_\_\_\_\_ North of Range \_\_\_\_\_ East of \_\_\_\_\_ Principal Meridian, as represented by the courses and distances on the following plat, and annexed field-notes of survey:

Established the center of the section at the point of intersection of *straight* quarter lines.  
Established all quarter-quarter corners upon the section boundary at proportional distances between known section and quarter section corners, according to the original field-notes of the Government survey.  
Established all lost corners at proportionate distances between known corners, according to original field-notes of the Government survey.

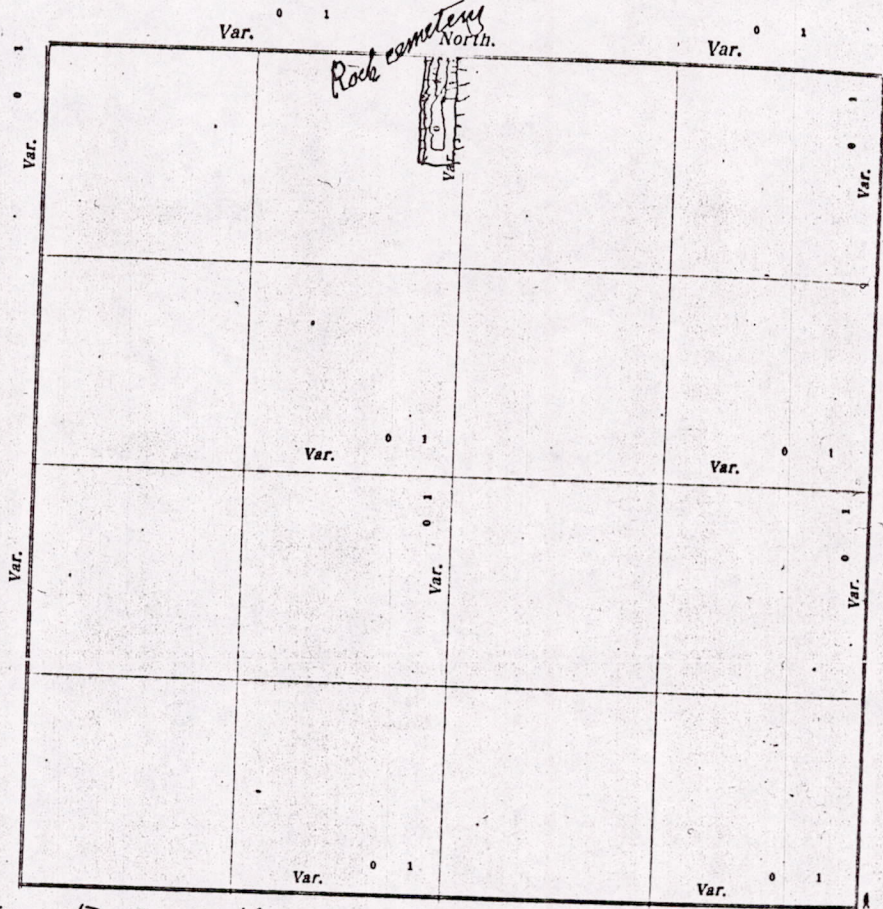

Plat of Section 5, Township 16 North, Range 7 East of \_\_\_\_\_ Principal Meridian. Scale, 80 chains to 4 inches. The figures in red ink are the lengths of the lines as stated in the field-notes of the Government survey.

Declination of the Magnetic Meridian from the True Meridian \_\_\_\_\_ East.

Surveyed and subdivided \_\_\_\_\_ A. D. 19 \_\_\_\_\_, in accordance with the State Laws and Instructions of

the Commissioner of the General Land Office, and recorded on pages \_\_\_\_\_ of Register in the County Surveyor's office.

WITNESS my hand this \_\_\_\_\_ day of \_\_\_\_\_ A. D. 19 \_\_\_\_\_

Surveyor.

MIS05160700001

DESCRIPTION of Section, Quarter Section and Quarter-quarter Section Corners of Section

Township \_\_\_\_\_ North, Range \_\_\_\_\_ East of \_\_\_\_\_ Principal Meridian.

145

N. B.—The variation of needle adopted in establishing corners is \_\_\_\_\_

No.	Government Corners	Bearing Trees	In. dia.	Courses they bear	Links Distant	Bearing Trees	In. dia.	Courses they bear	Links Distant
1	N. W. Sec. cor. Identified								
2	N. E. Sec. cor. Identified								
3	S. E. Sec. cor. Identified								
4	S. W. Sec. cor. Identified								
5	N. ¼ Sec. cor. Identified	New	Blk oak	14	S-71-W	102 ½			
6	E. ¼ Sec. cor. Identified								
7	S. ¼ Sec. cor. Identified								
8	W. ¼ Sec. cor. Identified								
<b>No. SUBDIVISION CORNERS.</b>									
1	Center ¼ Sec. cor.								
2	North ¼-¼s N. W. qr.								
3	East ¼-¼s N. W. qr.								
4	South ¼-¼s N. W. qr.								
5	West ¼-¼s N. W. qr.								
6	Center ¼-¼s N. W. qr.								
7	North ¼-¼s N. E. qr.								
8	East ¼-¼s N. E. qr.								
9	South ¼-¼s N. E. qr.								
10	Center ¼-¼s N. E. qr.								
11	East ¼-¼s S. E. qr.								
12	South ¼-¼s S. E. qr.								
13	West ¼-¼s S. E. qr.								
14	Center ¼-¼s S. E. qr.								
15	South ¼-¼s S. W. qr.								
16	West ¼-¼s S. W. qr.								
17	Center ¼-¼s S. W. qr.								

NAMES OF SWORN ASSISTANTS.

CHAINMEN	FLAGMEN	AXMEN
Mark McSheaney Charles Mainard		

MINUTES.

Rock Cemetery near Grand Marsh, about 5 ¼ acres divided into lots 25-foot square, along the west line lots are 14 x 25 feet 104 lots with 6 feet alleys a tile marker placed at the N E corner of each lot. said cemetery is located on the N E ¼ of the NW ¼ of section 5—Town 16-R-7-E. the work was done at the request of the Rock Cemetery association O. H. Ketchum Pres. L. Patrick Sec & B. W. Smith Treas. Three Plats were made two delivered to the association. Dated this 24th Day of August 1926

M. L. Smith County Surveyor

MIS05160700001