

CERTIFICATE OF SURVEY.

STATE OF WISCONSIN, } ss. J. M. C. Smith Surveyor, in and for the County and State aforesaid, do
ADAMS COUNTY.

hereby certify that I have surveyed and subdivided Section 7 Township 16 North of Range 7 East of 4th Principal Meridian, as represented by the courses and distances on the following plat, and annexed field-notes of survey:
Established the center of the section at the point of intersection of straight quarter lines.
Established all quarter-quarter corners upon the section boundary at proportional distances between known section and quarter section corners, according to the original field-notes of the Government survey.
Established all lost corners at proportionate distances between known corners, according to original field-notes of the Government survey.

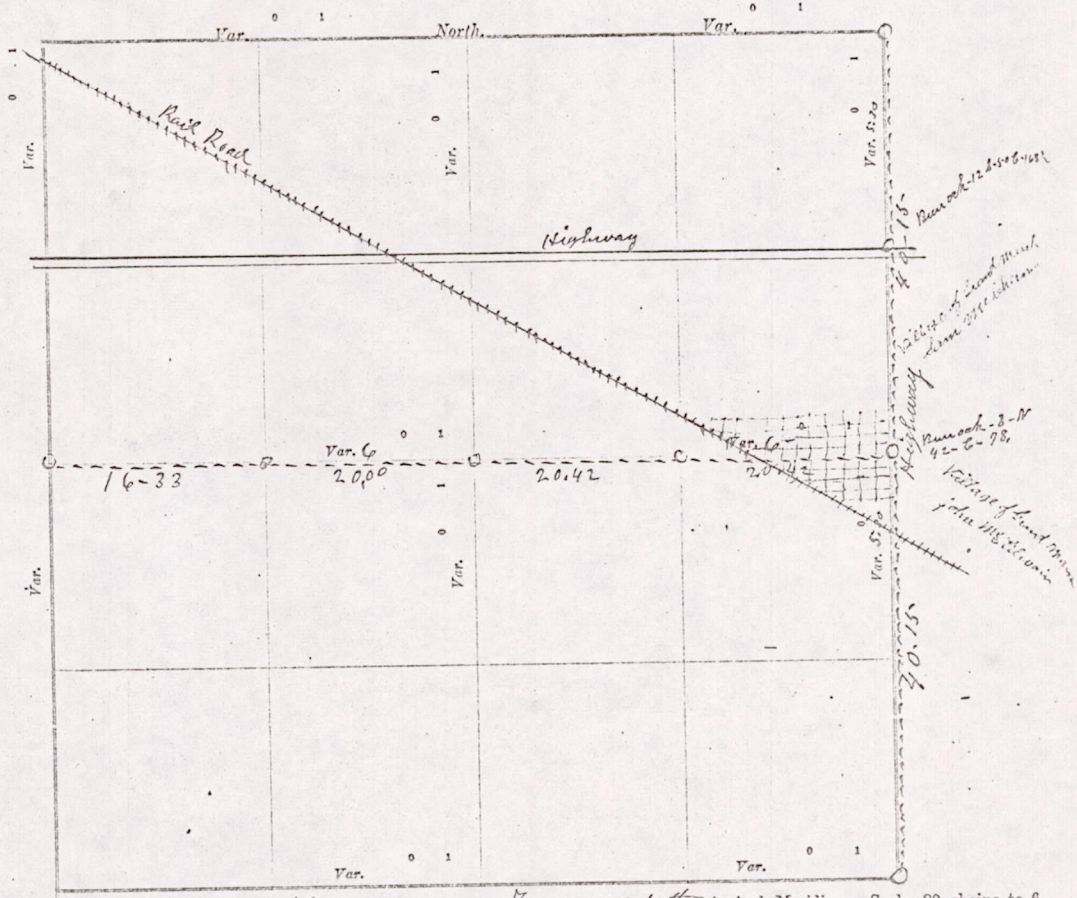

Plat of Section 7, Township 16 North, Range 7 East of 4th Principal Meridian. Scale, 80 chains to 6 inches. The figures in red ink are the lengths of the lines as stated in the field-notes of the Government survey.

Declination of the Magnetic Meridian from the True Meridian _____ East.

Surveyed and subdivided March 21 A. D. 1910, in accordance with the State Laws and Instructions of the Commissioner of the General Land Office, and recorded on pages _____ of Register in the County Surveyor's office.

WITNESS my hand this 21 day of March A. D. 1910.

J. M. C. Smith Surveyor.

The above work was done at the request of Sam McCherney & John McElwain on the 21st day of March 1910. In preparing to lay out the Village of Grand Marsh, and on the 31 day of March did proceed and lay out the Village of Grand Marsh that was on the N E 1/4 of the S E 1/4 of said section on McElwain's land, and on April 1st did lay out the Village of Grand Marsh on S E 1/4 of N E 1/4 of said section on Sam McCherney's land. Plat of which are on file in my office, also with the Register of Deeds.

MIS07160700002

DESCRIPTION of Section, Quarter Section and Quarter quarter Section Corners of Section

Township _____ North, Range _____ East of _____ Principal Meridian.

N. B. - The variation of needle adopted in establishing corners is _____

No.	Government Corners.	Bearing Trees.	In. dia.	Course they bear.	Links Distant.	Bearing Trees.	In. dia.	Course they bear.	Links Distant.
1	N. W. Sec. cor. Identified								
2	N. E. Sec. cor. Identified								
3	S. E. Sec. cor. Identified								
4	S. W. Sec. cor. Identified								
5	N. 1/4 Sec. cor. Identified								
6	E. 1/4 Sec. cor. Identified								
7	S. 1/4 Sec. cor. Identified								
8	W. 1/4 Sec. cor. Identified								
<i>new Run oak 8 N-42-E 78</i>									
No.	SUBDIVISION CORNERS.								
1	Center 1/4 Sec. cor.								
2	North 1/4-1/4s N. W. qr.								
3	East 1/4-1/4s N. W. qr.								
4	South 1/4-1/4s N. W. qr.								
5	West 1/4-1/4s N. W. qr.								
6	Center 1/4-1/4s N. W. qr.								
7	North 1/4-1/4s N. E. qr.								
8	East 1/4-1/4s N. E. qr.								
9	South 1/4-1/4s N. E. qr.								
10	Center 1/4-1/4s N. E. qr.								
11	East 1/4-1/4s S. E. qr.								
12	South 1/4-1/4s S. E. qr.								
13	West 1/4-1/4s S. E. qr.								
14	Center 1/4-1/4s S. E. qr.								
15	South 1/4-1/4s S. W. qr.								
16	West 1/4-1/4s S. W. qr.								
17	Center 1/4-1/4s S. W. qr.								

NAMES OF SWORN ASSISTANTS.

CHAINMEN.	FLAGMEN.	AXMEN.
O. E. Clark G. M. Foster G. Winchester R. B. Atkins A. H. Rook M. H. McShearney		

MINUTES.

starting at the Identified south east corner of section 7 town 16-R-7-E. and Run North at 57° 30' 80 chains & 30 links to the Identified N. E. corner of said section. Established Quarter Post, at 40 chains & 15 links, and made one new bearing as shown above. Then ran west on East & west Quarter line at 6-D-V. to the Identified Quarter Post on west side of the section distance from East to west Quarter Post 77 chains & 15 links distance between each Post are given on Plat. This work was made March 21st 1910. and on March 31-1910 and April 1-1910 did proceed and laid out the Village of Grand March Plat of which are on file in my office also recorded in the office of Register of deeds

M. L. Smith County Surveyor

M1507160700002

Ran oak 8-N
 42-E-78
 Village of Grand March
 John M. Shearney

70.15

80 chains to 6
 and Instructions of
 office.
 Surveyor.
 Remain on the
 March.
 and on April
 section on
 also with