

CERTIFICATE OF SURVEY.

STATE OF WISCONSIN,
ADAMS COUNTY.

ss. I. M. L. Smith Surveyor, in and for the County and State aforesaid, do

herely certify that I have surveyed and subdivided Section 7 Township 16 North of Range 7 East of 4th Principal Meridian, as represented by the courses and distances on the following plat, and annexed field-notes of survey:

Established the center of the section at the point of intersection of *straight* quarter lines.

Established all quarter-quarter corners upon the section boundary at proportional distances between known section and quarter section corners, according to the original field-notes of the Government survey.

Established all lost corners at proportionate distances between known corners, according to original field-notes of the Government survey:

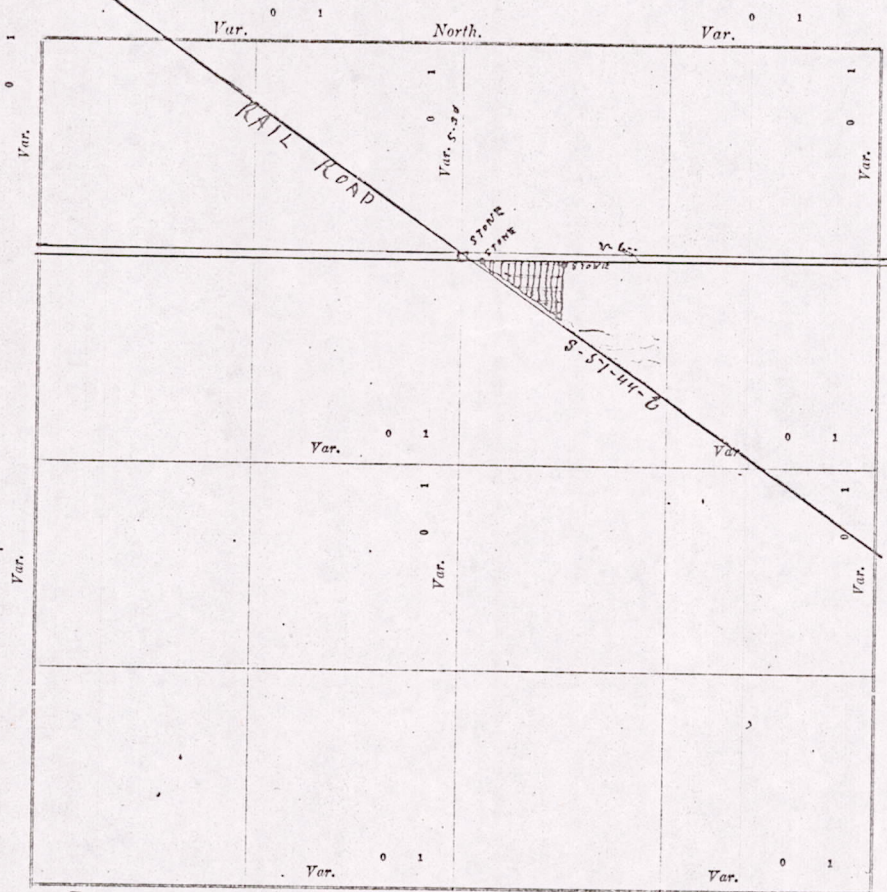

Plat of Section 7, Township 16 North, Range 7 East of 4th Principal Meridian. Scale, 80 chains to 0 inches. The figures in red ink are the lengths of the lines as stated in the field-notes of the Government survey.

Declination of the Magnetic Meridian from the True Meridian _____ East.

Surveyed and subdivided _____ A. D. 19____, in accordance with the State Laws and Instructions of the Commissioner of the General Land Office, and recorded on pages _____ of Register in the County Surveyor's office.

WITNESS my hand this 12 day of April A. D. 1911.

M. L. Smith Adams County Surveyor.

The above work was done at the request of & for Samuel M. Chawey, in laying out the Village of North Grand Marsh, a Plat of which is on file in my office

M1507160700005

DESCRIPTION of Section, Quarter Section and Quarter quarter Section Corners of Section
Township _____ North, Range _____ East of _____ Principal Meridian.

N. B.—The variation of needle adopted in establishing corners is _____

oresaid, do
4th

ter section
t survey:

Government Corners.		Bearing Trees.	In. dia.	Courses they bear.	Links Distant.	Bearing Trees.	In. dia.	Courses they bear.	Links Distant.
No. 1	N. W. Sec. cor. Identified.								
2	N. E. Sec. cor. Identified								
3	S. E. Sec. cor. Identified								
4	S. W. Sec. cor. Identified								
5	N. $\frac{1}{4}$ Sec. cor. Identified								
6	E. $\frac{1}{4}$ Sec. cor. Identified								
7	S. $\frac{1}{4}$ Sec. cor. Identified								
8	W. $\frac{1}{4}$ Sec. cor. Identified								
SUBDIVISION CORNERS.									
1	Center $\frac{1}{4}$ Sec. cor.								
2	North $\frac{1}{4}$ - $\frac{1}{4}$ s N. W. qr.								
3	East $\frac{1}{4}$ - $\frac{1}{4}$ s N. W. qr.								
4	South $\frac{1}{4}$ - $\frac{1}{4}$ s N. W. qr.								
5	West $\frac{1}{4}$ - $\frac{1}{4}$ s N. W. qr.								
6	Center $\frac{1}{4}$ - $\frac{1}{4}$ s N. W. qr.								
7	North $\frac{1}{4}$ - $\frac{1}{4}$ s N. E. qr.								
8	East $\frac{1}{4}$ - $\frac{1}{4}$ s N. E. qr.								
9	South $\frac{1}{4}$ - $\frac{1}{4}$ s N. E. qr.								
10	Center $\frac{1}{4}$ - $\frac{1}{4}$ s N. E. qr.								
11	East $\frac{1}{4}$ - $\frac{1}{4}$ s S. E. qr.								
12	South $\frac{1}{4}$ - $\frac{1}{4}$ s S. E. qr.								
13	West $\frac{1}{4}$ - $\frac{1}{4}$ s S. E. qr.								
14	Center $\frac{1}{4}$ - $\frac{1}{4}$ s S. E. qr.								
15	South $\frac{1}{4}$ - $\frac{1}{4}$ s S. W. qr.								
16	West $\frac{1}{4}$ - $\frac{1}{4}$ s S. W. qr.								
17	Center $\frac{1}{4}$ - $\frac{1}{4}$ s S. W. qr.								

NAMES OF SWORN ASSISTANTS.

CHAINMEN.	FLAGMEN.	AXMEN.
<i>Estlin Babcock</i> <i>A. N. Rook</i>		

80 chains to 6

nd Instructions of
lice.

Surveyor.

ay, in laying
is an fill

MINUTES.

MMS.07160700005