

# CERTIFICATE OF SURVEY.

STATE OF WISCONSIN, } ss. Hugh C Hurley Surveyor, in and for the County and State aforesaid, do  
ADAMS COUNTY.

hereby certify that I have surveyed and subdivided Section 20 Township 16 North of Range 7 East of  
Principal Meridian, as represented by the courses and distances on the following plat, and annexed field-notes of survey:

- Established the center of the section at the point of intersection of straight quarter lines.
- Established all quarter-quarter corners upon the section boundary at proportional distances between known section and quarter section corners, according to the original field-notes of the Government survey.
- Established all lost corners at proportionate distances between known corners, according to original field-notes of the Government survey:

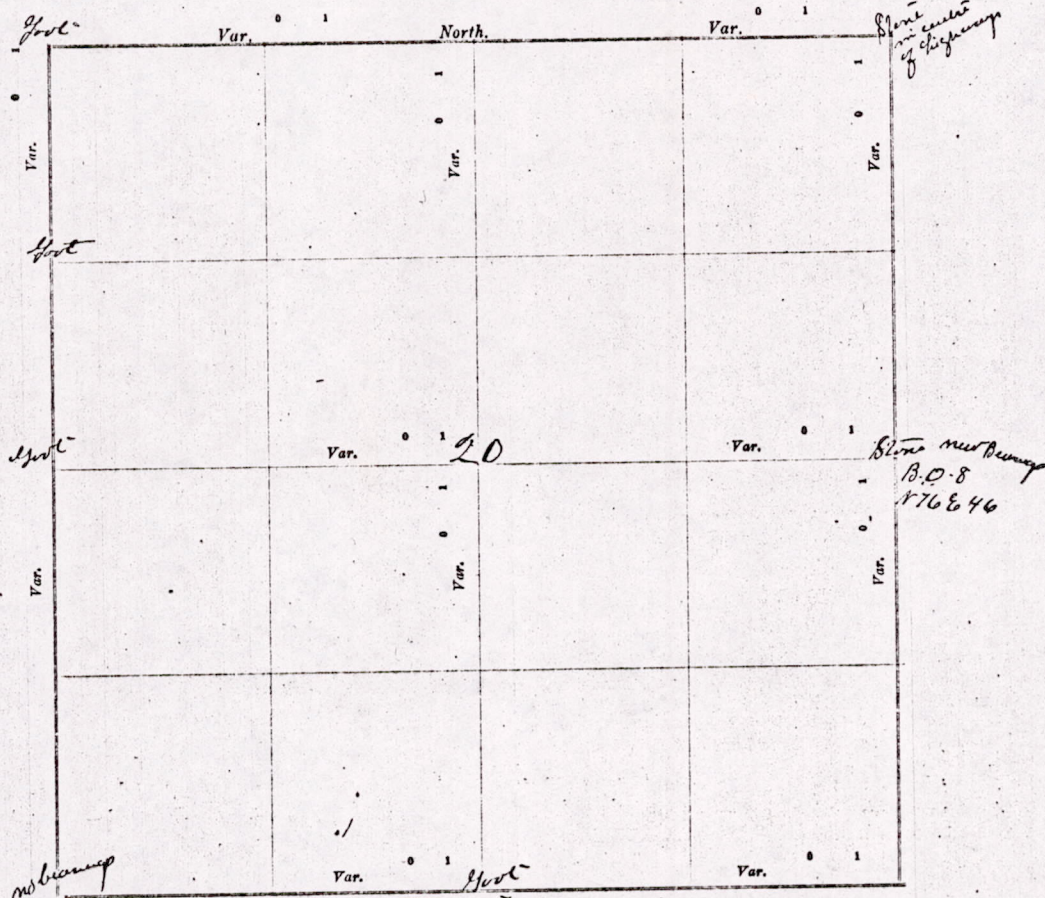

Plat of Section 20, Township 16 North, Range 7 East of 4 Principal Meridian. Scale, 80 chains to 6 inches. The figures in red ink are the lengths of the lines as stated in the field-notes of the Government survey.

Declination of the Magnetic Meridian from the True Meridian \_\_\_\_\_ East.

Surveyed and subdivided March 27 A. D. 1903, in accordance with the State Laws and Instructions of

the Commissioner of the General Land Office, and recorded on pages \_\_\_\_\_ of Register in the County Surveyor's office.

WITNESS my hand this 27 day of March A. D. 1903.

Hugh C Hurley Surveyor.

*Old Knutson  
L. Ripley*

Mis20.160700001

DESCR  
TACU  
N. B. Tho

No.	
1	N. W.
2	N. E.
3	S. E.
4	S. W.
5	N. W.
6	N. E.
7	S. E.
8	S. W.
No. SUBD	
1	Cent
2	North
3	East
4	South
5	West
6	Cent
7	North
8	East
9	South
10	Cent
11	East
12	South
13	West
14	Cent
15	South
16	West
17	Cent

DESCRIPTION of Section, Quarter Section and Quarter quarter Section Corners of Section

Township \_\_\_\_\_ North, Range \_\_\_\_\_ East of \_\_\_\_\_ Principal Meridian.

N. B. - The variation of needle adopted in establishing corners is \_\_\_\_\_

foresaid, do

ter section

t survey:

new  
survey

new bearing  
0.8  
6846

80 chains to 6

Instructions of

Surveyor.

No.	Government Corners.	Bearing Trees.	In. dia.	Courses they bear.	Links Distant.	Bearing Trees.	In. dia.	Courses they bear.	Links Distant.
1	N. W. Sec. cor. Indentified	no bearing	Put in stone in center of both highways						
2	N. E. Sec. cor. Indentified	divided distance between 4x stakes							
3	S. E. Sec. cor. Indentified	no bearings near put in stone							
4	S. W. Sec. cor. Indentified	" " " "							
5	N. 1/4 Sec. cor. Indentified	Government							
6	E. 1/4 Sec. cor. Indentified	Put in stone B.O. 776 & 46.							
7	S. 1/4 Sec. cor. Indentified								
8	W. 1/4 Sec. cor. Indentified								
<b>No. SUBDIVISION CORNERS.</b>									
1	Center 1/4 Sec. cor.								
2	North 1/4-1/4s N. W. qr.								
3	East 1/4-1/4s N. W. qr.								
4	South 1/4-1/4s N. W. qr.								
5	West 1/4-1/4s N. W. qr.								
6	Center 1/4-1/4s N. W. qr.								
7	North 1/4-1/4s N. E. qr.								
8	East 1/4-1/4s N. E. qr.								
9	South 1/4-1/4s N. E. qr.								
10	Center 1/4-1/4s N. E. qr.								
11	East 1/4-1/4s S. E. qr.								
12	South 1/4-1/4s S. E. qr.								
13	West 1/4-1/4s S. E. qr.								
14	Center 1/4-1/4s S. E. qr.								
15	South 1/4-1/4s S. W. qr.								
16	West 1/4-1/4s S. W. qr.								
17	Center 1/4-1/4s S. W. qr.								

NAMES OF SWORN ASSISTANTS.

CHAINMEN.	FLAGMEN.	AXMEN.
Chas Knutson L. Ripley	Charley Elliott	A. Miller Otto Padwell

MINUTES.

M1520160700001