

DESCRIPTION

Lot 1, Certified Survey Map, No. 4345 located in the Southeast Quarter of the Northwest Quarter of Section 14, Town 16 North, Range 7 East, Town of New Chester, Adams County, Wisconsin.

SURVEYOR'S CERTIFICATE

I, **JAMES R. GROTHMAN**, Registered Land Surveyor in the State of Wisconsin, **DO HEREBY CERTIFY** that I have inspected the above described property and that I have mapped the property according to the official records and that I have mapped the locations of all visible structures, the dimensions of all principal buildings, roadways, apparent easements and visible encroachments, if any. This mortgage inspection has been prepared in accordance with the requirements of **Michael D. & Kathleen V. KLAWITTER** and under the agreement between **GROTHMAN & ASSOCIATES, S.C.** and **Michael D. & Kathleen V. KLAWITTER** which provides that this mortgage inspection complies with all of the requirements of Section AE 7.01 Wisconsin Administrative Code. Therefore all of the requirements of Section AE 7.01 have been complied with. The mortgage inspection is made for the exclusive use of **Michael D. & Kathleen V. KLAWITTER** and its insurees and for the period of one year from date hereof and as to them I certify the accuracy of said mortgage inspection as shown.

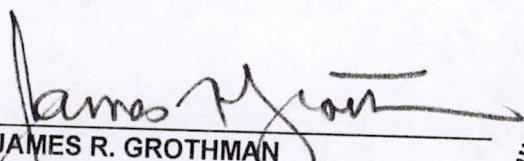

JAMES R. GROTHMAN
Registered Land Surveyor, No. 1321
Dated: September 3, 2002

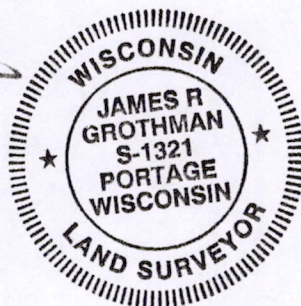

POS14160721003