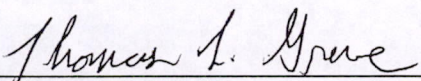

SURVEYOR'S CERTIFICATE

I, **THOMAS L. GREVE**, Registered Land Surveyor, do hereby certify that by the order of **Paul Jankowski**, I have surveyed, monumented, and mapped a part of the Northeast Quarter of the Northeast Quarter and the Northwest Quarter of the Northeast Quarter of Section 21, Town 16 North, Range 7 East, Town of New Chester, Adams County, Wisconsin, described as follows:

Commencing at the northeast corner of said Section 21;
thence South 87°50'34" West along the north line of the Northeast Quarter of said Section 21, 1,239.00 feet to the northeast corner of lands described and recorded in Volume 3692 , page 49 and the point of beginning;
thence South 02°09'26" East along the east line of lands described and recorded in Volume 3692, page 49, 208.71 feet;
thence South 87°50'34" West along the south line of lands described and recorded in Volume 3692, page 49, 208.71 feet;
thence North 02°09'26" West along the west line of lands described and recorded in Volume 3692, page 49, 208.71 feet to a point in the north line of the Northeast Quarter of said Section 21;
thence North 87°50'34" East along the north line of the Northeast Quarter of said Section 21 and the north line of lands described and recorded in Volume 3692, page 49, 208.71 feet to the point of beginning.
Containing 43,560 square feet, (1.00 acres), more or less. And being subject to Elk Avenue along the northerly 33 feet thereof and servitudes and easements of use or record if any.

I DO FURTHER CERTIFY that this surveying and mapping is in compliance with Wisconsin Administrative Code AE 7 and that it is a true and correct representation of the boundaries of the land surveyed to the best of my knowledge and belief.

THOMAS L. GREVE
Registered Land Surveyor, No. 2226
Dated: April 25, 2005
File No.: 405-235

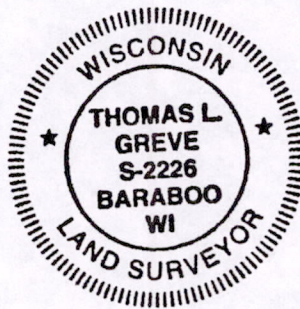

POS 21160711001

COPY