

PLAT OF SURVEY MAP

LOTS 7 OF CERTIFIED SURVEY MAP NUMBER 1165, LOCATED IN THE NE1/4-NE1/4 OF SECTION 22, T16N-R7E, TOWN OF NEW CHESTER, ADAMS COUNTY, WISCONSIN

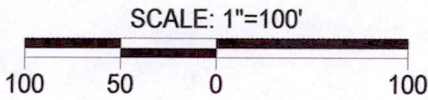
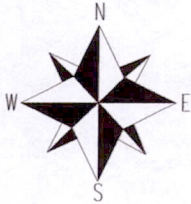

BASIS OF BEARING

BEARINGS ARE BASED ON THE EAST LINE OF THE NORTHEAST 1/4 OF SECTION 22. ASSUMED TO BEAR S00°23'06"W.

LEGEND

- FOUND 1" IRON PIPE
- SET 1 1/4"x18" IRON ROD 4.17 LBS/FT
- ⊕ HARRISON CAST IRON MONUMENT

SURVEYOR'S CERTIFICATE:

I, Kelly D. Callaway, Registered Land Surveyor, do hereby certify: That I have surveyed and mapped those lands located in the Northeast 1/4 of the Northeast 1/4 of Section 22, T16N-R7E, Town of New Chester, Adams County, Wisconsin. Described as Follows:

All of Lots 7 of Certified Survey Map Number 1165

Containing 3.24 Acres of land And being subject to any restrictions, easements, right-of-ways and Covenants of record.

That said map is a true and correct representation of the exterior boundaries of the lands surveyed. That I have made such survey under the direction of Richard Huss. That I have complied with the provisions of Chapter A-E7 of the Wisconsin Administrative code.

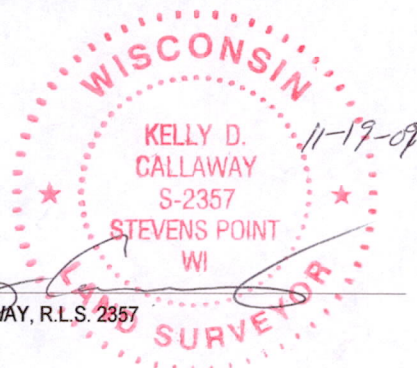

KELLY D. CALLAWAY, R.L.S. 2357

S 89°57'57" E 518.16'

NE CORNER SECTION 22

LOT 6 CSM # 1165

LOT 5 CSM # 1165

S 89°59'08" E 317.58'
275.58'

S 00°23'06" W 445.00'

S 00°57'50" W 445.26'

S 00°23'05" W 445.21'

C.T.H. "G"

Lot 7 CSM 1165
3.24 acres
141152.70 sq ft
Lot 7 (Exc. R/W)
2.79 acres
121452.55 sq ft

LOT 8 CSM # 1165

N 89°55'40" W 316.69'

270.19'

46.50'

33' 33'

42.00'

66'

N 00°16'14" E 444.93'

CALLAWAY LAND SURVEYING

340 2ND ST. NORTH
STEVENS POINT, WI 54481
715-345-6962 MOBILE: 715-347-LAND
EMAIL: hntfsh@charter.net

CLIENT: RICHARD HUSS

JOB #: 09-104

SHEET: 1 of 1

Pos 22160711002