

SECTION SUMMARY AND INDEX

$\frac{23}{\text{SECTION}}$ $\frac{16}{\text{TOWN}}$ $\frac{7}{\text{RANGE}}$

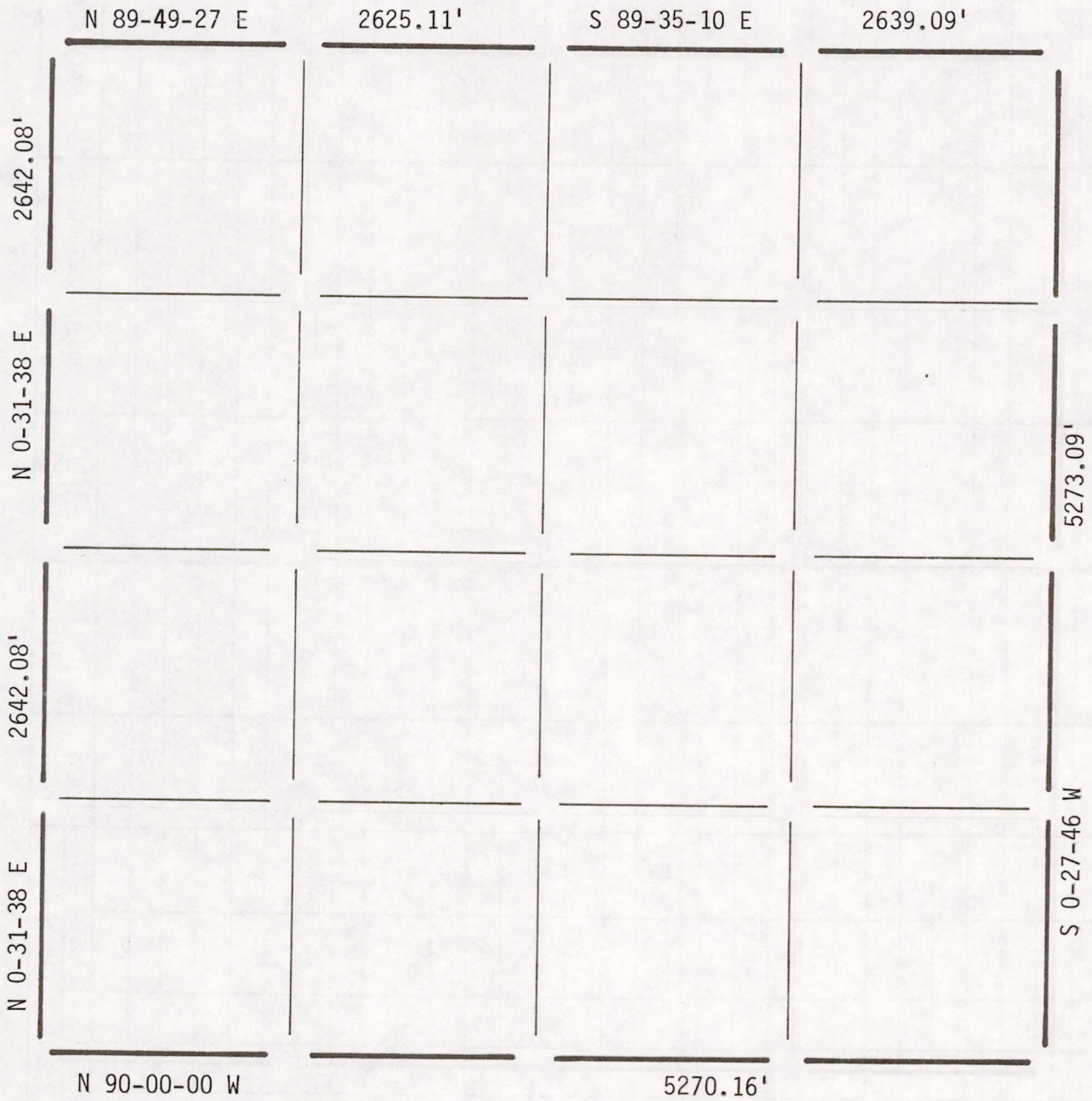

LEGEND

- HARRISON CAST IRON MONUMENT
- STONE OR CONCRETE MONUMENT
- OTHER _____

Sec 23160700001

Kiedrowski Engineering, Inc.
 4340 80th Street South (Kellner)
 Wisconsin Rapids, WI 54494

4/9/84

Kiedrowski Engineering, Inc.

PHONE 715-421-6444

IF NO ANSWER CALL
715-325-5119

4340 - 80th Street South (Kellner)
Wisconsin Rapids, WI 54494

CIVIL ENGINEERS
LAND SURVEYORS
REAL ESTATE
DEVELOPERS
BROKERS

★ ★ ★ ★ ★ TOTAL REAL ESTATE DEVELOPMENT ★ ★ ★ ★ ★

Anthony Kiedrowski, President
Professional Engineer
Registered Land Surveyor
Certified Soil Tester
Real Estate Broker

Plover Survey Branch
2105 Evergreen Court
715-341-6789

April 9, 1984

D.M. Green & Assoc., Inc.
ATTN: Dennis M. Green
Rural Route 1
Pardeeville, WI 53954

Dear Dennis:

Back in 1977, I discussed with you the difference that we had in running out Section 23, T16N, R7E, Town of New Chester, Adams County. If you recall at the time, we had excavated with the backhoe and found a stone at the N $\frac{1}{4}$ corner and an old 2" pipe at the NE corner.

We are now surveying the NE $\frac{1}{4}$ of the NE $\frac{1}{4}$ of the Section and as you will see from the map enclosed, your survey encroaches 10 to 18' onto the NE $\frac{1}{4}$ of the NE $\frac{1}{4}$. You will also note on the enclosed Section Summary that we are on the same bearing base as you are, that is the South line of the Section is assigned a bearing of WEST. Although we get the same distance as you show on your survey map between your two monuments, (1281.57'), the bearing is considerably different than what you indicate.

Please let me know what action you intend to take in this matter.

Sincerely,

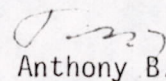
Anthony B. Kiedrowski

ABK/sjs

c.c. Gordon Whitemarsh
Adams County Surveyor
Dale Jerdee



Sec 23160700001

D. M. GREEN & ASSOCIATES, Inc.

Dennis M. Green, President

111 South Main Street
PARDEEVILLE, WI 53054



Engineering and Surveying

Phone 608-420-2085

*TO
C.H.*

April 25, 1984

Kiedrowski Engineering Inc.
Attn: Anthony B. Kiedrowski
4340 80th St. South (Kellner)
Wisconsin Rapids, Wi. 54494

Dear Anthony

Thank you for notifying me about the difference between our surveys in Section 23, T16N, R7E.

I believe that our Section Line fell on the centerline of Elk Avenue. It appears that the NE corner and the Section Line that you have drawn also falls on the center of Elk Avenue.

When we did this survey, we did traverse to Section corners on the South line of the Section and completely around the Section.

I can't believe there is such a difference North and South. I must go out to this area and remeasure the distances to the survey irons again and recheck our old calculations.

I will let you know what we find out from the traversing and calculations.

Sincerely,

Dennis M. Green

c.c. Gordon Whitemarsh
Adams County Surveyor

Sec 23160700001