

CERTIFICATE OF SURVEY.

STATE OF WISCONSIN, }
ADAMS COUNTY. }

M. L. Smith

Surveyor, in and for the County and State of Wisconsin

heroby certify that I have surveyed and subdivided Section 1 Township 17 North of Range 5 East of 4th Principal Meridian, as represented by the courses and distances on the following plat, and annexed field-notes of survey:

Established the center of the section at the point of intersection of *straight* quarter lines.

Established all quarter-quarter corners upon the section boundry at proportional distances between known section and quarter section corners, according to the original field-notes of the Government survey.

Established all lost corners at proportionate distances between known corners, according to original field-notes of the Government survey.

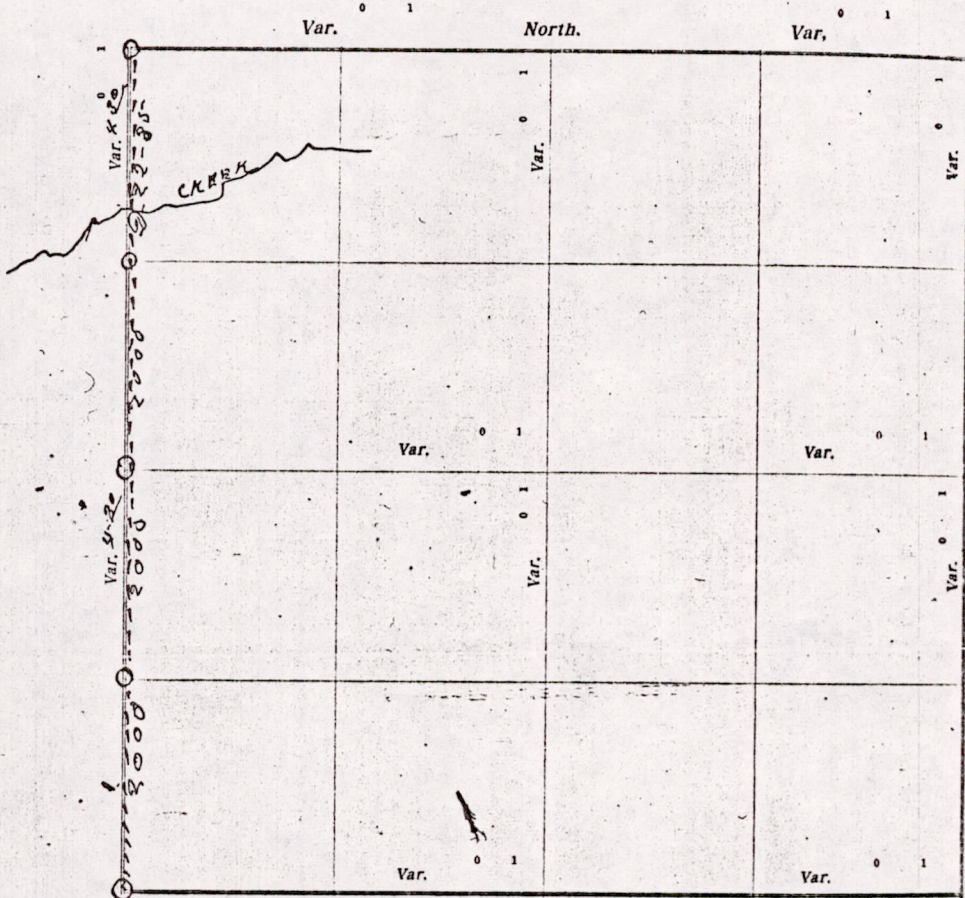

Plat of Section one, Township 17 North, Range 5 East of 4th Principal Meridian. Scale, 50 chains to 2 inches. The figures in red ink are the lengths of the lines as stated in the field-notes of the Government survey.

Declination of the Magnetic Meridian from the True Meridian _____ East.

Surveyed and subdivided 12 - Day of April A. D. 1921, in accordance with the State Laws and Instructions of

the Commissioner of the General Land Office, and recorded on pages _____ of Register in the County Surveyor's office.

WITNESS my hand this 13th day of April A. D. 1921.

M. L. Smith County Surveyor

The above work was done at the request of John Lewis

MISO 117050004

DESCRIPTION of Section, Quarter Section and Quarter-quarter Section Corners of Section 89
 Township _____ North, Range _____ East of _____ Principal Meridian.

89

N. B.—The variation of needle adopted in establishing corners is _____

No.	Government Corners	Bearing Trees	In. dia.	Courses they bear	Links Distant	Bearing Trees	In. dia.	Courses they bear	Links Distant
1	N. W. Sec. cor. Identified								
2	N. E. Sec. cor. Identified								
3	S. E. Sec. cor. Identified								
4	S. W. Sec. cor. Identified								
5	N. $\frac{1}{4}$ Sec. cor. Identified								
6	E. $\frac{1}{4}$ Sec. cor. Identified								
7	S. $\frac{1}{4}$ Sec. cor. Identified								
8	W. $\frac{1}{4}$ Sec. cor. Identified								
<i>New Elm 14 N-13$\frac{1}{2}$E 205-225</i>									
No. SUBDIVISION CORNERS.									
1	Center $\frac{1}{4}$ Sec. cor.								
2	North $\frac{1}{4}$ - $\frac{1}{4}$ s N. W. qr.								
3	East $\frac{1}{4}$ - $\frac{1}{4}$ s N. W. qr.								
4	South $\frac{1}{4}$ - $\frac{1}{4}$ s N. W. qr.								
5	West $\frac{1}{4}$ - $\frac{1}{4}$ s N. W. qr.								
6	Center $\frac{1}{4}$ - $\frac{1}{4}$ s N. W. qr.								
7	North $\frac{1}{4}$ - $\frac{1}{4}$ s N. E. qr.								
8	East $\frac{1}{4}$ - $\frac{1}{4}$ s N. E. qr.								
9	South $\frac{1}{4}$ - $\frac{1}{4}$ s N. E. qr.								
10	Center $\frac{1}{4}$ - $\frac{1}{4}$ s N. E. qr.								
11	East $\frac{1}{4}$ - $\frac{1}{4}$ s S. E. qr.								
12	South $\frac{1}{4}$ - $\frac{1}{4}$ s S. E. qr.								
13	West $\frac{1}{4}$ - $\frac{1}{4}$ s S. E. qr.								
14	Center $\frac{1}{4}$ - $\frac{1}{4}$ s S. E. qr.								
15	South $\frac{1}{4}$ - $\frac{1}{4}$ s S. W. qr.								
16	West $\frac{1}{4}$ - $\frac{1}{4}$ s S. W. qr.								
17	Center $\frac{1}{4}$ - $\frac{1}{4}$ s S. W. qr.								

NAMES OF SWORN ASSISTANTS.

CHAINMEN	FLAGMEN	AXMEN
<i>John Lorch</i> <i>Harry Dittbender</i>		

MINUTES.

Commencing at the Northwest corner of section 1 Town 17 R. 5 E
 (stone identified at this corner) and run south on the section line
 at $\frac{30}{100}$ D. V. 22 chains & 85 links and set post for fractional 40
 thence south on said section line to the identified south
 west corner of said section one, made correction on this line
 and made one new bearing for quarter post on west side of said
 section one.

W. L. Smith county surveyor

M1501176500004