

CERTIFICATE OF SURVEY.

STATE OF WISCONSIN, }
ADAMS COUNTY. }

ss. M. L. Smith

Surveyor, in and for the County and State aforesaid, do

hereby certify that I have surveyed and subdivided Section 12 Township 17 North of Range 5 East of 4th Principal Meridian, as represented by the courses and distances on the following plat, and annexed field-notes of survey:

Established the center of the section at the point of intersection of straight quarter lines.

Established all quarter-quarter corners upon the section boundary at proportional distances between known section and quarter section corners, according to the original field-notes of the Government survey.

Established all lost corners at proportionate distances between known corners, according to original field-notes of the Government survey:

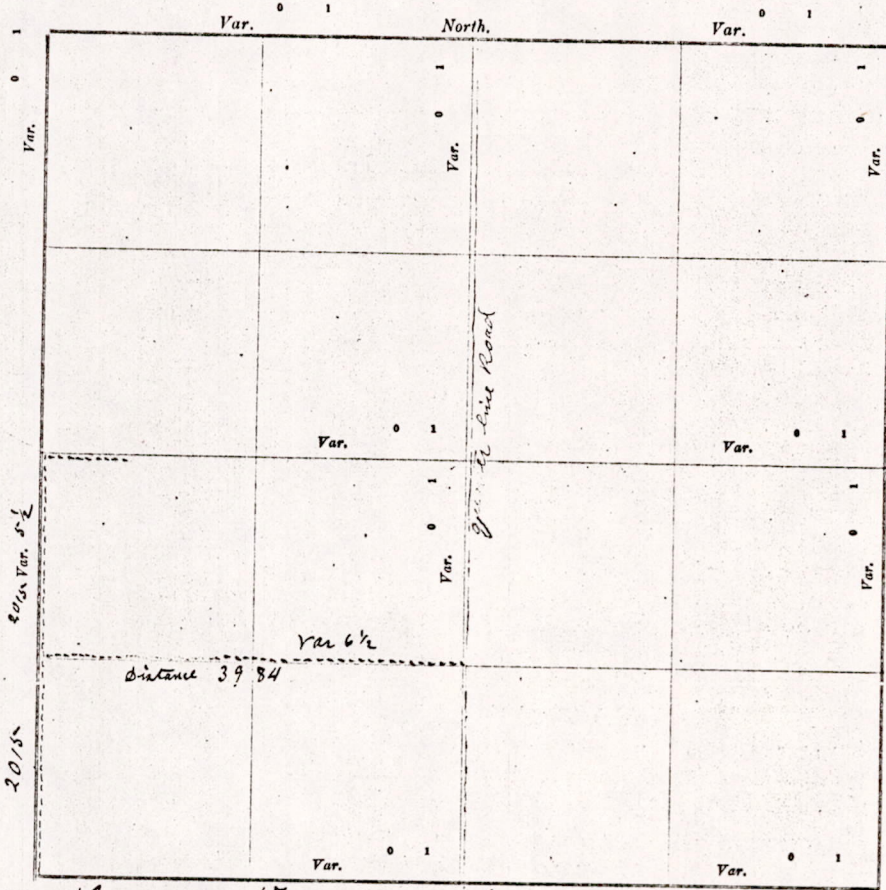

Plat of Section 12, Township 17 North, Range 5 East of 4th Principal Meridian. Scale, 80 chains to 6 inches. The figures in red ink are the lengths of the lines as stated in the field-notes of the Government survey.

Declination of the Magnetic Meridian from the True Meridian _____ East.

Surveyed and subdivided August 10 A. D. 1909, in accordance with the State Laws and Instructions of

the Commissioner of the General Land Office, and recorded on pages _____ of Register in the County Surveyor's office.

WITNESS my hand this 10 day of August A. D. 1909.

M. L. Smith Surveyor.

The above work was done for A. C. Lewis & J. W. Duinell

MIS 12170500001

DESCR

Town

N. H. The

No. 1 N. W.

2 N. E.

3 S. E.

4 S. W.

5 N. 1/4

6 E. 1/4

7 S. 1/4

8 W. 1/4

No. SUBDIV

1 Center

2 North

3 East 1/4

4 South 1/4

5 West 1/4

6 Center

7 North

8 East 1/4

9 South 1/4

10 Center

11 East 1/4

12 South 1/4

13 West 1/4

14 Center

15 South 1/4

16 West 1/4

17 Center

J. C. Lewis
J. W. Duinell

Beginning a
corner when
the quarter 2
line set for
39 chains & 8
North East corner

DESCRIPTION of Section, Quarter Section and Quarter quarter Section Corners of Section

Township _____ North, Range _____ East of _____ Principal Meridian.

N. B. - The variation of needle adopted in establishing corners is _____

| No. | Government Corners. | Bearing Trees. | In. dia. | Courses they bear. | Links Distant. | Bearing Trees. | In. dia. | Courses they bear. | Links Distant. |
|---------------------------------|-----------------------------|----------------|----------|--------------------|----------------|----------------|----------|--------------------|----------------|
| 1 | N. W. Sec. cor. Identified | | | | | | | | |
| 2 | N. E. Sec. cor. Identified | | | | | | | | |
| 3 | S. E. Sec. cor. Identified | | | | | | | | |
| 4 | S. W. Sec. cor. Identified | | | | | | | | |
| 5 | N. 1/4 Sec. cor. Identified | | | | | | | | |
| 6 | E. 1/4 Sec. cor. Identified | | | | | | | | |
| 7 | S. 1/4 Sec. cor. Identified | | | | | | | | |
| 8 | W. 1/4 Sec. cor. Identified | | | | | | | | |
| No. SUBDIVISION CORNERS. | | | | | | | | | |
| 1 | Center 1/4 Sec. cor. | | | | | | | | |
| 2 | North 1/4-1/4s N. W. qr. | | | | | | | | |
| 3 | East 1/4-1/4s N. W. qr. | | | | | | | | |
| 4 | South 1/4-1/4s N. W. qr. | | | | | | | | |
| 5 | West 1/4-1/4s N. W. qr. | | | | | | | | |
| 6 | Center 1/4-1/4s N. W. qr. | | | | | | | | |
| 7 | North 1/4-1/4s N. E. qr. | | | | | | | | |
| 8 | East 1/4-1/4s N. E. qr. | | | | | | | | |
| 9 | South 1/4-1/4s N. E. qr. | | | | | | | | |
| 10 | Center 1/4-1/4s N. E. qr. | | | | | | | | |
| 11 | East 1/4-1/4s S. E. qr. | | | | | | | | |
| 12 | South 1/4-1/4s S. E. qr. | | | | | | | | |
| 13 | West 1/4-1/4s S. E. qr. | | | | | | | | |
| 14 | Center 1/4-1/4s S. E. qr. | | | | | | | | |
| 15 | South 1/4-1/4s S. W. qr. | | | | | | | | |
| 16 | West 1/4-1/4s S. W. qr. | | | | | | | | |
| 17 | Center 1/4-1/4s S. W. qr. | | | | | | | | |

NAMES OF SWORN ASSISTANTS.

| CHAINMEN. | FLAGMEN. | AXMEN. |
|------------------------------|----------|--------|
| S. C. Lewis J. W. Linnell | | |
| | | |
| | | |

MINUTES.

Beginning at the south west corner of section 12 - Town 17 - R - 5 - E corner identified and ran North at 5 1/2 - D - V, 40 chains & 30 links to the quarter post on west side of section 12, quarter post identified. Then set post 20 chains & 15 links south of quarter post and ran East at 6 1/2 - D - V 39 chains & 84 links to the quarter line running North & South, to the post at the North East corner of the South half of the South west quarter of 12, said post being correct.

M. C. Smith Co Surveyor

M1512176500001