

CERTIFICATE OF SURVEY.

STATE OF WISCONSIN,
ADAMS COUNTY.

ss. 1. M. L. Smith

Surveyor, in and for the County and State aforesaid, do

hereby certify that I have surveyed and subdivided Section 29 Township 17 North of Range 5 East of 11 1/2 Principal Meridian, as represented by the courses and distances on the following plat, and annexed field-notes of survey:

Established the center of the section at the point of intersection of straight quarter lines.

Established all quarter-quarter corners upon the section boundary at proportional distances between known section and quarter section corners, according to the original field-notes of the Government survey.

Established all lost corners at proportionate distances between known corners, according to original field-notes of the Government survey:

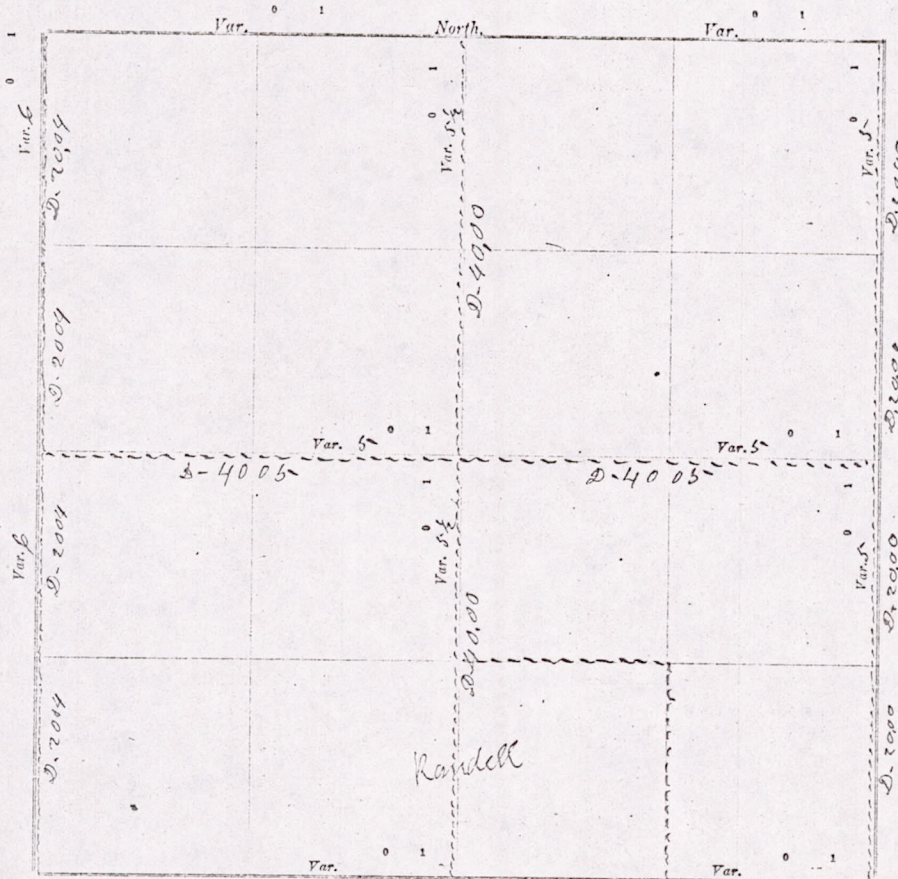

Plat of Section 29 Township 17 North, Range 5 East of 11 1/2 Principal Meridian. Scale, 80 chains to 6 inches. The figures in red ink are the lengths of the lines as stated in the field-notes of the Government survey.

Declination of the Magnetic Meridian from the True Meridian _____ East.

Surveyed and subdivided the 7th day of November A. D. 1907, in accordance with the State Laws and Instructions of the Commissioner of the General Land Office, and recorded on pages _____ of Register in the County Surveyor's office.

WITNESS my hand this 18 day of November A. D. 1907.

M. L. Smith Surveyor.

The above work was done for D. R. Miller

Mis 2917050001

DESCRIPTION of Section, Quarter Section and Quarter quarter Section Corners of Section

Township _____ North, Range _____ East of _____ Principal Meridian.

N. B. - The variation of needle adopted in establishing corners is _____

No.	Government Corners.	Bearing Trees.	In. dia.	Courses they bear.	Links Distant.	Bearing Trees.	In. dia.	Courses they bear.	Links Distant.
1	N. W. Sec. cor. Identified	new	Blk oak	16 N-74-E	45 1/2				
2	N. E. Sec. cor. Identified								
3	S. E. Sec. cor. Identified								
4	S. W. Sec. cor. Identified	new	Elm.	12 N-89-W	217 1/2				
5	N. 1/4 Sec. cor. Identified								
6	E. 1/4 Sec. cor. Identified	new	Bum oak	10 S-21-W	74 1/2	Pine	10 N-53-W	71	
7	S. 1/4 Sec. cor. Identified								
8	W. 1/4 Sec. cor. Identified	new	Pine	10 S-78 1/2-W	148 1/2	Pine	12 N-81 1/2-W	145 1/2	
SUBDIVISION CORNERS.									
1	Center 1/4 Sec. cor.								
2	North 1/4-1/4s N. W. qr.								
3	East 1/4-1/4s N. W. qr.								
4	South 1/4-1/4s N. W. qr.								
5	West 1/4-1/4s N. W. qr.								
6	Center 1/4-1/4s N. W. qr.								
7	North 1/4-1/4s N. E. qr.								
8	East 1/4-1/4s N. E. qr.								
9	South 1/4-1/4s N. E. qr.								
10	Center 1/4-1/4s N. E. qr.								
11	East 1/4-1/4s S. E. qr.								
12	South 1/4-1/4s S. E. qr.								
13	West 1/4-1/4s S. E. qr.								
14	Center 1/4-1/4s S. E. qr.								
15	South 1/4-1/4s S. W. qr.								
16	West 1/4-1/4s S. W. qr.								
17	Center 1/4-1/4s S. W. qr.								

NAMES OF SWORN ASSISTANTS.

CHAINMEN.	FLAGMEN.	AXMEN.
Fred Born Gene Moshure		

MINUTES.

Beginning at the established N.W. corner of section 29 T-17-R-5-E, made me new Bearing & Run South at 6-D-V-140 chains & 8 links ~~to~~ to the established 1/4 Post on west side of section, made 2 new Bearings, then south same 45 chains & 8 links to the ~~corner~~ south west corner of the section, made one new Bearing then started a Post at the south east corner of said section & ran north 80 chains to the North east corner of the section set out stone, established 1/4 Post on East side of section made 2 new Bearings, then started at the established 1/4 Post on West side of section & Ran East at 5-D-V-30 chains & 10 links to the established 1/4 Post on East side of section, then started at the identified 1/4 Post on south side of section & Ran North at 6-D-V-20 chains to the identified 1/4 Post on north side of the section and made all corrections

M. L. Smith Co Surveyor

MLS 29170500001