

SURVEY OF LOTS 11-12-13, BLOCK 20  
2ND ADD. TO THE DELLWOOD

F.B. = 384 ADAMS  
PAGE 67  
PPOJ. NO 4212

SENE

Survey of Lots 11, 12, & 13, Block 20, in the Second Addition to the Dellwood, a subdivision located in Section 18, T17N, R5E, Town of Quincy, Adams County, Wisconsin.

As Given By  
Mid-State Associates  
Baraboo, Wisconsin  
March, 1971

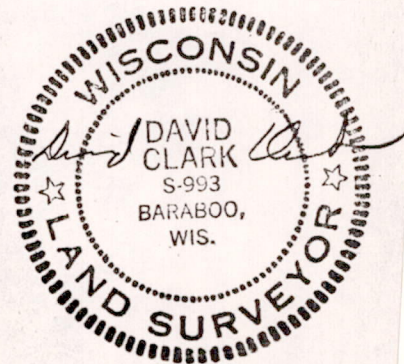

POS 18170511012