

WM 1/4 CORNER
SECTION 32
T.17N., R.5E.
(HARRISON MON., FD.) #1711

LOT 1
C.S.M. No. 4127
VOL. 19, PG. 159
DOC. No. 399467

LOT 1
C.S.M. No. 2407
VOL. 9, PG. 46-47
DOC. No. 321355

BEARINGS REFERENCED TO THE
ADAMS COUNTY COORDINATE
SYSTEM

N00°-32'-43"W
N00°-07'-46"E

FOUND 1.06' NORTH OF
& 0.75' NORTH OF
TRUE CORNER

884.8 X
885.0

826.99'

NORTH LINE OF THE SOUTH 30 ACRES OF THE N1/2 SW1/4

UNPLATTED LANDS
OWNED BY
PLUM CREEK TIMBERLANDS

S88°-25'-24"W
(S87°-44'-55"W)

SI 1/4 CORNER
SECTION 32
T.17N., R.5E.

E1/4 CORNER
SECTION 32
T.17N., R.5E.
(HARRISON MON., FD.)

2626.18'

N88°-29'-39"E

CENTER OF
SECTION 32
T.17N., R.5E.
3/4" REBAR RD.

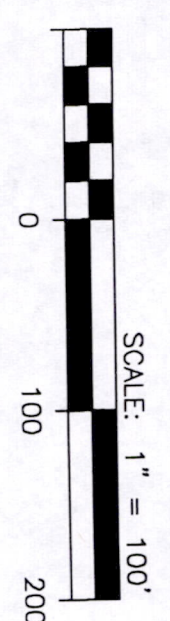

- EXISTING TOWER BASE -

Latitude: 43°-53'-59.03"
Longitude: 89°-55'-43.01"
(Per North American Datum of 1983/91)

Ground Elevation: 914.5'
Top of Antenna Elevation: 1387.5'
Top of Tower Light Elevation: 1370.8'
Centerline of Dish "A" Elevation: 1348.8'
Centerline of Dish "B" Elevation: 1302.5'
(Per National Geodetic Vertical Datum of 1929)

- PROPOSED TOWER BASE -

Latitude: 43°-53'-59.12"
Longitude: 89°-55'-42.75"
(Per North American Datum of 1983/91)

Ground Elevation: 914.6'
(Per National Geodetic Vertical Datum of 1929)

BENCHMARK INFORMATION:

SITE BENCHMARK: (BM A) 6" NAIL SET IN NORTH
FACE OF POWER POLE #F66
±1' ABOVE GROUND LEVEL
ELEVATION = 887.73'

SITE BENCHMARK: (BM B) CHISELED SQUARE SET IN
S.W. CORNER OF CONCRETE STOOP ON WEST SIDE OF SHELTER.
ELEVATION = 914.83'

SURVEYOR'S CERTIFICATE

I, Craig A. Keach, Wisconsin Registered Land Surveyor of Aero-Metric Incorporated, certify that I have surveyed the described property and that the map shown is a true and accurate representation thereof to the best of my knowledge and belief.

Dated this 31ST day of MAY, 2002.

Craig A. Keach
WISCONSIN REGISTERED LAND SURVEYOR
Craig A. Keach, S-2333

CenturyTel
4600 WEST COLLEGE AVENUE
APPLETON, WI 54915
(920) 841-1213
PIN: 31-002
COMPUTER No. 26-830-10
PROPERTY OWNER:
TOWER OWNER:
WISCONSIN RSA #7 INC.
P.O. BOX 4065
MONROE, LA. 71211-4065

REV. DATE	REVISION DESCRIPTION

DWG. FILE: CT-DELLWD DATE: 5-9-02
PRJT. NO.: 2020501 REVISIONS:
DRAWN BY: T.R.K. CHECKED BY: C.A.K.
NOTEBOOK: P-261 PAGE(S): 7-9
SHEET 1 OF 2 **D-879**

- LEGEND -**
- = 3/4" REBAR FOUND
 - o = 1"x24" IRON PIPE SET
 - = 8" NAIL SET
 - △ = P.K. MASONRY NAIL SET
 - ⊙ = COUNTY MONUMENT FOUND
 - () = RECORDED INFORMATION
 - ⊕ = POWER POLE
 - = TELEPHONE PEDESTAL
 - ⊗ = GUY ANCHOR
 - = PROPERTY LINE
 - ⊠ = ELECTRIC TRANSFORMER/METER
 - OP- = OVERHEAD POWER LINE
 - E- = BURIED ELECTRIC
 - T- = BURIED TELEPHONE



SITE NAME:
DELLWOOD

SITE ADDRESS:
DYKE RD.
QUINCY, WI

AS-BUILT SURVEY
FOR
CenturyTel
A PART OF THE NE1/4 OF THE SW1/4,
SECTION 32, T.17N., R.5E., TOWN OF
QUINCY, ADAMS COUNTY, WISCONSIN

AERO-METRIC
Aero-Metric, Incorporated
Land Planning & Design Division
920-849-7708 800-472-5313 FAX (849-7709)
539 NORTH MADISON STREET CHILTON, WISCONSIN 53014

Pos 3a170531001

- LEGEND -**
- = 3/4" REBAR FOUND
 - o = 1"x24" IRON PIPE SET
 - = 8" NAIL SET
 - △ = P.K. MASONRY NAIL SET
 - ⊕ = COUNTY MONUMENT FOUND
 - () = RECORDED INFORMATION
 - ∅ = POWER POLE
 - = TELEPHONE PEDESTAL
 - ⌚ = GUY ANCHOR
 - = PROPERTY LINE
 - ⊠ = ELECTRIC TRANSFORMER/METER
 - DPL- = OVERHEAD POWER LINE
 - E- = BURIED ELECTRIC
 - T- = BURIED TELEPHONE
 - Ⓞ = GROUNDING PORT

LEGAL DESCRIPTION

Lot 1, Certified Survey Map No. 2407, recorded in Volume 9 of Certified Survey Maps, on Pages 46-47, as Document No. 321355, located in the Northeast Quarter (NE1/4) of the Southwest Quarter (SW1/4) of Section Thirty-Two (32), Township Seventeen (17) North, Range Five (5) East, Town of Quincy, Adams County, Wisconsin containing 504,020 square feet (11.571 acres) of land.

SURVEYOR'S CERTIFICATE

I, Craig A. Keach, Wisconsin Registered Land Surveyor of Aero-Metric Incorporated, certify that I have surveyed the described property and that the map shown is a true and accurate representation thereof to the best of my knowledge and belief.

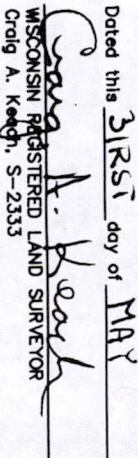
Dated this 31ST day of MAY, 2002.

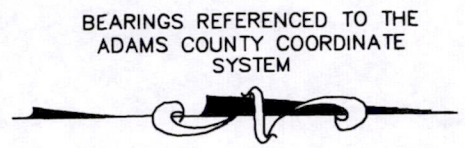
 CRAIG A. KEACH
 WISCONSIN REGISTERED LAND SURVEYOR
 Craig A. Keach, S-2333

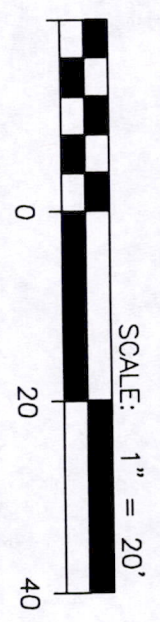
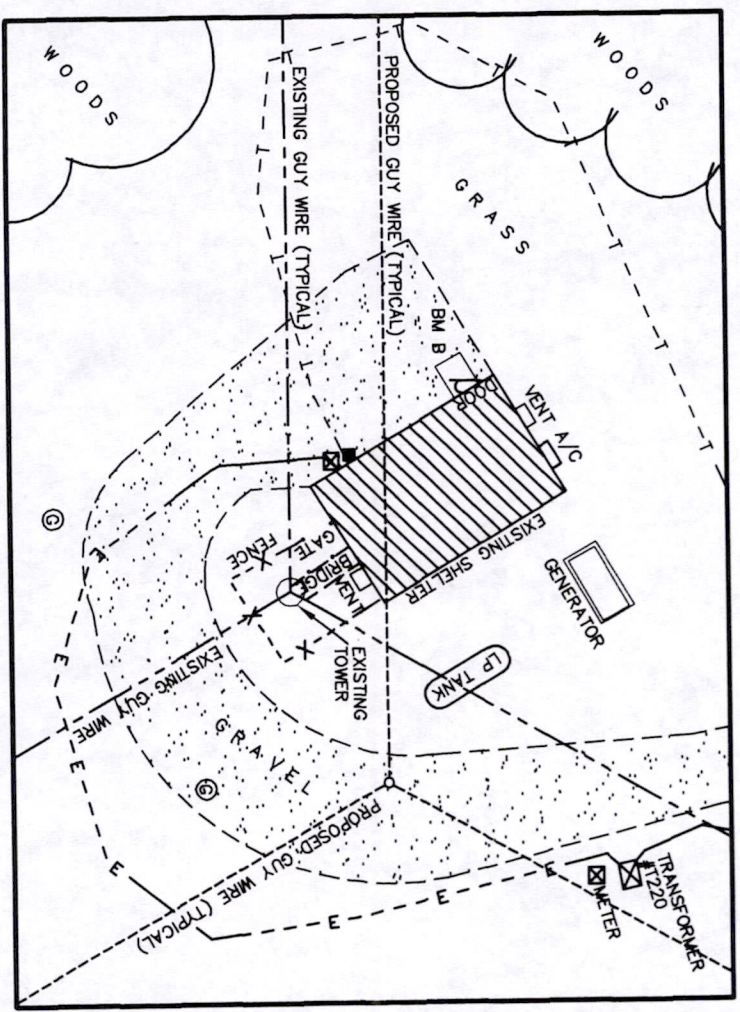

C.T.H. 'Z'		C.T.H. 'F'	
LAKEVIEW		DUCK CREEK	
DYKE		18th	
CASTLEWOOD DR.			
DYKE RD.			
X SITE			
REV. DATE	REVISION DESCRIPTION		



SITE NAME: DELLWOOD
SITE ADDRESS: DYKE RD. QUINCY, WI

AS-BUILT SURVEY
 FOR
 CenturyTel
 A PART OF THE NE1/4 OF THE SW1/4,
 SECTION 32, T.17N., R.5E., TOWN OF
 QUINCY, ADAMS COUNTY, WISCONSIN

AERO-METRIC
 Aero-Metric, Incorporated
 Land Planning & Design Division
 920-849-7708 800-472-5313 FAX (849-7709)
 539 NORTH MADISON STREET CHILTON, WISCONSIN 53014

DWG. FILE: CT-DELLWD	DATE: 5-9-02
PRJT. NO.: 2020501	REVISIONS:
DRAWN BY: T.R.K.	CHECKED BY: C.A.
NOTEBOOK: P-261	PAGE(S): 7-9
SHEET 2 OF 2	D-879

Pas 32170531001