

CERTIFICATE OF SURVEY.

STATE OF WISCONSIN, }
ADAMS COUNTY. } SR.

Frank E. Novak Surveyor, in and for the County and State of Wisconsin,

hereby certify that I have surveyed and subdivided Section 5 Township 17 North of Range 6 East of 4th Principal Meridian, as represented by the courses and distances on the following plat, and annexed field-notes of survey:

Established the center of the section at the point of intersection of straight quarter lines.

Established all quarter-quarter corners upon the section boundary at proportional distances between known section and quarter corners, according to the original field-notes of the Government survey.

Established all lost corners at proportionate distances between known corners, according to original field-notes of the Government survey.

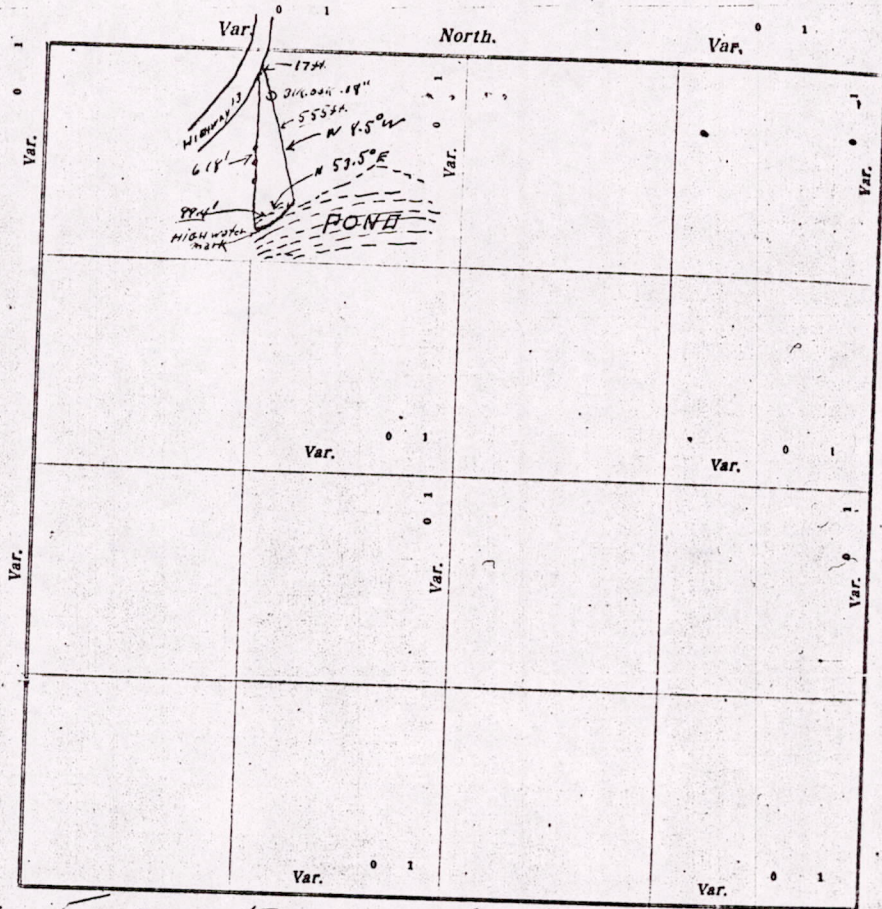

Plat of Section 5, Township 17 North, Range 6 East of 4th Principal Meridian. Scale, 80 chains to 1 inch. The figures in red ink are the lengths of the lines as stated in the field-notes of the Government survey.

Declination of the Magnetic Meridian from the True Meridian 6° East.

Surveyed and subdivided Aug 28, 1933 A. D. 19

, in accordance with the State Laws and Instructions of the Commissioner of the General Land Office, and recorded on pages _____ of Register in the County Surveyor's office.

WITNESS my hand this 28 day of August A. D. 1933

Frank E. Novak Surveyor.

The above work was done at the request of Mrs. Elsie Barnes in behalf of F. Skalicky. The above is a survey of a portion of south west side of the above section.

MISOS 1706 00002

DESCRIPTION of Section, Quarter Section and Quarter-quarter Section Corners of Section
 _____ Township _____ North, Range _____ East of _____ Principal Meridian.

N. B.—The variation of needle adopted in establishing corners is _____

State aforesaid, do
 East of 829

and quarter section
 Government survey:

Government Corners		Bearing Trees	In. dia.	Courses they bear	Links Distant	Bearing Trees	In. dia.	Courses they bear	Links Distant
No.									
1	N. W. Sec. cor. Identified								
2	N. E. Sec. cor. Identified								
3	S. E. Sec. cor. Identified								
4	S. W. Sec. cor. Identified								
5	N. $\frac{1}{4}$ Sec. cor. Identified								
6	E. $\frac{1}{4}$ Sec. cor. Identified								
7	S. $\frac{1}{4}$ Sec. cor. Identified								
8	W. $\frac{1}{4}$ Sec. cor. Identified								
No. SUBDIVISION CORNERS.									
1	Center $\frac{1}{4}$ Sec. cor.								
2	North $\frac{1}{4}$ - $\frac{1}{4}$ s N. W. qr.								
3	East $\frac{1}{4}$ - $\frac{1}{4}$ s N. W. qr.								
4	South $\frac{1}{4}$ - $\frac{1}{4}$ s N. W. qr.								
5	West $\frac{1}{4}$ - $\frac{1}{4}$ s N. W. qr.								
6	Center $\frac{1}{4}$ - $\frac{1}{4}$ s N. W. qr.								
7	North $\frac{1}{4}$ - $\frac{1}{4}$ s N. E. qr.								
8	East $\frac{1}{4}$ - $\frac{1}{4}$ s N. E. qr.								
9	South $\frac{1}{4}$ - $\frac{1}{4}$ s N. E. qr.								
10	Center $\frac{1}{4}$ - $\frac{1}{4}$ s N. E. qr.								
11	East $\frac{1}{4}$ - $\frac{1}{4}$ s S. E. qr.								
12	South $\frac{1}{4}$ - $\frac{1}{4}$ s S. E. qr.								
13	West $\frac{1}{4}$ - $\frac{1}{4}$ s S. E. qr.								
14	Center $\frac{1}{4}$ - $\frac{1}{4}$ s S. E. qr.								
15	South $\frac{1}{4}$ - $\frac{1}{4}$ s S. W. qr.								
16	West $\frac{1}{4}$ - $\frac{1}{4}$ s S. W. qr.								
17	Center $\frac{1}{4}$ - $\frac{1}{4}$ s S. W. qr.								

NAMES OF SWORN ASSISTANTS.

CHAINMEN	FLAGMEN	AXMEN
<i>Elie Garner</i>		
<i>Frank Novak</i>		

Scale, 80 chains to 6

and Instructions of
 office.

Surveyor.

MINUTES.

Starting on the west side of Skelley's NE $\frac{1}{4}$ & NW $\frac{1}{4}$ Sec 5 T17 R6 E a survey was made on the agreed assumption that the new fence and old black oak trees were on original line. Hence the west line was prolonged north to Highway 13 and back south to the pond. The High Water mark was end of line. a stone was laid. Then a line 99.4 ft N 53° 30' E was run and a stone laid for the south East corner. Thence N 4.5° W 29' to oak 15" diam. and continued N 8.5° W 526 ft and then due west to Highway leaving a 17 foot access to road. The area is 1.09 acres. The lengths of sides of the portion of land, hence are west 618 ft; East 555; north, 17 ft; south 99.4 ft on straight line.

Frank E. Novak
 County Surveyor.

M1505176600002