

ADAMS COUNTY

Survey Monument Record

TYPE OF MONUMENT: Existing Railroad Spike

STATE PLANE COORDINATES: N _____
E _____

ELEVATION — M.S.L. DATUM: _____

THETA ANGLE: _____

FIELD BOOK: _____ PAGE _____

CORNER NO. _____

SECTION 6

TOWN 17

RANGE 6

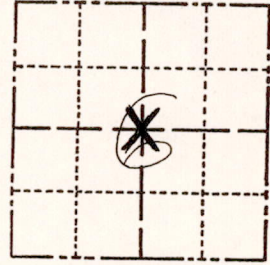

LOCATION
(Indicated by 'X')

SEAL:

BASIS FOR MONUMENT LOCATION

(Use reverse side if necessary)

Show info such as: History of corner, with reference to Vol. and pg, dates, surveyor; exact description of monument replaced; if location computed, by taped or EDM traverse; landowner remarks, etc.

Found and verified existing Railroad Spike as being the center of Section 6-17-6 as used by Sam Mullen for surveys in this section.



CERTIFIED CORRECT:

Dale C. Hagen
Registered Land Surveyor

DATE: 6-1-1976

TIE SKETCH

(Show at least four ties)

° NOTE

Ties in trees to nail in disc.

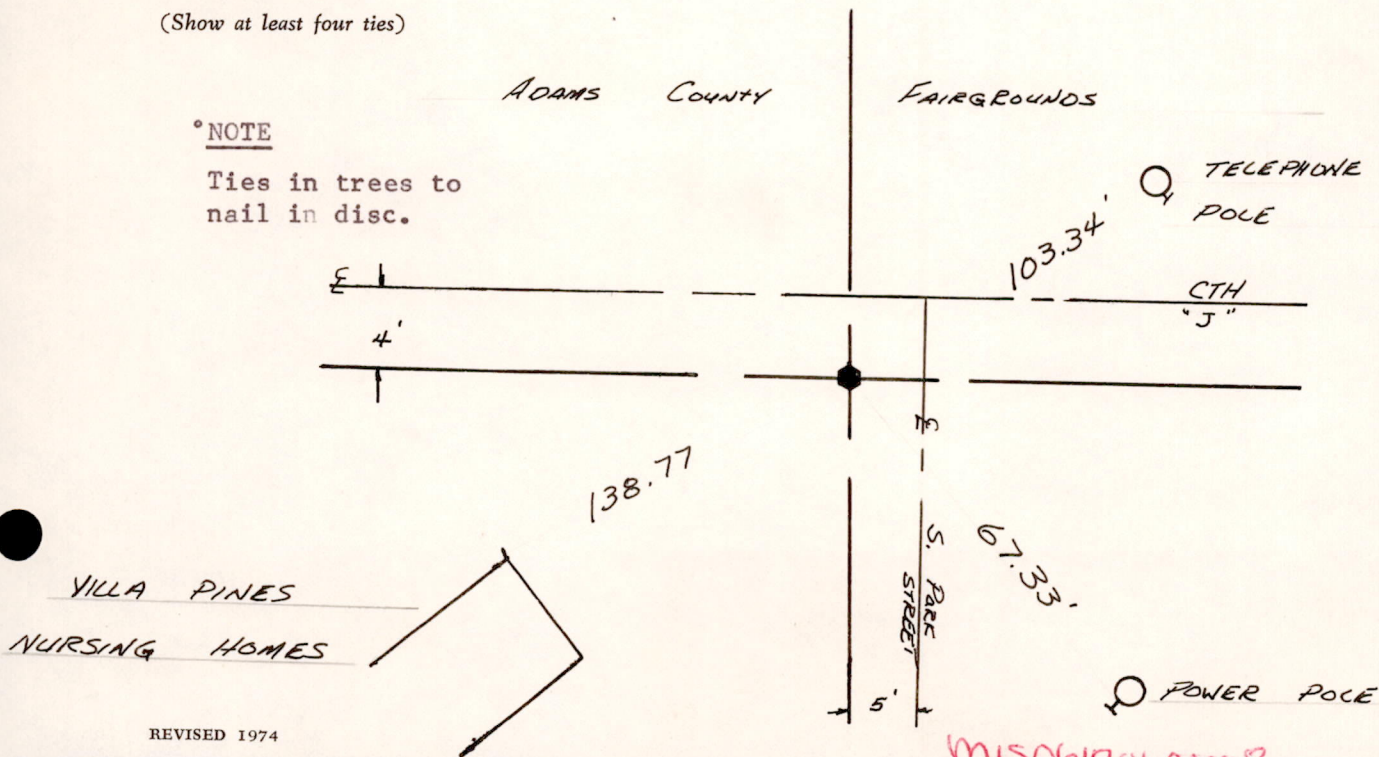

M1506170600008