

Government Land Corner Certificate

ADAMS County
 TYPE OF MONUMENT: 3/4" x 24" RE. ROD
 STATE PLANE COORDINATES: N _____
 E _____
 ELEVATION — M.S.L. DATUM: _____
 THETA ANGLE: _____
 FIELD BOOK: A-F 1 PAGE 13
 DRAWN BY: S. SORENSEN

CORNER NO. _____
 SECTION 7
 TOWN 17
 RANGE 6

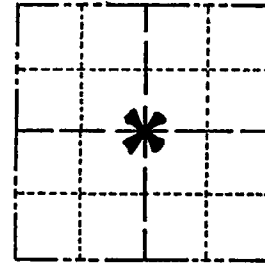

LOCATION
(Indicated by 'X')

BASIS FOR MONUMENT LOCATION

Show info such as: History of corner, with reference to Vol. and pg., dates, surveyor; exact description of monument replaced; if location computed, by taped or EDM traverse; landowner remarks, etc. (Use reverse side if necessary)

The location of this corner was determined by retracing Stephen's Subdivision to the east of the north south quarter line and locates the corner at the location determined by Surveyor Fred Quinnell in 1911.

SEAL:



DATA SHOWN HERE ON
CERTIFIED CORRECT:

Gregory P. Rhinehart
Registered Land Surveyor

DATE: 6/9/80

TIE SKETCH

Show at least four ties, also fence lines, roads, topo, size and type of witness trees and if off road - best way to arrive at corner.

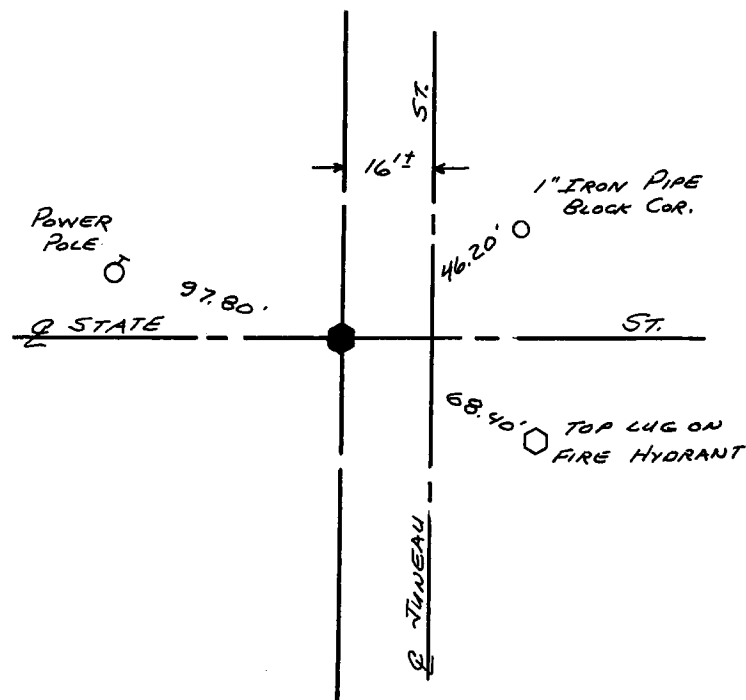

MAINTENANCE RECORD

Date	Init.	Remarks