

ADAMS COUNTY  
Survey Monument Record

CORNER NO. 493  
 SECTION 8  
 TOWN 17 N  
 RANGE 6 E

TYPE OF MONUMENT: PK Nail in Asphalt over Concrete  
 STATE PLANE COORDINATES: N \_\_\_\_\_  
 E \_\_\_\_\_  
 ELEVATION — M.S.L. DATUM: \_\_\_\_\_  
 THETA ANGLE: \_\_\_\_\_  
 FIELD BOOK: \_\_\_\_\_ PAGE \_\_\_\_\_

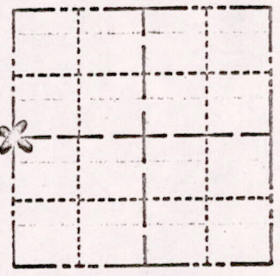

LOCATION  
 (Indicated by 'X')

BASIS FOR MONUMENT LOCATION

(Use reverse side if necessary)  
 Show info such as: History of corner, with reference to Vol. and pg, dates, surveyor; exact description of monument replaced; if location computed, by taped or EDM traverse; landowner remarks, etc.

SEAL:

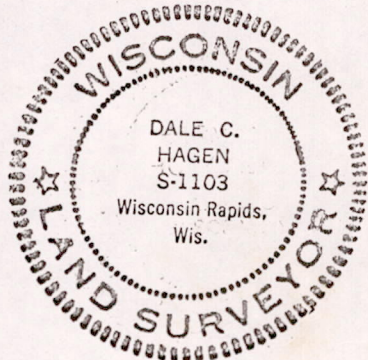

Re-established Quarter corner by retracement of Warner and McConick Subdivision, and checking into Homewood Subdivision.

Did not attempt excavation because corner falls in State Truck Highway 13, which has a concrete base.

CERTIFIED CORRECT:

Dale C. Hagen  
 Registered Land Surveyor  
 DATE: August 22, 1974

*Took 1 new tie  
 Everything o.k. 11/12/75 DM-SS*

TIE SKETCH

(Show at least four ties)

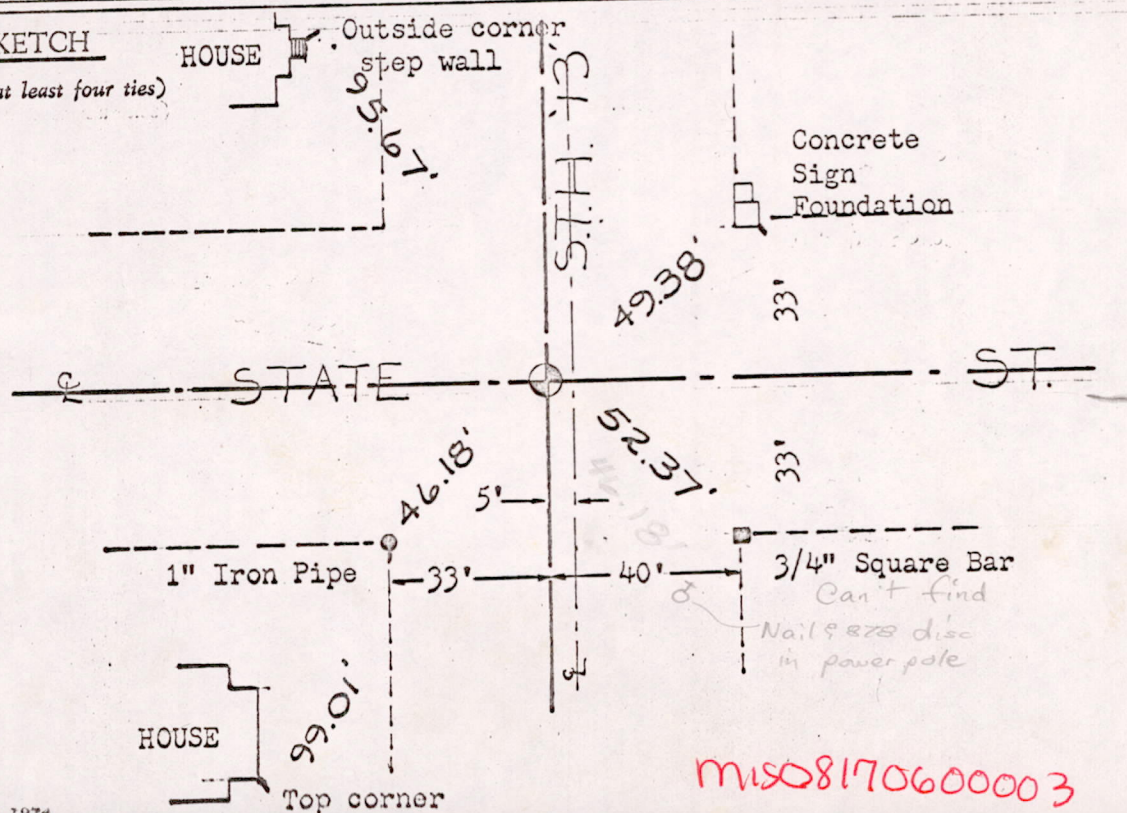

MISO8170600003