

ADAMS COUNTY

Survey Monument Record

TYPE OF MONUMENT: Standard Harrison

STATE PLANE COORDINATES: N _____

E _____

ELEVATION — M.S.L. DATUM: _____

THETA ANGLE: _____

FIELD BOOK: _____ PAGE _____

CORNER NO. 549
SECTION 23
TOWN 17
RANGE 6

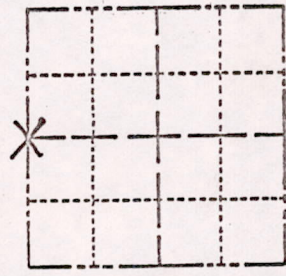

LOCATION
(Indicated by 'X')

SEAL:

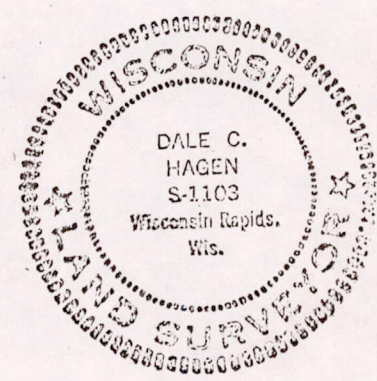

BASIS FOR MONUMENT LOCATION

(Use reverse side if necessary)

Show info such as: History of corner, with reference to Vol. and pg, dates, surveyor; exact description of monument replaced; if location computed, by taped or EDM traverse; landowner remarks, etc.

Ran EDM/transit traverse of Section 23 and determined extent of search area.

Found Railroad spike about 6 inches below surface of dirt road and 2" Iron Pipe about 47 feet south of spike.

Replaced Railroad spike with Harrison Monument.

Everything o.k. 9-27-75 53

CERTIFIED CORRECT:

Dale C. Hagen
Registered Land Surveyor

DATE: October 2, 1974

TIE SKETCH

(Show at least four ties)

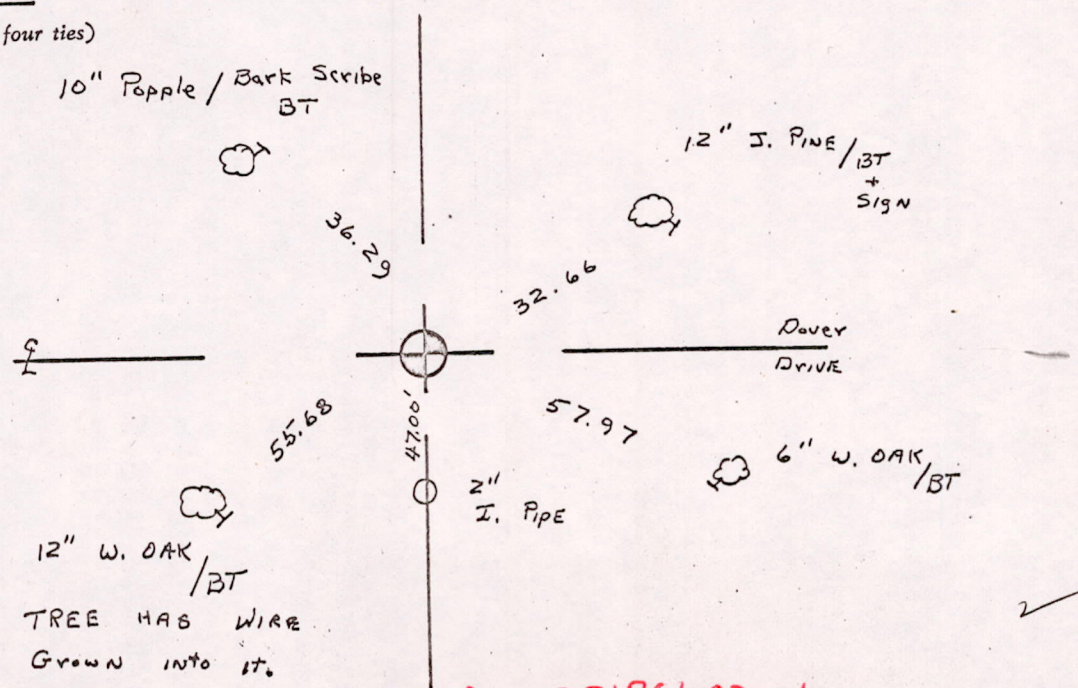

MIS23170600006