

ADAMS COUNTY

Survey Monument Record

TYPE OF MONUMENT: Harrison Monument

STATE PLANE COORDINATES: N \_\_\_\_\_

E \_\_\_\_\_

ELEVATION — M.S.L. DATUM: \_\_\_\_\_

THETA ANGLE: \_\_\_\_\_

FIELD BOOK: \_\_\_\_\_ PAGE \_\_\_\_\_

CORNER NO. 668  
SECTION 35  
TOWN 17  
RANGE 6

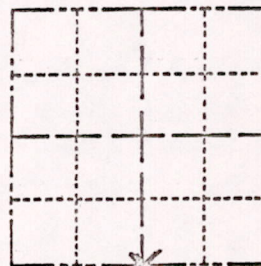

LOCATION  
(Indicated by 'X')

SEAL:

BASIS FOR MONUMENT LOCATION

(Use reverse side if necessary)

Show info such as: History of corner, with reference to Vol. and pg, dates, surveyor; exact description of monument replaced; if location computed, by taped or EDM traverse; landowner remarks, etc.

Set corner equidistant and on line between adjacent section corners.

Ran EDM/transit traverse of entire area to determine search areas for the corners. An extensive search revealed no conclusive evidence as to the location of the original corner or any subsequent remonumentation. No excavation with backhoe was done.



CERTIFIED CORRECT:

Dale C. Hagen  
Registered Land Surveyor  
DATE: 6/3/75

*Everything O.K. 10-2-75 SS*

TIE SKETCH

(Show at least four ties)

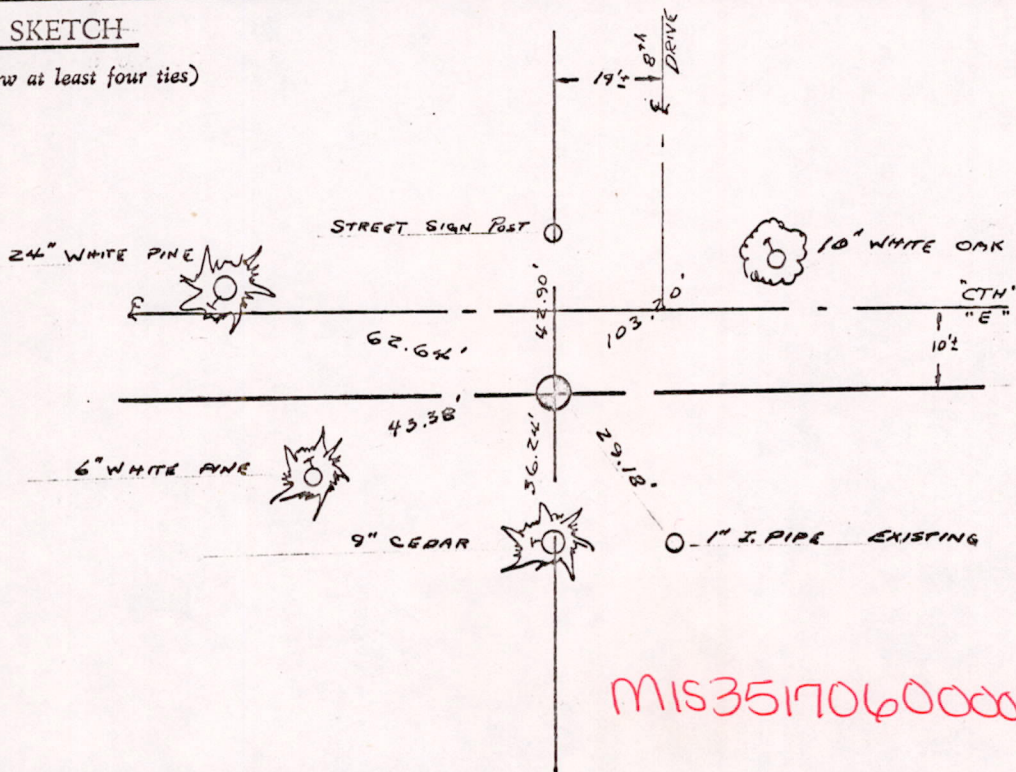

MIS3517060004