

ADAMS COUNTY

Survey Monument Record

TYPE OF MONUMENT: Harrison Monument (30 inches)

STATE PLANE COORDINATES: N \_\_\_\_\_  
E \_\_\_\_\_

ELEVATION — M.S.L. DATUM: \_\_\_\_\_

THETA ANGLE: \_\_\_\_\_

FIELD BOOK: \_\_\_\_\_ PAGE \_\_\_\_\_

CORNER NO. 631  
SECTION 35  
TOWN 17  
RANGE 6

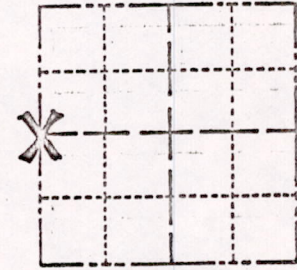

LOCATION  
(Indicated by 'X')

BASIS FOR MONUMENT LOCATION

(Use reverse side if necessary)

Show info such as: History of corner, with reference to Vol. and pg, dates, surveyor; exact description of monument replaced; if location computed, by taped or EDM traverse; landowner remarks, etc.

Set corner equidistant and on line between adjacent section corners.

Ran EDM/transit traverse throughout entire area to determine search areas for the corners in this section and section 34. an extensive search revealed no conclusive evidence as to the location of the original corner or any subsequent remonumentation thereof.

SEAL:

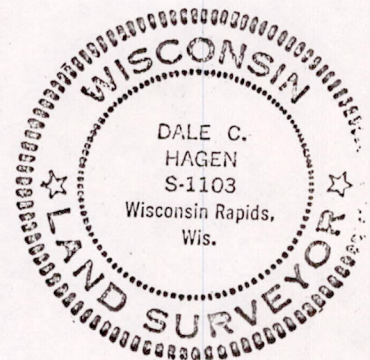

CERTIFIED CORRECT:

*Dale C. Hagen*

Registered Land Surveyor

DATE: 3-28-75

*Everything o.k.*

TIE SKETCH

(Show at least four ties)

Rock Face of Mound

NOTE: Ties to nail and disc in trees.

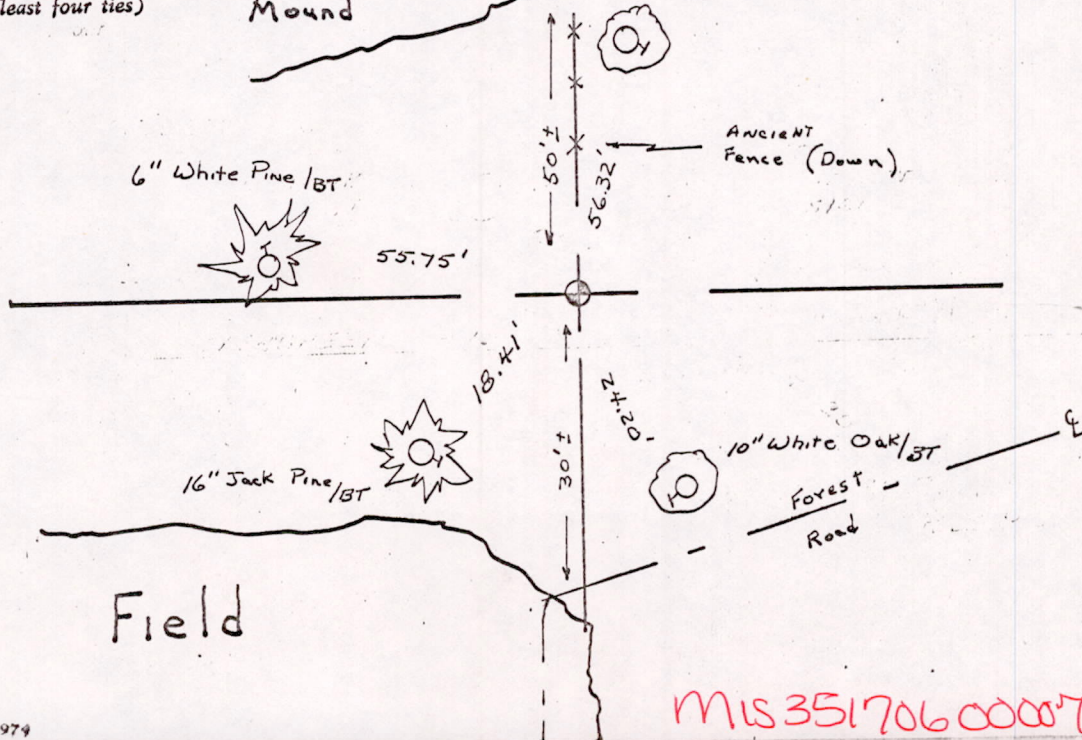

MIS 351706 00007