

NOTE: LOCATION OF PRIVATE ROAD IS PER MONUMENTATION FROM SURVEY MAP BY R.K. SAYLER, S-417, DATED JULY 27, 1979. THIS LOCATION CREATES A PARCEL OF LAND NORTH OF ROAD THAT IS SUBSTANDARD TO ADAMS COUNTY SUBDIVISION ORDINANCE.

**CURVE DATA**  
 RAD. 11,399.20'  
 CEN. ANG. 0°49'32"  
 ARC 164.25'  
 LONG CHORD N2°03'14" E 164.24'  
 (R 1°41' E, 164.20')

**BOUNDARY DESCRIPTION**

The Southwest Quarter of the Southwest Quarter (SW 1/4 SW 1/4) of Section Seventeen (17), Township Seventeen (17) North, Range Six (6) East, Town of Adams, Adams County, Wisconsin, EXCEPT that part of the SW 1/4 SW 1/4, Section 17, T.17N, R.6E described as follows to-wit:

Beginning at a point located 42.70 feet North 90° 00' East and 164.20 feet North 1° 41' East and 901.05 feet North 2° 31' East of the Southwest corner of the Southwest Quarter (SW 1/4) of said Section Seventeen (17); from that point running North 2° 31' East a distance of 180.00 feet; Thence South 89° 39' East a distance of 200.14 feet; Thence South 0° 21' West a distance of 180.00 feet; Thence North 89° 39' West a distance of 206.96 feet to the said point of beginning. ALSO EXCEPTING a 66 foot roadway on the North side of the SW 1/4 SW 1/4, Section 17, T.17N, R.6E. BUT granting an easement to the Optionee in common with others for ingress and egress along said 66 foot roadway which shall be maintained by the Optionor, AND being subject to the right-of-way for State Highway "13" as per Volume 98 Page 390, as Document No. 109081.

SUBJECT TO WISCONSIN TELEPHONE COMPANY EASEMENT VOLUME 81 PAGE 483

I, John L. Brey, Registered Land Surveyor, hereby certify that I have surveyed the lands shown on this plat by the direction of Nick Kaufman and that said survey and plat are correct to the best of my knowledge and belief.

*John L. Brey*  
 John L. Brey, Registered Land Surveyor, S-1319  
 June 11, 1981  
 REVISED 6/25/81

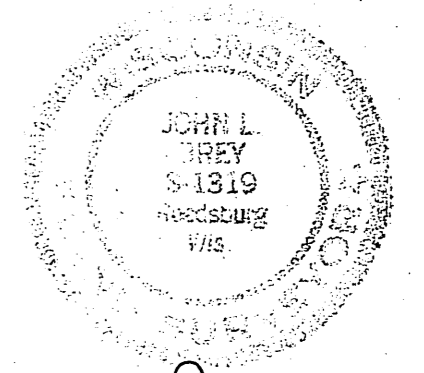

**SOIL DATA**  
 SOIL TYPES  
 PLAINFIELD SAND  
 BREMS LOAMY SAND  
 B - HAND AUGER BORINGS DUG BY KENNETH G. CARLSON CST  
 HB - HAND AUGER BORINGS DUG BY GARY L. WOOLEVER CST  
 APPROXIMATE LIMIT OF AREAS SUITABLE FOR CONVENTIONAL SOIL ABSORPTION SYSTEMS (DESIGN OF ACTUAL TREATMENT AREAS SUBJECT TO FURTHER TESTING)

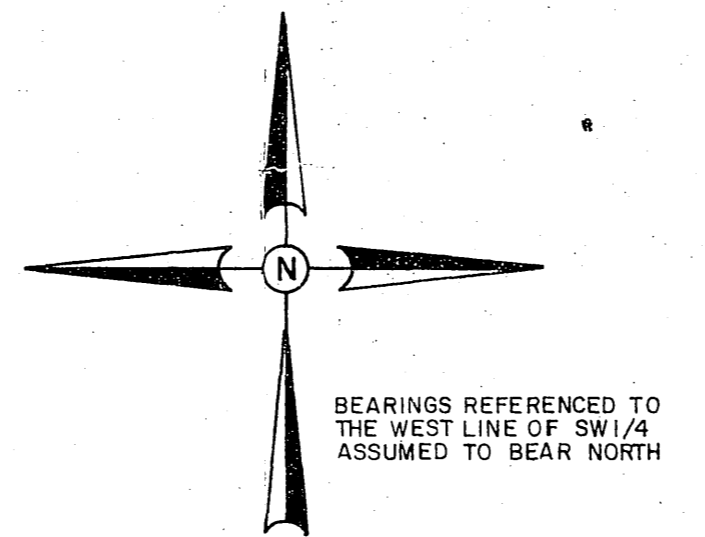

**LEGEND**  
 ● EXISTING HARRISON MONUMENT  
 ○ EXISTING 1/2" IRON PIPE  
 ○ 3/4" x 24" IRON ROD SET  
 ○ 1.50 lbs./lin. ft.  
 ( ) RECORDED AS

AREA = 36.8 ACRES

AERIAL TOPOGRAPHIC SURVEY  
 SW 1/4, SW 1/4, SEC. 17, T.17N, R.6E.  
 ADAMS COUNTY, WISCONSIN

PREPARED FOR  
 VIERBICHER ASSOCIATES  
 REEDSBURG, WISCONSIN

DATE OF PHOTOGRAPHY 11-8-40  
 SCALE IN FEET  
 SCALE 1"=100'  
 CONTOUR INTERVAL 2'

Note: This survey does not conform to the Wisconsin Administrative Code A-E5, Minimum Standards For Property Surveys. Monumentation of the corners has been waived by written request per A-E 5.01(b).

SW 1/4-SW 1/4, SEC. 17, T.17N, R.6E  
 ADAMS COUNTY, WIS.

VIERBICHER ASSOCIATES INC.  
 PLANNING, ENGINEERING, SURVEYING  
 940 EAST MAIN ST.  
 REEDSBURG, WI. 53959  
 PROJ.: 80-P13-5  
 F.B.: S-B  
 DWG: 5-113-2  
 DRAWN BY: J.L.B. CK'D: G.L.W. DATE: DEC. 1980