

ADAMS COUNTY

Survey Monument Record

TYPE OF MONUMENT: Harrison standard

STATE PLANE COORDINATES: N _____
E _____

ELEVATION — M.S.L. DATUM: _____

THETA ANGLE: _____

FIELD BOOK: _____ PAGE _____

CORNER NO. _____
SECTION 1
TOWN 17
RANGE 7

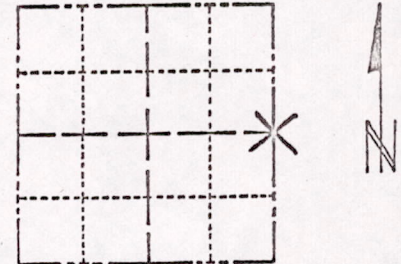

LOCATION
(Indicated by 'X')

SEAL:

BASIS FOR MONUMENT LOCATION

(Use reverse side if necessary)

Show info such as: History of corner, with reference to Vol. and pg. dates, surveyor; exact description of monument replaced; if location computed, by taped or EDM traverse; landowner remarks, etc.

Replaced 2" iron pipe set by me for the Breise survey. Entire section traversed and location verified.

This point is believed to be on a straight line equidistant between section corners.

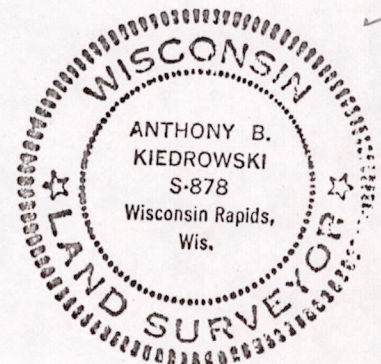

Handwritten notes in red ink: '3-28-77', '62-55', and 'OK'.

CERTIFIED CORRECT:

Anthony B. Kiedrowski
Registered Land Surveyor

DATE: 6/3/74

TIE SKETCH

(Show at least four ties)

Ties to nail and cap.

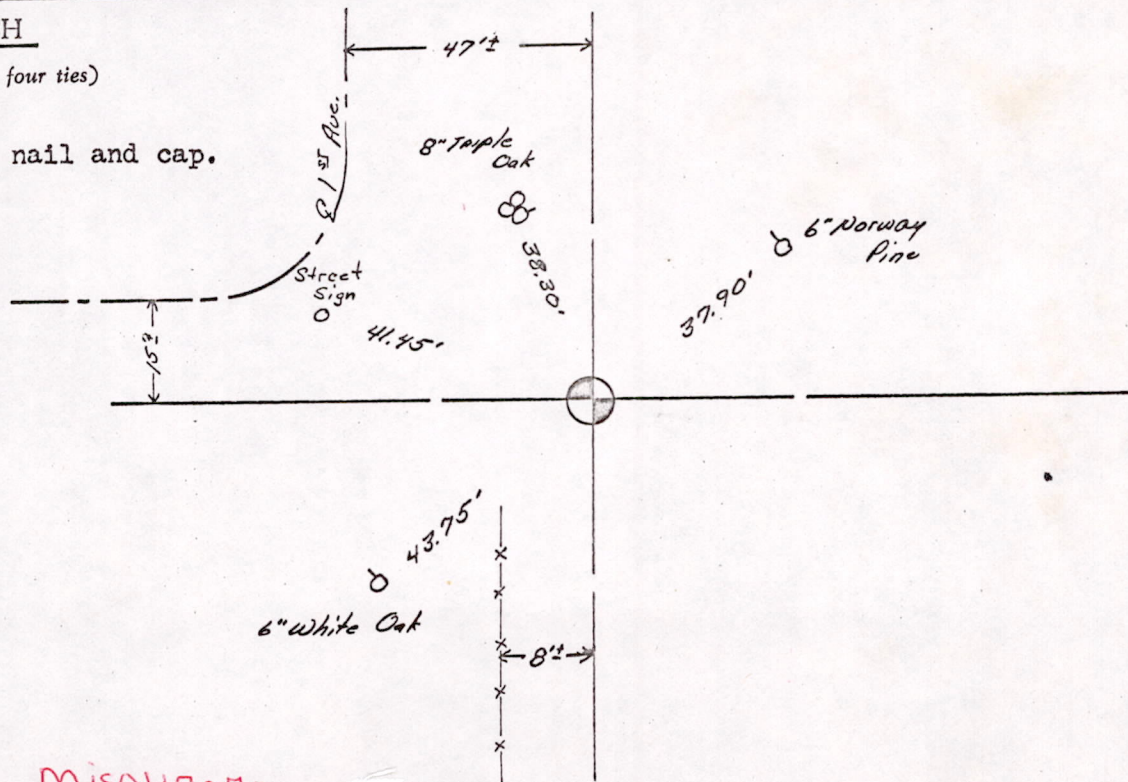

MIS01170700001